

| CUADRO DE CONSTRUCCION CAMPAMENTO | | | | | |
|-----------------------------------|--------|--------|------------|-------------|--------------|
| VERTICE | LADO | DIST. | ANGULO | ESTE | NORTE |
| 1 | 1 - 2 | 20.00 | 89°21'31" | 311148.3254 | 8932756.4367 |
| 2 | 2 - 3 | 49.91 | 90°45'37" | 311168.0312 | 8932759.8649 |
| 3 | 3 - 4 | 22.39 | 204°13'42" | 311177.2369 | 8932710.8121 |
| 4 | 4 - 5 | 92.91 | 158°11'13" | 311190.0328 | 8932692.4405 |
| 5 | 5 - 6 | 14.46 | 153°10'27" | 311211.0033 | 8932601.9275 |
| 6 | 6 - 7 | 20.45 | 215°11'56" | 311207.5581 | 8932587.8816 |
| 7 | 7 - 8 | 31.71 | 76°47'55" | 311215.0257 | 8932568.8434 |
| 9 | 9 - 10 | 57.32 | 91°58'19" | 311183.6409 | 8932564.3119 |
| 9 | 9 - 1 | 138.02 | 180°19'20" | 311173.5015 | 8932620.7330 |

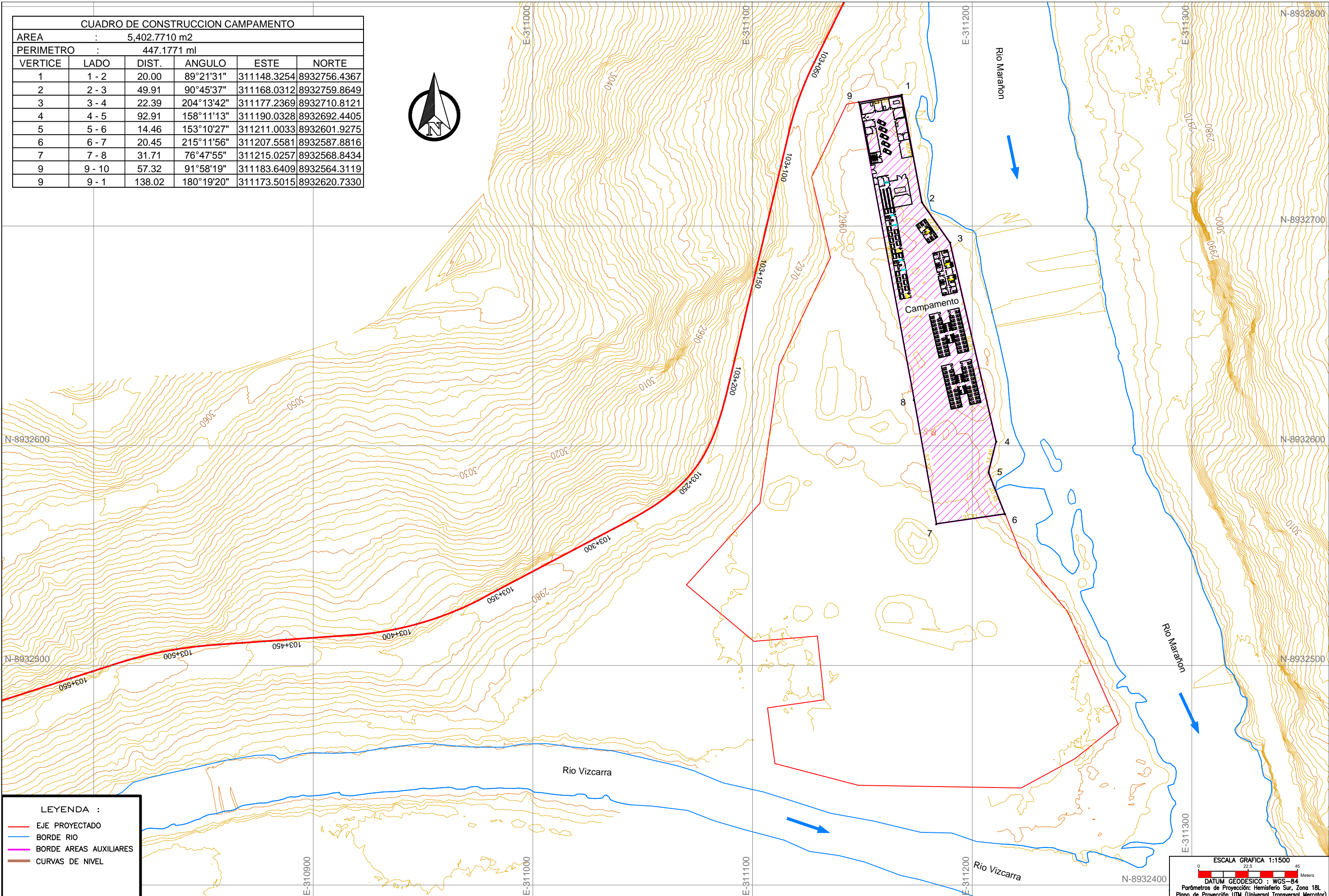

LEYENDA :

- EJE PROYECTADO
- BORDE RIO
- BORDE AREAS AUXILIARES
- CURVAS DE NIVEL

ESCALA GRAFICA 1:1500

DATUM GEODESICO : WGS-84
 Parámetros de Proyección: Hemisferio Sur, Zona 18L
 Plano de Proyección UTM (Universal Transversal Mercator)



CONSULTOR:

DISEÑO:

DIBUJO:

VERIFICO:

PRESENTO:

APROBO :

| REVISIONES | |
|------------|-------------------|
| N° | FECHA DESCRIPCION |
| | |
| | |
| | |

ESTUDIO DEFINITIVO PARA EL MEJORAMIENTO DE LA CARRETERA
 HUÁNUCO-COCONOCHA, SECTOR HUÁNUCO-LA UNIÓN-HUALLANCA RUTA PE-3N
 CONTRATO N°DU 078-2009(CP) - 1-2009-DU-GR-LL-GRI-CE

INSTALACIONES AUXILIARES
 KM 103+200
 Campamento

ESCALA: 1/1500

FECHA: AGOSTO 2015

PLANO N°:

HOJA:

| CUADRO DE CONSTRUCCION CAMPAMENTO | | | | | |
|-----------------------------------|-------|--------|------------|-------------|--------------|
| VERTICE | LADO | DIST. | ANGULO | ESTE | NORTE |
| 1 | 1 - 2 | 107.93 | 74°47'46" | 302083.8988 | 8918593.8598 |
| 2 | 2 - 3 | 32.85 | 103°30'59" | 302066.4079 | 8918566.0531 |
| 3 | 3 - 4 | 64.72 | 167°23'17" | 302005.0882 | 8918586.7542 |
| 4 | 4 - 5 | 45.14 | 78°14'47" | 301966.5065 | 8918610.1813 |
| 5 | 5 - 1 | 20.75 | 116°3'12" | 301980.6665 | 8918625.3555 |

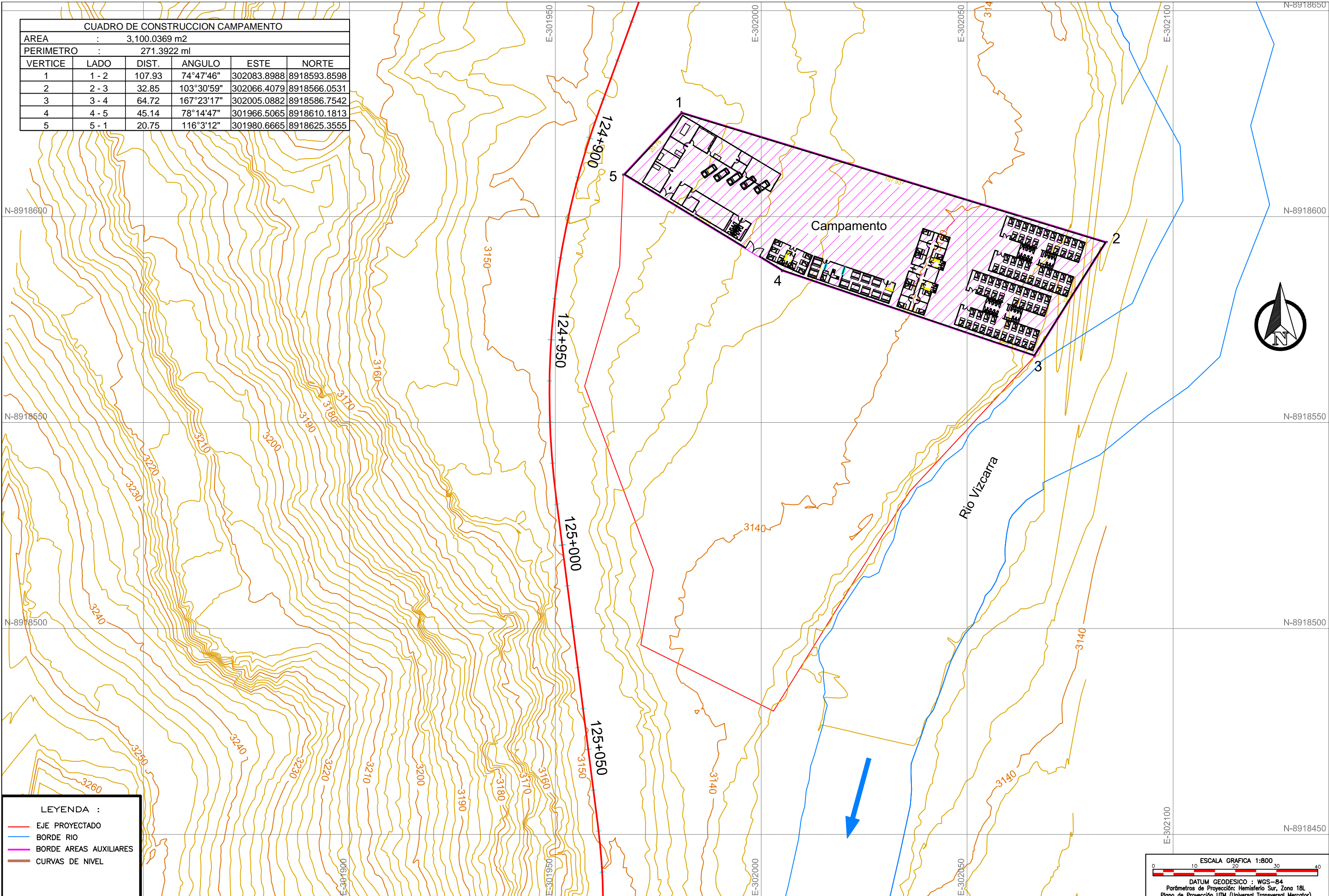

LEYENDA :

- EJE PROYECTADO
- BORDE RIO
- BORDE AREAS AUXILIARES
- CURVAS DE NIVEL

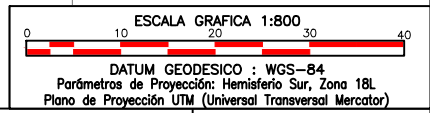

CONSULTOR:
DISEÑO:
DIBUJO:
VERIFICO:
PRESENTO:

APROBO :

| REVISIONES | | |
|------------|-------|-------------|
| N° | FECHA | DESCRIPCION |
| | | |
| | | |
| | | |

ESTUDIO DEFINITIVO PARA EL MEJORAMIENTO DE LA CARRETERA
HUÁNUCO–CONOCHOCA, SECTOR HUÁNUCO–LA UNIÓN–HUALLANCA RUTA PE–3N
CONTRATO N°DU 078–2009(CP) – 1–2009–DU–GR–LL–GRI–CE

| | |
|--------------------------|--------------------|
| INSTALACIONES AUXILIARES | ESCALA: 1/800 |
| KM 124+960 | FECHA: AGOSTO 2015 |
| Campamento | PLANO N°: |
| | HOJA: |

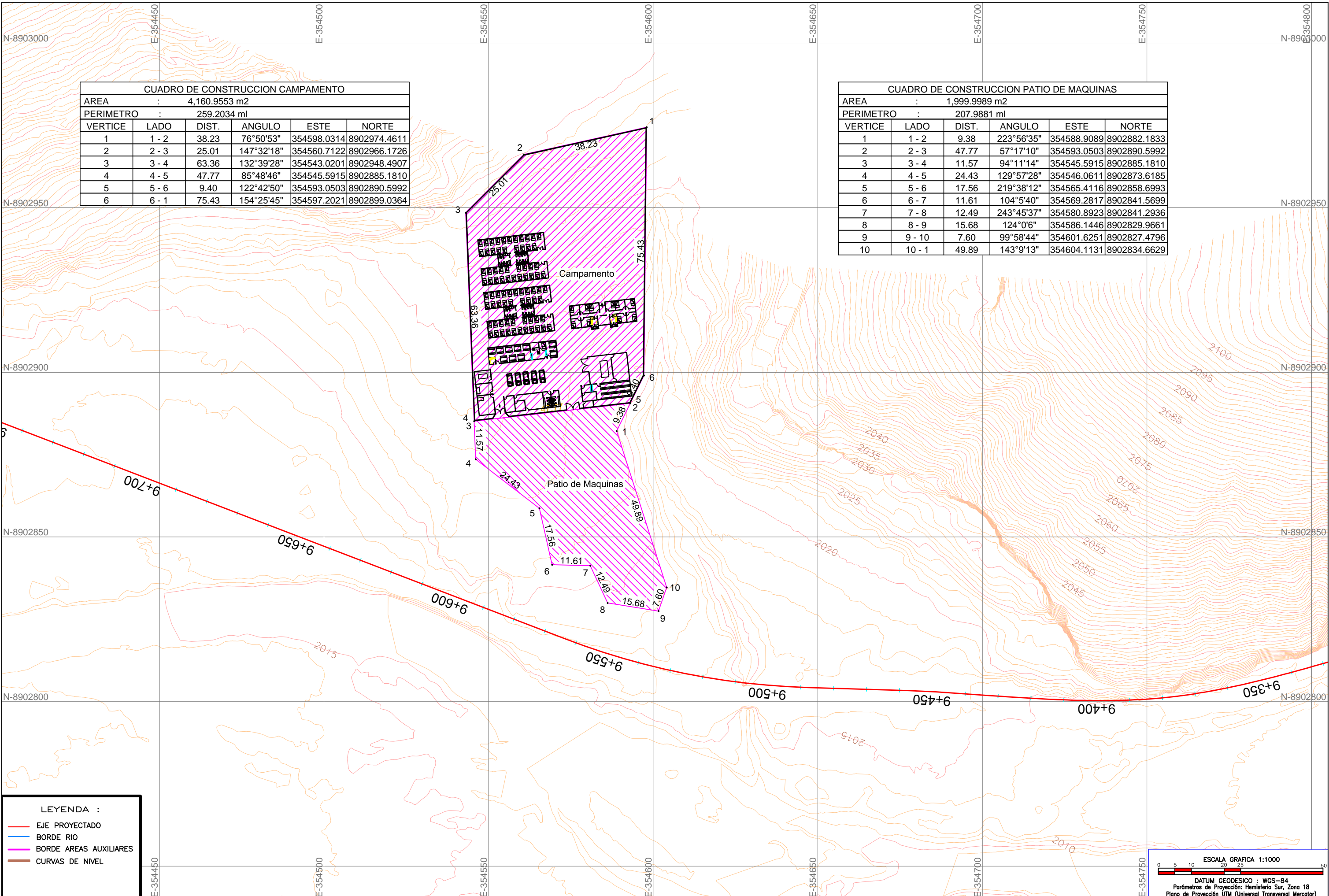

| CUADRO DE CONSTRUCCION CAMPAMENTO | | | | | |
|-----------------------------------|-------|-----------------|------------|-------------|--------------|
| AREA | | : 4,160.9553 m2 | | | |
| PERIMETRO | | : 259.2034 ml | | | |
| VERTICE | LADO | DIST. | ANGULO | ESTE | NORTE |
| 1 | 1 - 2 | 38.23 | 76°50'53" | 354598.0314 | 8902974.4611 |
| 2 | 2 - 3 | 25.01 | 147°32'18" | 354560.7122 | 8902966.1726 |
| 3 | 3 - 4 | 63.36 | 132°39'28" | 354543.0201 | 8902948.4907 |
| 4 | 4 - 5 | 47.77 | 85°48'46" | 354545.5915 | 8902885.1810 |
| 5 | 5 - 6 | 9.40 | 122°42'50" | 354593.0503 | 8902890.5992 |
| 6 | 6 - 1 | 75.43 | 154°25'45" | 354597.2021 | 8902899.0364 |

| CUADRO DE CONSTRUCCION PATIO DE MAQUINAS | | | | | |
|--|--------|-----------------|------------|-------------|--------------|
| AREA | | : 1,999.9989 m2 | | | |
| PERIMETRO | | : 207.9881 ml | | | |
| VERTICE | LADO | DIST. | ANGULO | ESTE | NORTE |
| 1 | 1 - 2 | 9.38 | 223°56'35" | 354588.9089 | 8902882.1833 |
| 2 | 2 - 3 | 47.77 | 57°17'10" | 354593.0503 | 8902890.5992 |
| 3 | 3 - 4 | 11.57 | 94°11'14" | 354545.5915 | 8902885.1810 |
| 4 | 4 - 5 | 24.43 | 129°57'28" | 354546.0611 | 8902873.6185 |
| 5 | 5 - 6 | 17.56 | 219°38'12" | 354565.4116 | 8902858.6993 |
| 6 | 6 - 7 | 11.61 | 104°5'40" | 354569.2817 | 8902841.5699 |
| 7 | 7 - 8 | 12.49 | 243°45'37" | 354580.8923 | 8902841.2936 |
| 8 | 8 - 9 | 15.68 | 124°0'6" | 354586.1446 | 8902829.9661 |
| 9 | 9 - 10 | 7.60 | 99°58'44" | 354601.6251 | 8902827.4796 |
| 10 | 10 - 1 | 49.89 | 143°9'13" | 354604.1131 | 8902834.6629 |

| LEYENDA : | |
|-----------|------------------------|
| | EJE PROYECTADO |
| | BORDE RIO |
| | BORDE AREAS AUXILIARES |
| | CURVAS DE NIVEL |

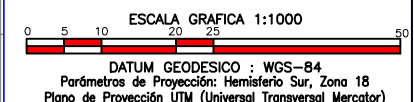

| | |
|-----------|----------|
| DISEÑO: | APROBO : |
| DIBUJO: | |
| VERIFICO: | |
| PRESENTO: | |

| REVISIONES | | |
|------------|-------|-------------|
| N° | FECHA | DESCRIPCION |
| | | |
| | | |
| | | |

ESTUDIO DEFINITIVO PARA EL MEJORAMIENTO DE LA CARRETERA HUÁNUCO-CONOCOCHA, SECTOR HUÁNUCO-LA UNIÓN-HUALLANCA RUTA PE-3N
 CONTRATO N°DU 078-2009(CP) - 1-2009-DU-GR-LL-GRI-CE

| | |
|---------------------------------------|--------------------|
| INSTALACIONES AUXILIARES Km 09+540 | ESCALA: 1:1000 |
| Campamento y Patio de Maquinas | FECHA: AGOSTO 2015 |
| | PLANO N°: |
| | HOJA: |



N.M.

| CUADRO DE COORDENADAS CAMPAMENTO | | | | | |
|----------------------------------|--------|-------|------------|-------------|--------------|
| VERTICE | LADO | DIST. | ANGULO | ESTE | NORTE |
| 1 | 1 - 2 | 21.77 | 133°59'9" | 337868.2594 | 8906404.5344 |
| 2 | 2 - 3 | 21.68 | 81°8'38" | 337871.0399 | 8906426.1220 |
| 3 | 3 - 4 | 30.24 | 224°57'46" | 337849.3698 | 8906425.5482 |
| 4 | 4 - 5 | 65.17 | 84°30'8" | 337827.4126 | 8906446.3458 |
| 5 | 5 - 6 | 62.76 | 128°5'18" | 337787.3371 | 8906394.9563 |
| 6 | 6 - 7 | 16.69 | 97°22'49" | 337802.4815 | 8906334.0494 |
| 7 | 7 - 8 | 17.17 | 109°35'4" | 337819.0618 | 8906335.9628 |
| 8 | 8 - 9 | 27.77 | 226°11'3" | 337822.9256 | 8906352.6971 |
| 9 | 9 - 10 | 21.63 | 120°48'53" | 337846.7712 | 8906366.9202 |
| 10 | 10 - 1 | 26.78 | 233°21'13" | 337846.7712 | 8906388.5489 |

Area: 4997.12 m²
 Area: 0.49971 ha
 Perimetro: 311.66 ml

| CUADRO DE COORDENADAS PATIO DE MAQUINAS | | | | | |
|---|-------|-------|------------|-------------|--------------|
| VERTICE | LADO | DIST. | ANGULO | ESTE | NORTE |
| 1 | 1 - 2 | 17.46 | 142°24'52" | 337827.4126 | 8906446.3458 |
| 2 | 2 - 3 | 26.60 | 133°46'37" | 337827.5231 | 8906463.8072 |
| 3 | 3 - 4 | 63.26 | 86°59'20" | 337808.4361 | 8906482.3295 |
| 4 | 4 - 5 | 21.20 | 129°19'23" | 337766.8276 | 8906434.6809 |
| 5 | 5 - 6 | 25.36 | 147°28'4" | 337770.3441 | 8906413.7756 |
| 6 | 6 - 1 | 65.17 | 80°1'45" | 337787.3371 | 8906394.9563 |

Area: 2835.90 m²
 Area: 0.28359 ha
 Perimetro: 219.04 ml

N-8906450

N-8906400

N-8906350

N-8906300

| LEYENDA : | |
|-----------|------------------------|
| | EJE PROYECTADO |
| | BORDE RIO |
| | BORDE AREAS AUXILIARES |
| | CURVAS DE NIVEL |

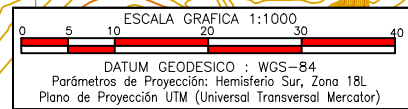

DATUM GEODESICO : WGS-84
 Parámetros de Proyección: Hemisferio Sur, Zona 18L
 Plano de Proyección UTM (Universal Transversal Mercator)



DISEÑO:
 DIBUJO:
 VERIFICO:
 PRESENTO:

APROBO :

| REVISIONES | | |
|------------|-------|-------------|
| N° | FECHA | DESCRIPCION |
| | | |
| | | |
| | | |

ESTUDIO DEFINITIVO PARA EL MEJORAMIENTO DE LA CARRETERA
 HUÁNUCO-CONOCOCHA, SECTOR HUÁNUCO-LA UNIÓN-HUALLANCA RUTA PE-3N
 CONTRATO N°DU 078-2009(CP) - 1-2009-DU-GR-LL-GRI-CE

CAMPAMENTO
 Y PATIO DE MAQUINAS
 KM 37+720

ESCALA: 1/1000
 FECHA: JUNIO 2015
CAMP-PMQ

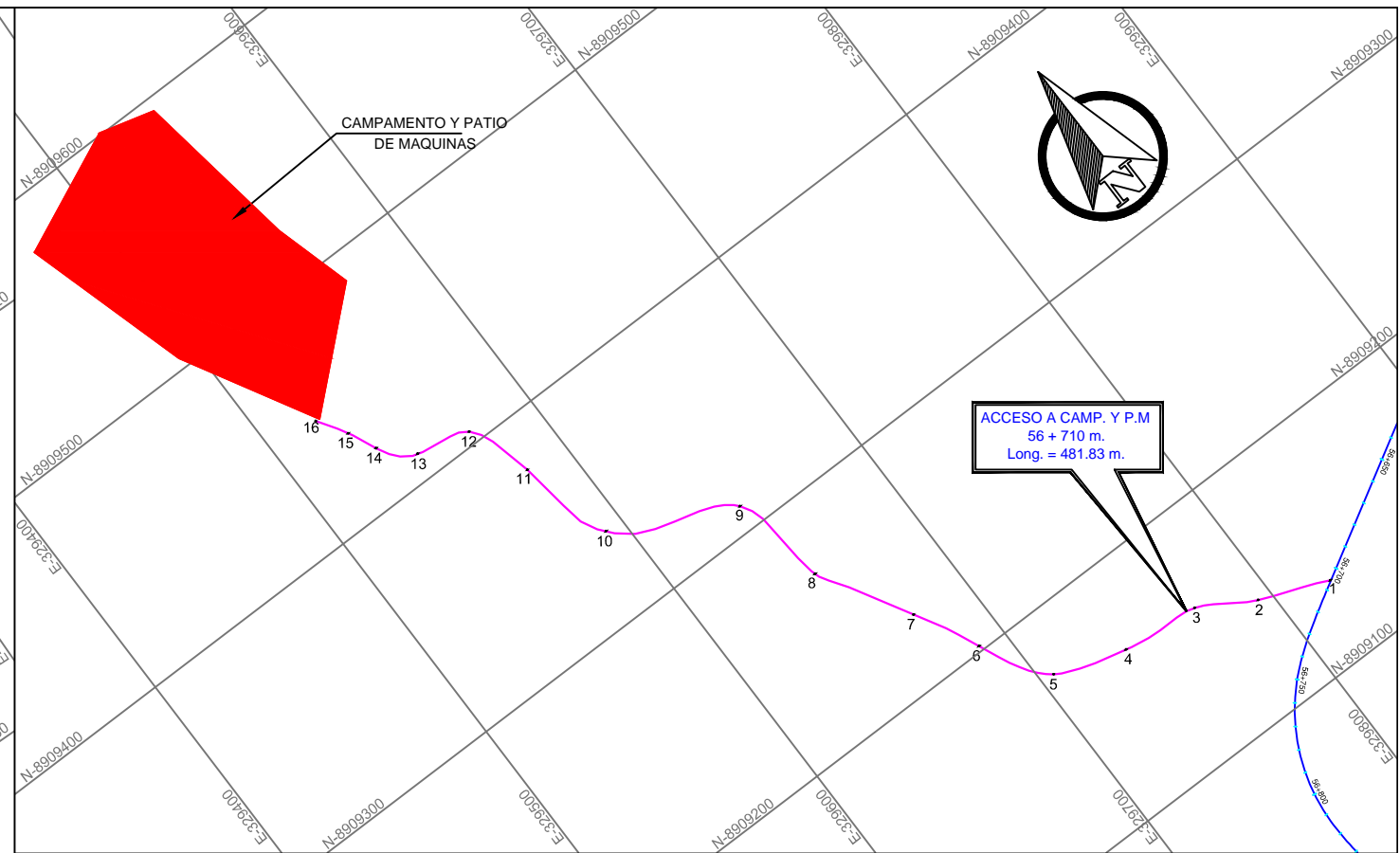
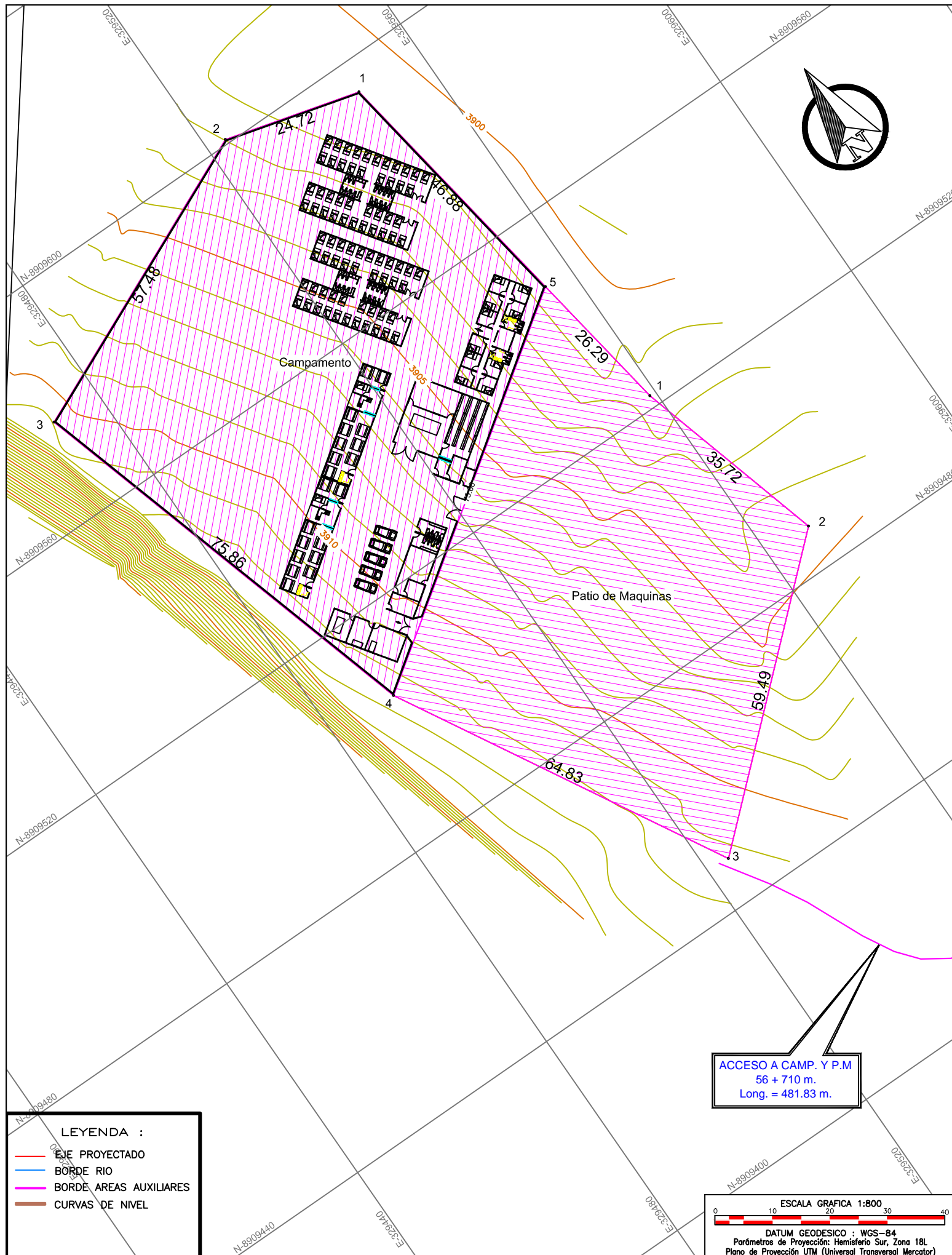

ACCESO A CAMPAMENTO Y PATIO DE MAQUINAS
Esc: 1/3000

| CUADRO DE CONSTRUCCION DEL ACCESO | | | | | |
|-----------------------------------|---------|-------|------------|-------------|--------------|
| VERTICE | LADO | DIST. | ANGULO | ESTE | NORTE |
| 1 | 1 - 2 | 31.70 | 60°42'4" | 329823.2507 | 8909134.2090 |
| 2 | 2 - 3 | 27.07 | 171°56'36" | 329793.8927 | 8909146.1690 |
| 3 | 3 - 4 | 34.00 | 204°11'23" | 329770.4978 | 8909159.7972 |
| 4 | 4 - 5 | 32.41 | 167°32'22" | 329736.6814 | 8909163.3707 |
| 5 | 5 - 6 | 33.78 | 140°32'50" | 329705.9437 | 8909173.6510 |
| 6 | 6 - 7 | 30.71 | 174°54'24" | 329688.0140 | 8909202.2836 |
| 7 | 7 - 8 | 45.16 | 183°15'14" | 329674.0903 | 8909229.6561 |
| 8 | 8 - 9 | 42.66 | 159°37'38" | 329651.3647 | 8909268.6791 |
| 9 | 9 - 10 | 58.35 | 233°38'45" | 329644.0733 | 8909310.7067 |
| 10 | 10 - 11 | 42.24 | 131°13'38" | 329591.8610 | 8909336.7524 |
| 11 | 11 - 12 | 29.44 | 184°34'35" | 329581.1309 | 8909377.6085 |
| 12 | 12 - 13 | 23.78 | 236°46'38" | 329571.4044 | 8909405.3959 |
| 13 | 13 - 14 | 17.85 | 148°56'22" | 329548.3226 | 8909411.1213 |
| 14 | 14 - 15 | 13.40 | 159°44'19" | 329535.7013 | 8909423.7390 |
| 15 | 15 - 16 | 14.65 | 187°10'26" | 329530.0938 | 8909435.9043 |

| CUADRO DE CONSTRUCCION CAMPAMENTO | | | | | |
|-----------------------------------|-----------------------------|-------|------------|-------------|--------------|
| AREA | : 5,008.1659 m ² | | | | |
| PERIMETRO | : 280.7973 ml | | | | |
| VERTICE | LADO | DIST. | ANGULO | ESTE | NORTE |
| 1 | 1 - 2 | 24.72 | 114°6'27" | 329547.3273 | 8909594.3455 |
| 2 | 2 - 3 | 57.48 | 140°53'59" | 329523.4602 | 8909600.7859 |
| 3 | 3 - 4 | 75.86 | 97°32'57" | 329470.9535 | 8909577.4097 |
| 4 | 4 - 5 | 75.86 | 71°34'11" | 329492.4342 | 8909504.6579 |
| 5 | 5 - 1 | 46.88 | 115°52'25" | 329554.6666 | 8909548.0395 |

| CUADRO DE CONSTRUCCION PATIO DE MAQUINAS | | | | | |
|--|-----------------------------|-------|------------|-------------|--------------|
| AREA | : 4,005.2292 m ² | | | | |
| PERIMETRO | : 262.1879 ml | | | | |
| VERTICE | LADO | DIST. | ANGULO | ESTE | NORTE |
| 1 | 1 - 2 | 35.72 | 115°49'43" | 329568.5686 | 8909487.7221 |
| 2 | 2 - 3 | 59.49 | 77°34'57" | 329524.1759 | 8909448.1263 |
| 3 | 3 - 4 | 64.83 | 95°33'59" | 329492.4342 | 8909504.6579 |
| 4 | 4 - 5 | 75.86 | 64°7'35" | 329554.6666 | 8909548.0395 |
| 5 | 5 - 1 | 26.29 | 186°53'46" | 329558.7826 | 8909522.0704 |

- LEYENDA :**
- EJE PROYECTADO
 - BORDE RIO
 - BORDE AREAS AUXILIARES
 - CURVAS DE NIVEL



| CUADRO DE CONSTRUCCION CAMPAMENTO | | | | | |
|-----------------------------------|---------------|-------|------------|-------------|--------------|
| AREA | : 852.2502 m2 | | | | |
| PERIMETRO | : 133.7989 ml | | | | |
| VERTICE | LADO | DIST. | ANGULO | ESTE | NORTE |
| 1 | 1 - 2 | 15.81 | 97°24'5" | 327277.7801 | 8907346.7350 |
| 2 | 2 - 3 | 38.63 | 95°35'47" | 327293.0000 | 8907351.0000 |
| 3 | 3 - 4 | 28.42 | 108°3'6" | 327307.0000 | 8907315.0000 |
| 4 | 4 - 5 | 25.99 | 51°31'9" | 327285.0064 | 8907296.9971 |
| 5 | 5 - 6 | 12.46 | 203°8'41" | 327284.6339 | 8907322.9876 |
| 6 | 6 - 1 | 12.49 | 164°17'12" | 327279.5733 | 8907334.3720 |

| CUADRO DE CONSTRUCCION PATIO DE MAQUINAS | | | | | |
|--|---------------|-------|-----------|-------------|--------------|
| AREA | : 822.9401m2 | | | | |
| PERIMETRO | : 124.4957 ml | | | | |
| VERTICE | LADO | DIST. | ANGULO | ESTE | NORTE |
| 1 | 1 - 2 | 34.01 | 97°47'31" | 327287.0000 | 8907278.0000 |
| 2 | 2 - 3 | 38.63 | 70°26'3" | 327321.0000 | 8907279.0000 |
| 3 | 3 - 4 | 28.42 | 71°56'54" | 327307.0000 | 8907315.0000 |
| 4 | 4 - 5 | 7.10 | 78°36'22" | 327285.0064 | 8907296.9971 |
| 5 | 5 - 6 | 7.84 | 269°20'4" | 327290.5000 | 8907292.5000 |
| 6 | 6 - 1 | 8.49 | 131°53'6" | 327285.6023 | 8907286.3732 |

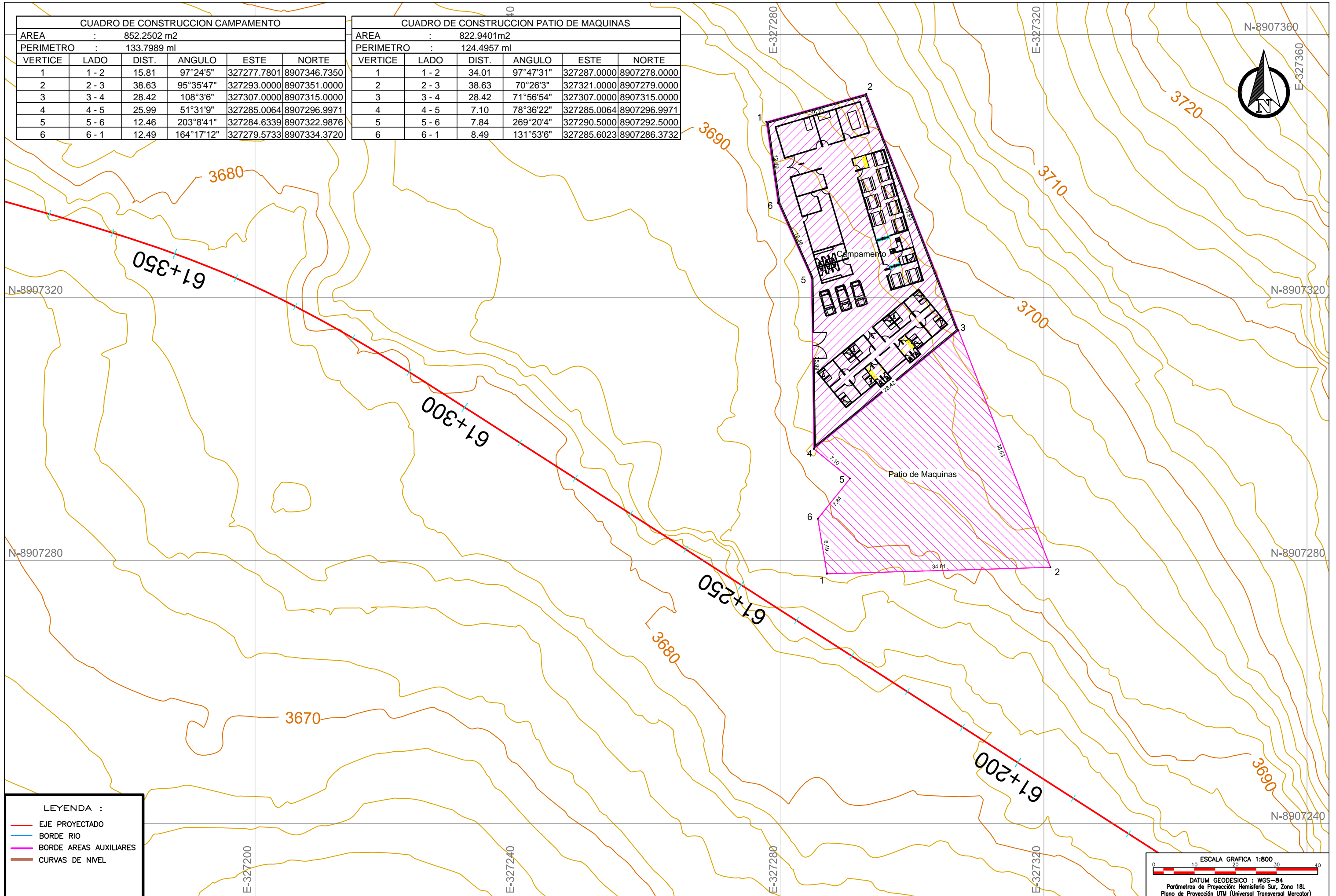

| LEYENDA : | |
|-----------|------------------------|
| | EJE PROYECTADO |
| | BORDE RIO |
| | BORDE AREAS AUXILIARES |
| | CURVAS DE NIVEL |

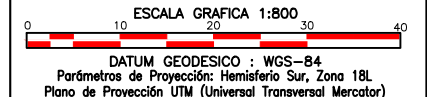

| CUADRO DE CONSTRUCCION PATIO DE MAQUINAS | | | | | |
|--|-------|---------------|------------|-------------|--------------|
| AREA | | 5,001.9234 m2 | | | |
| PERIMETRO | | 320.3953 ml | | | |
| VERTICE | LADO | DIST. | ANGULO | ESTE | NORTE |
| 1 | 1 - 2 | 27.88 | 169°55'27" | 311246.8194 | 8932457.5667 |
| 2 | 2 - 3 | 126.18 | 79°14'40" | 311222.3497 | 8932444.2142 |
| 3 | 3 - 4 | 31.71 | 80°21'4" | 311183.6409 | 8932564.3119 |
| 4 | 4 - 5 | 20.45 | 103°12'5" | 311215.0257 | 8932568.8434 |
| 5 | 5 - 6 | 32.81 | 198°12'47" | 311222.4933 | 8932549.8053 |
| 6 | 6 - 7 | 56.17 | 164°36'54" | 311243.4177 | 8932524.5392 |
| 7 | 7 - 1 | 25.20 | 104°27'3" | 311266.4853 | 8932473.3198 |

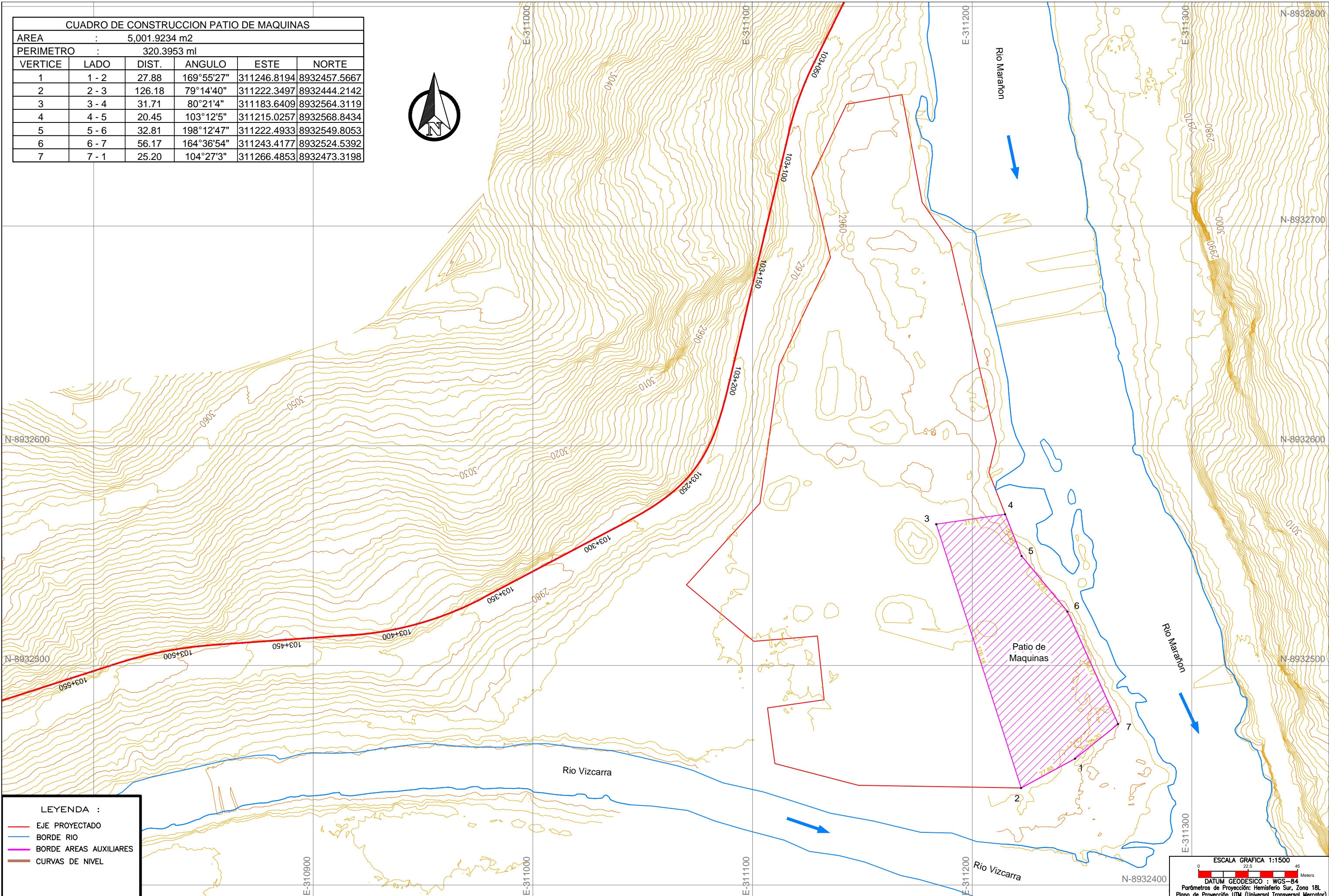

LEYENDA :

- EJE PROYECTADO
- BORDE RIO
- BORDE AREAS AUXILIARES
- CURVAS DE NIVEL

ESCALA GRAFICA 1:1500

DATUM GEODESICO : WGS-84
 Parámetros de Proyección: Hemisferio Sur, Zona 18L
 Plano de Proyección UTM (Universal Transversal Mercator)



CONSULTOR:

DISEÑO:

DIBUJO:

VERIFICO:

PRESENTO:

APROBO :

| REVISIONES | |
|------------|-------------------|
| N° | FECHA DESCRIPCION |
| | |
| | |
| | |

ESTUDIO DEFINITIVO PARA EL MEJORAMIENTO DE LA CARRETERA
 HUÁNUCO-CONOCHOCHA, SECTOR HUÁNUCO-LA UNIÓN-HUALLANCA RUTA PE-3N
 CONTRATO N°DU 078-2009(CP) - 1-2009-DU-GR-LL-GRI-CE

INSTALACIONES AUXILIARES
 KM 103+200
 Patio de Maquinas

ESCALA: 1/1500

FECHA: AGOSTO 2015

PLANO N°:

HOJA:

| CUADRO DE CONSTRUCCION PATIO DE MAQUINAS | | | | | |
|--|-----------------------------|-------|------------|-------------|--------------|
| AREA | : 3,000.0000 m ² | | | | |
| PERIMETRO | : 266.4136 ml | | | | |
| VERTICE | LADO | DIST. | ANGULO | ESTE | NORTE |
| 1 | 1 - 6 | 22.25 | 61°1'14" | 301966.5065 | 8918610.1813 |
| 2 | 1 - 2 | 45.14 | 192°36'43" | 302005.0882 | 8918586.7542 |
| 3 | 2 - 3 | 64.72 | 65°51'34" | 302066.4079 | 8918566.0531 |
| 4 | 3 - 4 | 44.66 | 100°27'22" | 302036.0684 | 8918533.2834 |
| 5 | 4 - 5 | 48.28 | 168°8'34" | 301995.2789 | 8918559.1080 |
| 6 | 5 - 6 | 41.37 | 131°54'33" | 301965.6186 | 8918587.9474 |

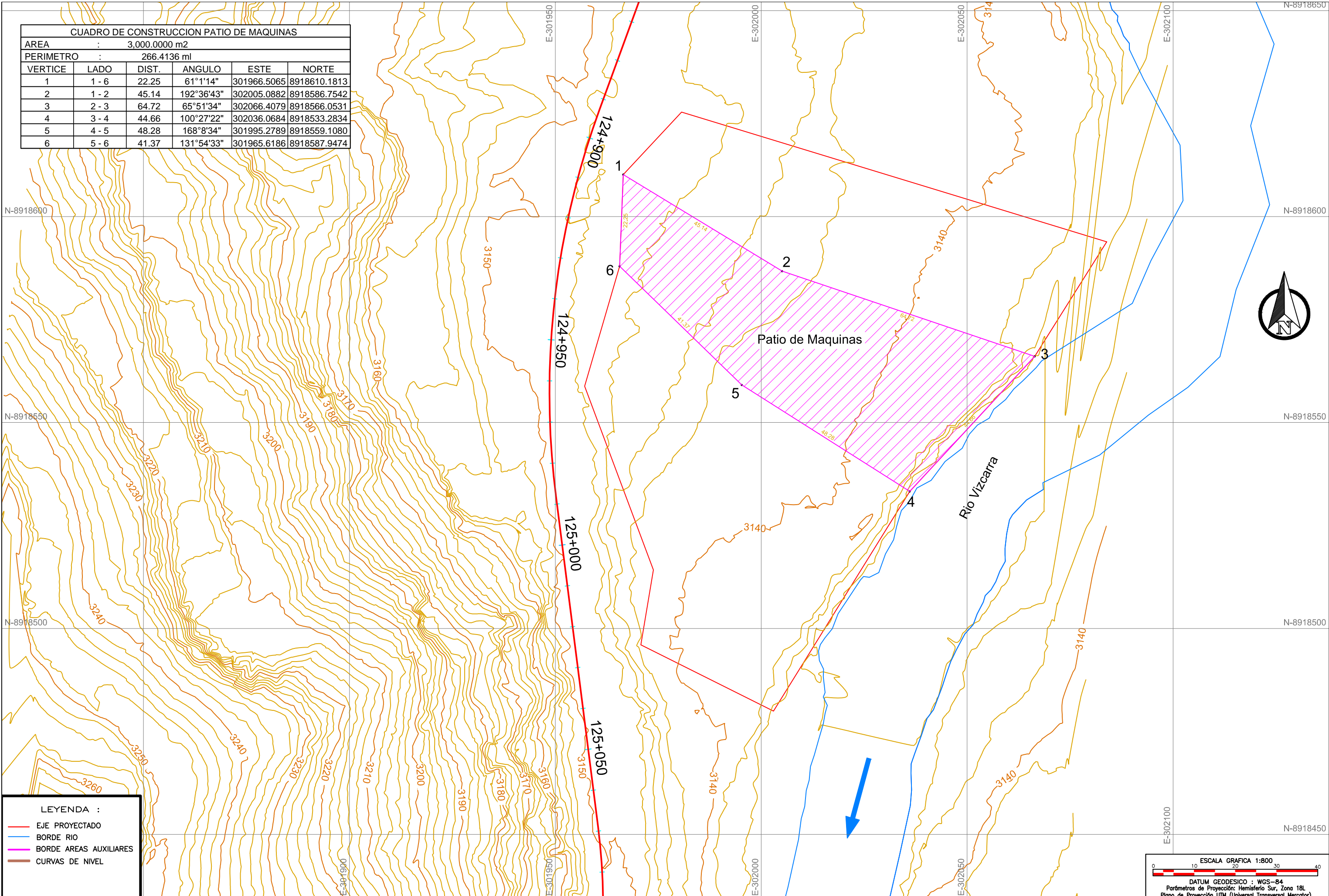

LEYENDA :

- EJE PROYECTADO
- BORDE RIO
- BORDE AREAS AUXILIARES
- CURVAS DE NIVEL

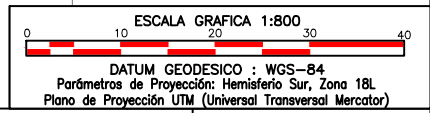

CONSULTOR:

DISEÑO:

DIBUJO:

VERIFICO:

PRESENTO:

APROBO :

| REVISIONES | | |
|------------|-------|-------------|
| N° | FECHA | DESCRIPCION |
| | | |
| | | |
| | | |

ESTUDIO DEFINITIVO PARA EL MEJORAMIENTO DE LA CARRETERA
 HUÁNUCO-CONOCHOCA, SECTOR HUÁNUCO-LA UNIÓN-HUALLANCA RUTA PE-3N
 CONTRATO N°DU 078-2009(CP) - 1-2009-DU-GR-LL-GRI-CE

| | |
|--|--------------------|
| INSTALACIONES AUXILIARES KM 124+960 | ESCALA: 1/800 |
| Patio de Maquinas | FECHA: AGOSTO 2015 |
| | PLANO N°: |
| | HOJA: |