

Resettlement and Ethnic Development Plan

Project Number: 41924-014
October 2016

Nam Ngiep 1 Hydropower Project (Lao People's Democratic Republic)

Resettlement and Ethnic Development Plan Updated Zone 2 Lower Reservoir (REDP-2LR) - Annexes D and E

Prepared by Nam Ngiep 1 Power Company Limited for the Asian Development Bank

This report is a document of the borrower. The views expressed herein do not necessarily represent those of ADB's Board of Directors, Management, or staff, and may be preliminary in nature. Your attention is directed to the "Terms of Use" section of this website.

In preparing any country program or strategy, financing any project, or by making any designation of or reference to a particular territory or geographic area in this document, the Asian Development Bank does not intend to make any judgments as to the legal or other status of any territory or area.

Annex D – Government of Lao Decrees



ສາທາລະນະລັດ ປະຊາທິປະໄຕ ປະຊາຊົນລາວ

ສັນຕິພາບ ເອກະລາດ ປະຊາທິປະໄຕ ເອກະພາບ ວັດທະນະຖາວອນ.

ແຂວງໄຊສົມບູນ
ສຳນັກງານປົກຄອງແຂວງ

ເລກທີ 694 /ຈຂ.ຊບ.
ໄຊສົມບູນ, ວັນທີ 17.6.2016

ຄຳສັ່ງແນະນຳ

ຂອງປະທານຄະນະກຳມະການຍົກຍ້າຍຈັດສັນ ແລະ ພື້ນຟູ
ຊີວິດການເປັນຢູ່ປະຊາຊົນ ຂອງໂຄງການ ກໍ່ສ້າງເຂື່ອນ ໄຟຟ້ານ້ຳງຽບ1.

ເຖິງ:

- ທ່ານ ເຈົ້າເມືອງ-ເມືອງຮົ່ມ ແຂວງ ໄຊສົມບູນ.
- ທ່ານ ເຈົ້າເມືອງ-ເມືອງທ່າໂທມ ແຂວງໄຊສົມບູນ.
- ທ່ານ ຫົວໜ້າກອງເລຂາຄະນະກຳມະການຍົກຍ້າຍຈັດສັນ ແລະ ພື້ນຟູຊີວິດການເປັນຢູ່ຂອງປະຊາຊົນໂຄງການ ເຂື່ອນ ໄຟຟ້ານ້ຳງຽບ1ແຂວງໄຊສົມບູນ.
- ອຳນາດການປົກຄອງບ້ານ ແລະ ປະຊາຊົນຜູ້ທີ່ມີຜົນກະທົບຈາກໂຄງການກໍ່ສ້າງເຂື່ອນໄຟຟ້ານ້ຳງຽບ1.
- ບໍລິສັດ ໄຟຟ້ານ້ຳງຽບ1 ຈຳກັດ.

ເລື່ອງ: ການເລັ່ງລັດ ໃນການຂຶ້ນທະບຽນຊັບສິນ ຂອງຄົວເຮືອນທີ່ມີຜົນກະທົບ ຈາກການກໍ່ສ້າງເຂື່ອນໄຟຟ້ານ້ຳງຽບ1 ໃຕ້
ສຳເລັດຜົນ ໂດຍດ່ວນ.

- ອີງຕາມ ສັນຍາສຳປະທານໂຄງການ ລະຫວ່າງ ລັດຖະບານແຫ່ງ ສປປ ລາວ ກັບ ບໍລິສັດໄຟຟ້ານ້ຳງຽບ1 ຈຳກັດ ສະບັບລົງ
ວັນທີ 27 ສິງຫາ 2013.
- ອີງຕາມ ດຳລັດຂອງນາຍົກລັດຖະມົນຕີ ສະບັບເລກທີ 192ຝນຍ ລົງວັນທີ 07 ກໍລະກົດ 2005 ວ່າດ້ວຍການທົດແທນ
ຄ່າເສຍຫາຍ ແລະ ການຍົກຍ້າຍຈັດສັນປາຊາຊົນທີ່ໄດ້ຮັບຜົນກະທົບຈາກໂຄງການ;
- ອີງຕາມ ຂໍ້ຕົກລົງຂອງນາຍົກລັດຖະມົນຕີສະບັບເລກທີ 24/ນຍ ລົງວັນທີ 17 ເມນາ 2014 ວ່າດ້ວຍການແຕ່ງຕັ້ງຄະນະ
ກຳມະການຍົກຍ້າຍຈັດສັນ ແລະ ພື້ນຟູຊີວິດການເປັນຢູ່ປະຊາຊົນທີ່ຖືກກະທົບຈາກໂຄງການໄຟຟ້ານ້ຳງຽບ1
- ອີງຕາມ ສະພາບຄວາມເປັນຈິງໃນການຈັດຕັ້ງປະຕິບັດຂຶ້ນທະບຽນຊັບສິນຂອງໂຄງການເຂື່ອນໄຟຟ້າ ນ້ຳງຽບ1.

ຈາກການສະຫຼຸບການຂຶ້ນທະບຽນຊັບສິນ ແລະ ການຊົດເຊີຍຕົວຈິງ ຂອງບ້ານທີ່ຖືກຜົນກະທົບຂອງໂຄງການເຫັນ
ວ່າມີຄວາມສຳເລັດເປັນສ່ວນໃຫຍ່ປະມານ 90% ຂອງຜູ້ທີ່ມີຜົນກະທົບ ແມ່ນສຳເລັດການຂຶ້ນທະບຽນຊັບສິນຂອງຕົນເອງ

ແລະ ມີຄວາມພ້ອມໃນການປະຕິບັດການຍົກຍ້າຍ ຕາມແຜນການຂອງໂຄງການ ແລະ ລັດຖະບານ. ເຖິງຢ່າງໃດກໍ່ຕາມ, ຍັງ
ມີຄົວເຮືອນຈຳນວນໜຶ່ງ ໂດຍສະເພາະແມ່ນ ໃນ 4 ບ້ານຂອງເມືອງຮົ່ມ ຍັງບໍ່ທັນຂຶ້ນທະບຽນຊັບສິນຂອງຕົນເອງ ເປັນ
ສາຍເຫດໃຫ້ການຂຶ້ນທະບຽນຊັບສິນ ມີຄວາມລ້ຳຊ້າ, ແກ່ຍາວການຊົດເຊີຍ ແລະ ການຈັດຕັ້ງປະຕິບັດ ໂຄງການໂດຍລວມ
ເພື່ອໃຫ້ການຊົດເຊີຍ ແລະ ການຈັດຕັ້ງປະຕິບັດໂຄງການ ເປັນໄປຕາມແຜນການທີ່ກຳນົດໄວ້:

ເຈົ້າແຂວງໄຊສົມບູນ

ປະທານຄະນະກຳມະການຍົກຍ້າຍຈັດສັນ ແລະ ຟື້ນຟູ

ຊີວິດການເປັນຢູ່ໂຄງການເຂື່ອນໄຟຟ້ານ້ຳງຽບ1 ອອກຄຳສັ່ງແນະນຳ ດັ່ງນີ້:

ມາດຕາ 1: ໃຫ້ກອງເລຂາຄະນະກຳມະການຍົກຍ້າຍຈັດສັນ ສົມທົບກັບ ບໍລິສັດໄຟຟ້ານ້ຳງຽບ1 ແລະ ອຳນາດການປົກຄອງ
ຕະຫຼອດຮອດພໍ່ແມ່ນປະຊາຊົນ ໃນ 4 ບ້ານ ເຂດເມືອງຮົ່ມ (ບ້ານຫ້ວຍປາມອອມ, ບ້ານສົບພວນ, ບ້ານໜອງ
ແລະ ບ້ານນ້ຳຢວກ) ທີ່ມີຜົນກະທົບຈາກ ການກໍ່ສ້າງເຂື່ອນ ໄຟຟ້ານ້ຳງຽບ1 ໃຫ້ເລັ່ງລັດການຂຶ້ນທະບຽນຊັບສິນ
ທັງຫມົດ ໃຫ້ສຳເລັດ ພາຍໃນ ວັນທີ 10 ກໍລະກົດ 2016 ເພື່ອເປັນຂໍ້ມູນໃຫ້ແກ່ການຄິດໄລ່ ແລະ ດຳເນີນການ
ຊົດເຊີຍ ຕາມລະບຽບການ;

ມາດຕາ 2: ໃຫ້ ກອງເລຂາ ສົມທົບກັບ ອຳນາດປົກຄອງເມືອງຮົ່ມ, ບ້ານ ແລະ ບໍລິສັດ ໄຟຟ້າ ນ້ຳງຽບ1 ກວດກາຄືນ
ຈຳນວນ ຄົວເຮືອນທີ່ຍັງບໍ່ທັນໄດ້ຂຶ້ນທະບຽນຊັບສິນຂອງຕົນເອງ ພ້ອມກັບວາງແຜນຈັດຕັ້ງປະຕິບັດໃຫ້ສຳເລັດ
ຕາມກຳນົດຫມາຍທີ່ກ່າວມາຂ້າງເທິງນັ້ນ (ພາຍໃນວັນທີ 10 ກໍລະກົດ 2016);

ມາດຕາ 3: ກໍລະນີ ຄົວເຮືອນໃດທີ່ຍັງບໍ່ທັນສາມາດຂຶ້ນທະບຽນຊັບສິນຂອງຕົນເອງ ສຳເລັດພາຍໃນ ວັນທີ 30 ມິຖຸນາ
2016 ແມ່ນ ໃຫ້ປະຕິບັດດັ່ງນີ້:

- 3.1 ສຳລັບສິ່ງບຸກສ້າງ ແລະ ດິນບຸກສ້າງ ແມ່ນ ໃຫ້ເກັບກຳຂໍ້ມູນດ້ວຍການຖ່າຍຮູບ ແລະ ສຳເນົາເອກະສານສິດນຳ
ໃຊ້ ແລະ ຄອບຄອງຕ່າງໆ ເປັນຫຼັກຖານ ເທົ່າທີ່ເຮັດໄດ້;
- 3.2 ສຳລັບດິນກະສິກຳ ແມ່ນໃຫ້ສຳເນົາເອກະສານສິດການນຳໃຊ້ ແລະ ການຄອບຄອງທີ່ດິນ ເທົ່າທີ່ເຮັດໄດ້;
- 3.3 ສະຫຼຸບ-ສັງລວມ ແລະ ສົ່ງຂໍ້ມູນຊັບສິນຂອງຜູ້ທີ່ບໍ່ທັນຂຶ້ນທະບຽນ ທັງຫມົດໃຫ້ ອຳນາດການປົກຄອງເມືອງ
ອຳນາດການປົກຄອງບ້ານ ແລະ ກອງເລຂາ ຄະນະກຳມະການຍົກຍ້າຍຈັດສັນ ເພື່ອລົງລາຍເຊັນ ຢັ້ງຢືນ ແລະ
ຮັກສາໄວ້ເປັນຫຼັກຖານ;
- 3.4 ກອງເລຂາຄະນະກຳມະການຍົກຍ້າຍຈັດສັນ ໂຄງການໄຟຟ້ານ້ຳງຽບ1 ສຳເນົາ ແລະ ແຈ້ງຂໍ້ມູນດັ່ງກ່າວໄປໃຫ້ຍັງ
ເຈົ້າຂອງຊັບສິນ ພ້ອມກັນນັ້ນ ກໍສົ່ງສຳເນົາໃຫ້ບໍລິສັດໄຟຟ້ານ້ຳງຽບ1 ເພື່ອຮັບຊາບ ແລະ ຮັກສາໄວ້ ເປັນຫຼັກ
ຖານ;
- 3.5 ແຈ້ງໃຫ້ເຈົ້າຂອງທີ່ດິນຮັບຊາບວ່າ ພວກເຂົາເຈົ້າສາມາດຂໍການຊົດເຊີຍດ້ວຍການຮ້ອງທຸກ ດ້ວຍການສະແດງ
ຫຼັກຖານດັ່ງກ່າວ ກັບໜ່ວຍງານຮັບຄຳຮ້ອງທຸກ ແລະ ໄກ່ເກ່ງຂຶ້ນບ້ານ ເພື່ອສະເຫນີຕໍ່ຫາຍັງຄະນະກຳມະການ
ໄກ່ເກ່ງຂຶ້ນເມືອງ ແລະ ໂຄງການ ຕາມລຳດັບ;

ມາດຕາ 4: ໃຫ້ເລັ່ງລັດ ທຸກຂະບວນການວຽກ ລວມທັງ ການແຈ້ງຊັບສິນຄົວເຮືອນ ທີ່ສໍາເລັດການວັດແທກພາກສະຫນາມ ການແຈ້ງມູນຄ່າການຊົດເຊີຍ, ການສ້າງສັນຍາຊົດເຊີຍ, ການແຈ້ງທາງເລືອກການຍົກຍ້າຍ ແລະ ວຽກງານອື່ນໆ ພາຍໃນທ້າຍເດືອນ ສິງຫາ 2016 ແລະ ໃຫ້ສໍາເລັດການຈ່າຍເງິນຊົດເຊີຍ ກ່ອນເດືອນ ທັນວາ ປີ 2016;

ມາດຕາ 5: ໃຫ້ກອງເລຂາ ລາຍງານຄວາມຄືບໜ້າຂອງການຈັດຕັ້ງປະຕິບັດໂຄງການ ໃຫ້ປະທານຄະນະກຳມະການຍົກ ຍ້າຍຈັດສັນ ແລະ ພື້ນຟູຊົດການເປັນຢູ່ປະຊາຊົນ ເປັນແຕ່ລະອາທິດ ເພື່ອການຊີ້ນຳ ແລະ ແກ້ໄຂບັນຫາໃຫ້ທັນ ເວລາ;

ມາດຕາ 6: ຄຳສັ່ງແນະນຳສະບັບນີ້ ມີຜົນສັກສິດ ແລະ ບັງຄັບໃຊ້ໄດ້ນັບແຕ່ມີລົງລາຍເຊັນ ເປັນຕົ້ນໄປ.

ເຈົ້າແຂວງໄຊສົມບູນ

ປະທານຄະນະກຳມະການຍົກຍ້າຍຈັດສັນ ແລະ ພື້ນຟູ
ຊີວິດການເປັນຢູ່ຂອງປະຊາຊົນ ໂຄງການ ເຂື່ອນໄຟຟ້ານ້ຳງຽບ1



ດຣ. ທອງລອຍ ສິລິວິງ



ສາທາລະນະລັດ ປະຊາທິປະໄຕ ປະຊາຊົນລາວ
ສັນຕິພາບ ເອກະລາດ ປະຊາທິປະໄຕ ເອກະພາບ ວັດທະນະຖາວອນ.

ແຂວງໄຊສົມບູນ

ສໍານັກງານປົກຄອງແຂວງ

ເລກທີ 695 /ຈຂ.ຊບ.

ໄຊສົມບູນ, ວັນທີ 17.6.2016

ແຈ້ງການເພີ່ມເຕີມ

ເຖິງ:

- ທ່ານ ເຈົ້າເມືອງ-ເມືອງຮົ່ມ ແຂວງໄຊສົມບູນ.
- ທ່ານ ເຈົ້າເມືອງ-ເມືອງທ່າໂທມ ແຂວງໄຊສົມບູນ.
- ທ່ານ ຫົວໜ້າກອງເລຂາຄະນະກຳມະການຍົກຍ້າຍຈັດສັນ ແລະ ພື້ນຟູຊີວິດການເປັນຢູ່ຂອງປະຊາຊົນ ໂຄງການເຂື່ອນໄຟຟ້ານ້ຳງຽບ1 ແຂວງໄຊສົມບູນ.
- ອຳນາດການປົກຄອງບ້ານ ແລະ ປະຊາຊົນຜູ້ທີ່ມີຜົນກະທົບຈາກໂຄງການກໍ່ສ້າງເຂື່ອນໄຟຟ້ານ້ຳງຽບ1.
- ບໍລິສັດໄຟຟ້ານ້ຳງຽບ1 ຈຳກັດ.

ເລື່ອງ: ວັນເລີ່ມຕົ້ນໂຄງການ ເຂື່ອນໄຟຟ້ານ້ຳງຽບ 1 ຂອງບັນດາບ້ານທີ່ມີຜົນກະທົບພາຍໃນ ເມືອງຮົ່ມ ແລະ ເມືອງທ່າໂທມ ແຂວງໄຊສົມບູນ.

- ອີງຕາມ ກົດໝາຍວ່າດ້ວຍການປົກຄອງທ້ອງຖິ່ນສະບັບເລກທີ 03/ສພຊ,ລົງວັນທີ 21 ຕຸລາ 2003.
- ອີງຕາມ ສັນຍາສໍາປະທານໂຄງການ ລະຫວ່າງ ລັດຖະບານແຫ່ງ ສປປ ລາວ ກັບ ບໍລິສັດໄຟຟ້ານ້ຳງຽບ1 ຈຳກັດ ສະບັບລົງວັນທີ 27 ສິງຫາ 2013.
- ອີງຕາມ ຄໍາສັ່ງຂອງທ່ານເຈົ້າແຂວງໄຊສົມບູນ, ປະທານຄະນະກຳມະການຍົກຍ້າຍຈັດສັນ ແລະ ພື້ນຟູຊີວິດການເປັນຢູ່ຂອງປະຊາຊົນໂຄງການເຂື່ອນໄຟຟ້ານ້ຳງຽບ1, ສະບັບເລກທີ 359/ຈຂ.ຊບ. ລົງວັນທີ 16 ພຶດສະພາ 2014 ວ່າດ້ວຍການກຳນົດວັນເລີ່ມຕົ້ນ ໂຄງການກໍ່ສ້າງ ເຂື່ອນໄຟຟ້ານ້ຳງຽບ1 ຢ່າງເປັນທາງການເພື່ອແຈ້ງໃຫ້ບັນດາຄອບຄົວຜູ້ທີ່ຖືກກະທົບຈາກໂຄງການຮັບຊາບ.

ໃນໄລຍະທີ່ຜ່ານມາ ການນຳໃຊ້ "ມື້ເລີ່ມຕົ້ນໂຄງການເຂື່ອນໄຟຟ້ານ້ຳງຽບ1" ສໍາລັບບັນດາບ້ານທີ່ມີຜົນກະທົບ ໃນສອງເມືອງຄື: ເມືອງຮົ່ມ ແລະ ເມືອງທ່າໂທມ ແຂວງໄຊສົມບູນ ເຫັນວ່າ: ຍັງບໍ່ທັນມີຄວາມເປັນເອກະພາບກັນ, ເນື່ອງຈາກຄວາມລ້າຊ້າ ໃນການປະກາດໃຫ້ປະຊາຊົນຮັບຊາບ ຫຼັງຈາກທີ່ທ່ານເຈົ້າແຂວງໄຊສົມບູນ ປະທານຄະນະກຳມະການຍົກຍ້າຍຈັດສັນ ແລະ ພື້ນຟູຊີວິດການເປັນຢູ່ຂອງປະຊາຊົນໂຄງການໄຟຟ້ານ້ຳງຽບ1 ໄດ້ອອກ

ແຈ້ງການສະບັບເລກທີ 359/ຈຂ.ຊບ, ລົງວັນທີ 16 ພຶດສະພາ 2014 ເປັນສາເຫດເຮັດໃຫ້ເກີດການຕີຄວາມໝາຍ ແຕກຕ່າງກັນຂອງພາກສ່ວນທີ່ກ່ຽວຂ້ອງ. ສະນັ້ນ, ເພື່ອເຮັດໃຫ້ມີຄວາມເປັນເອກະພາບກັນໃນການຈັດຕັ້ງປະຕິບັດ ສອດຄ່ອງກັບລະບຽບການ ແລະ ຄວາມເປັນຈິງ.

ເຈົ້າແຂວງໄຊສົມບູນ

ປະທານຄະນະກຳມະການຍົກຍ້າຍຈັດສັນ ແລະ ພື້ນຟູຊີວິດການ
ເປັນຢູ່ປະຊາຊົນ ໂຄງການເຂື່ອນໄຟຟ້ານ້ຳງຽບ 1 ອອກແຈ້ງການເພີ່ມເຕີມ ດັ່ງນີ້:

ມາດຕາ 1: ໃຫ້ຖືເອົາ ມີ້ສຸດທ້າຍໃນການລົງປະກາດ ຄຳສັ່ງຂອງທ່ານເຈົ້າແຂວງໄຊສົມບູນ ປະທານຄະນະກຳມະການ ຍົກຍ້າຍຈັດສັນ ແລະ ພື້ນຟູຊີວິດການເປັນຢູ່ຂອງປະຊາຊົນ ໂຄງການ ເຂື່ອນໄຟຟ້ານ້ຳງຽບ 1, ສະບັບ ເລກທີ 359/ຈຂ.ຊບ, ລົງວັນທີ 16 ພຶດສະພາ 2014 ໃນແຕ່ລະເຂດເປັນ "ມີ້ເລີ່ມຕົ້ນໂຄງການເຂື່ອນ ໄຟຟ້ານ້ຳງຽບ1" ເຊິ່ງມີລາຍລະອຽດດັ່ງນີ້:

- ເມືອງຮົ່ມ, ແຂວງໄຊສົມບູນ: ບ້ານຫ້ວຍປາມ້ອມ, ບ້ານສົບພວນ, ບ້ານສົບຢວກ(ບ້ານໜອງ) ແລະ ບ້ານນ້ຳຢວກ ຂອງເມືອງຮົ່ມ ແມ່ນໃຫ້ຖືເອົາວັນທີ 03 ກັນຍາ 2015 ເປັນມີ້ເລີ່ມຕົ້ນໂຄງການ;
- ເມືອງທ່າໂທມ, ແຂວງໄຊສົມບູນ: ບ້ານປູ່, ບ້ານຫາດສາມຄອນ ແລະ ບ້ານພຽງຕາ ແມ່ນໃຫ້ຖືເອົາ ວັນທີ 21 ສິງຫາ 2015 ເປັນມີ້ເລີ່ມຕົ້ນໂຄງການ;

ມາດຕາ 2: ໃຫ້ຖືເອົາມີ້ເລີ່ມຕົ້ນໂຄງການ ທີ່ກຳວມາຂ້າງເທິງນີ້ ເປັນມີ້ຂີດຂັ້ນການໄດ້ຮັບສິດ ຫຼື ບໍ່ໄດ້ຮັບສິດ ພິຈາລະນາການຊົດເຊີຍຕໍ່ກັບຊັບສິນ ຫຼື ການເປັນຄົວເຮືອນ ຫຼື ບຸກຄົນທີ່ມີຜົນກະທົບຈາກໂຄງການ ກໍ່ສ້າງເຂື່ອນໄຟຟ້ານ້ຳງຽບ1 ໂດຍໃຫ້ຖືວ່າ:

- 2.1 ຊັບສິນໃດທີ່ມີຂຶ້ນ ແລະ ເຫັນໄດ້ ຮອດມີ້ເລີ່ມຕົ້ນໂຄງການທີ່ກຳນົດຂ້າງເທິງນັ້ນ ແມ່ນຈະໄດ້ຮັບສິດ ພິຈາລະນາການຊົດເຊີຍ ຕາມນະໂຍບາຍຂອງໂຄງການ ທີ່ກຳນົດອອກໃນແຕ່ລະໄລຍະ;
- 2.2 ຊັບສິນໃດທີ່ມີຂຶ້ນຫຼັງມີ້ເລີ່ມຕົ້ນໂຄງການທີ່ກຳນົດຂ້າງເທິງນີ້ ແມ່ນບໍ່ໄດ້ຮັບສິດພິຈາລະນາການຊົດເຊີຍ ຈາກໂຄງ ການ;
- 2.3 ຄອບຄົວ ຫຼື ບຸກຄົນໃດທີ່ມີໜ້າຢູ່ບ້ານ ແລະ ຂຶ້ນສະມາໂນຄົວຢ່າງຖືກຕ້ອງຕາມກົດໝາຍ ຮອດມີ້ເລີ່ມ ຕົ້ນໂຄງການ ທີ່ກຳນົດຂ້າງເທິງນັ້ນ ແມ່ນໄດ້ຮັບສິດພິຈາລະນາການເປັນຄົວເຮືອນທີ່ມີຜົນກະທົບຕາມ ນະໂຍບາຍຂອງໂຄງການ;
- 2.4 ຄອບຄົວ ແລະ ບຸກຄົນໃດທີ່ມີໜ້າຢູ່ບ້ານ ແລະ/ ຫຼື ຂຶ້ນສະມາໂນຄົວຢູ່ບ້ານຫຼັງມີ້ເລີ່ມຕົ້ນໂຄງການ ທີ່ ກຳນົດຂ້າງເທິງນີ້ ແມ່ນບໍ່ໄດ້ຮັບສິດເປັນຄົວເຮືອນ ຫຼື ບຸກຄົນທີ່ມີຜົນກະທົບຈາກໂຄງການ;

ມາດຕາ 3: ມອບໃຫ້ ກອງເລຂາຫ່ວຍງານຄຸ້ມຄອງການຍົກຍ້າຍຈັດສັນ ແລະ ພື້ນຟູຊີວິດການເປັນຢູ່ປະຊາຊົນ ໂຄງການໄຟຟ້ານ້ຳງຽບ 1 ແຂວງໄຊສົມບູນ, ທ່ານເຈົ້າເມືອງຮົ່ມ ແລະ ເມືອງທ່າໂທມ, ແຂວງໄຊ ສົມບູນ, ອຳນາດການປົກຄອງທ້ອງຖິ່ນ ແລະ ບໍລິສັດໄຟຟ້ານ້ຳງຽບ 1 ພ້ອມກັນລົງເຜີຍແຜ່ເນື້ອໃນ

(ແຈ້ງການເພີ່ມເຕີມ) ສະບັບນີ້ໃຫ້ປະຊາຊົນຜູ້ທີ່ມີຜົນກະທົບຮັບຊາບຢ່າງທົ່ວເຖິງ ແລະ ເຂົ້າໃຈລວງເລິກ;

ມາດຕາ 4: ແຈ້ງການ ຫຼື ມີຕິກຳໃດໆ ທີ່ອອກກ່ອນໜ້ານີ້ ໂດຍມີເນື້ອທີ່ຂັດກັບ ແຈ້ງການເພີ່ມເຕີມ ສະບັບນີ້ ຖືວ່າລົບລ້າງ ແລະ ເປັນໂມຄະ;

ມາດຕາ 5: ແຈ້ງການສະບັບນີ້ ມີຜົນສັກສິດ ແລະ ບັງຄັບໃຊ້ນັບແຕ່ມີລົງລາຍເຊັນເປັນຕົ້ນໄປ.

ເຈົ້າແຂວງໄຊສົມບູນ

ປະທານຄະນະກຳມະການຍົກຍ້າຍຈັດສັນ ແລະ ສິ້ນຟູ
ຊີວິດການເປັນຢູ່ຂອງປະຊາຊົນ ໂຄງການເຂື່ອນໄຟຟ້ານ້ຳງຽບ1



ດຣ. ທອງລອຍ ສິລິວິງ



Lao People's Democratic Republic

Peace Independence Democracy Unity Prosperity

=====000=====

Xaysomboun Province

Province Administration Office

No. 694/ PG. XSB

At Xaysomboun, date 17/06/2016

Advice Mandate

Of

The president of PRLRC of NNP1PC

Attention:

- Hom District Governor, Xaysomboun Province
- Thatom District, Xaysomboun Province
- Head of RMU of NNP1 PC, Xaysomboun Province
- Village Authorities and PAPs from the NNP1
- NNP1PC .,Ltd

Subject: Rush in registering the assets of PAPs from the NNP1 PC to be completed soon.

- In reference to the CA between Lao PDR Government and NNP1PC, dated August 27th 2013.
- In reference to the Decree of Prime Minister issued No. 192/ PM, dated July 7th 2005 on the compensation and Resettlement of PAPs from the project;
- In reference to the agreement of Prime Ministry issued No.24/PM, dated March 17th 2014 on the appointment of PRLRC of NNP1PC.
- In reference to the real situation of the implementation in registering the assets of the NNP1PC.

By briefing of the real asset registration and compensation of the PAPs seemed that the most completion was about 90 % of the asset registration. There were a number of households, especially in 4 villages of Hom District, they didn't register their assets, so it caused the asset registration late and implicated the compensation too late. The implementation of the project to be smoothly in line with the plan:

Xaysomboun Province Governor, the president of PRLRC of NNP1PC issues the advice Mandate as follows:

Article 1: The RMU in association with the NNP1 PC, local authorities and villagers in 4 villages of Home District (as Houypamom, Soppuan, Nong and Namyouak villages) affected from the NNP1PC to rush registering all assets to be completed within July 10th 2016 as the data for the calculation and then compensation in line with the regulation;

Article2: The RMU in association with Hom District, village authorities and NNP1 PC re-check the number of Households who didn't register the asset, this team makes the plan for the implementation to be completed on time as aforementioned(within July 10th 2016);

Article 3: In case, any household couldn't register the asset completely within July 10th 2016, it conducts as follows:

3.1 For the building structure and building land shall collect data by taking photos and copy of document and others to be evidence as possible.

3.2 For the agriculture land should make the copy of document and land handling document, it should do it as possible;

3.3 Collect and send all asset data of household who didn't register to the village, district authorities and RMU to sign , certify and keep as evidence ;

3.4 The RMU of NNP1PC makes copy, inform this data to the assets owners at the same time and send the copy to the NNP1 to know and keep it as evidence;

3.5 Inform the assets owners to know, they could request the compensation by the grievance way, by showing this evidence with the village grievance and conciliation (VGC) to propose the District conciliation committee(DCC) and then to the project successively;

Article 4: Rush all process of work, including informing of Household assets which had been measured completely in the field work, informing the compensation values, making the agreement for compensation, informing the resettlement choice and other works within the end of August 2016 and the completion of compensation payment should be before December 2016;

Article 5 : The RMU shall report the progress of the project implementation to the president of PRLRC weekly to get the direction and resolution on time;

Article 6 : This advice order comes into effect and enforces since the signature.

Xysomboun Province Governor

President of PRLRC of NNP1PC

Dr. Thongloy SILIVONG

Note: unofficial translation



Lao People's Democratic Republic

Peace Independence Democracy Unity Prosperity

=====000=====

Xaysomboun Province

Province Administration Office

No. 695/ PG. XSB

At Xaysomboun, date 17/06/2016

Additional Notice

Attention:

- Hom District Governor, Xaysomboun Province
- Thathom District, Xaysomboun Province
- Head of RMU of NNP1 PC, Xaysomboun Province
- Village Authorities and PAPs from the NNP1
- NNP1PC., Ltd

Subject: Cut-off-date of the NNP1 project of the affected villages at Hom and Thathom Districts, Xaysomboun Province.

- In reference to the law on local administration issued No. 03/NA, dated October 21st 2003.
- In reference to the CA between Lao PDR government and NNP1 PC., Ltd, dated August 27th 2013.
- In reference to the mandate of Xaysomboun Province Governor, the president of PRLRC of the NNP1 project, issued No. 359/PG. XSB, dated May 16th 2014 on the determination of cut-off-date of the NNP1 PC officially to inform the PAPs to know.

In the past time, the use of “cut-off-date of NNP1” for the affected villages in 2 Districts as: Hom and Thathom Districts, Xaysomboun Province seemed that: it is not still unanimous due to late in informing the people to know, after the Xaysomboun Province Governor, president of PRLRC of NNP1 PC issued the notice No. 359/PG. XSB, dated May 16th 2014, this causes to interpret the different meaning of the concerned sectors. So, to help unanimousness in implementing to be in accordance with the regulation and real condition.

**Xaysomboun Province Governor, president of PRLRC of NNP1PC
issues the additional notice as follows:**

- Article 1: It should consider the last date of declaring the mandate of Xaysomboun Province Governor, president of PRLRC of NNP1 PC, issued No. 359/PG. XSB, dated May 16th 2014, " Cut –off-date of NNP1 PC" in each zone as the detail below:
- Hom District, Xaysomboun Province: Houypamom, Soppuan, Sopyuak(Nong) and Namyouak villages should consider the date of September 3rd 2015 as the cut-off-date of the project;
 - Thathom District, Xaysomboun Province: Pou,Hatsamkhone, Piengta villages should consider the date of August 21st 2015 as the cut-off-date of the project;
- Article 2: It should consider the cut-off-date as aforementioned to be deadline between Having right and not having right to consider the compensation for the assets or separation of Household or PAPs, all considers as:
- 2.1 Any existing and appearing assets up to the cut-off-date of the project as Determined above, it should have the right to consider the compensation in line With the project policy that determined in each period;
 - 2.2 Any existing assets after the cut-off-date as determined above, it should not have the right to consider the compensation from the project;
 - 2.3 Any family or person lives in the village and has the family book legitimate up to the cut-off-date as determined above, it should have the right to consider as PAP in accordance with the government policy;
 - 2.4 Any family or person lives in the village and / or has the family book after the cut-off-date as determined above, it should consider non-affected household or person by the project;
- Article 3: The RMU of PRLRC of NNP1PC, Hom and Thathom District Governors, Xaysomboun Province, Local authorities and NNP1PC, all disseminates the content of (this additional notice) to PAPs to know and understand deeply;
- Article 4: Any Notice or legislation issued before this and had the contradiction with the content of this additional notice, it should be cancelled and waived ;
- Article 5: this additional notice comes into effect and enforce since the signature

Xysomboun Province Governor

President of PRLRC of NNP1PC

Dr. Thongloy SILIVONG



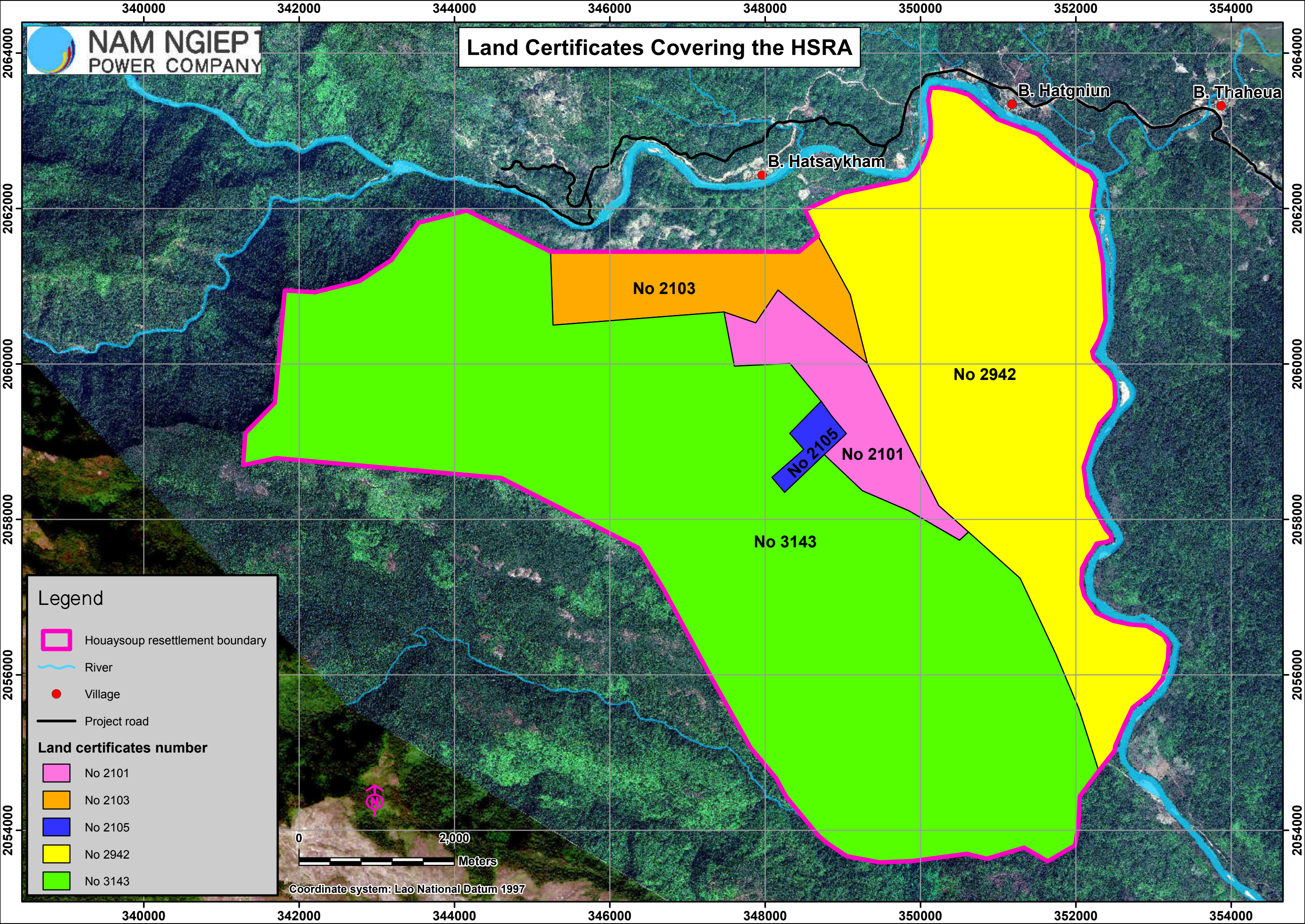

Note: unofficial translation

Annex E – Land title document for Houay Soup Resettlement Area





Land Certificates Covering the HSRA



Legend

-  Houaysoup resettlement boundary
-  River
-  Village
-  Project road

Land certificates number

-  No 2101
-  No 2103
-  No 2105
-  No 2942
-  No 3143



0 2,000
Meters

Coordinate system: Lao National Datum 1997



ສາທາລະນະລັດ ປະຊາທິປະໄຕ ປະຊາຊົນລາວ

ສັນຕິພາບ ເອກະລາດ ປະຊາທິປະໄຕ ເອກະພາບ ວັດທະນາຖາວອນ

ກະຊວງສື່ສານ ແລະ ສື່ງແອດລັອມ
ກົມຄຸ້ມຄອງສິ່ງແວດລ້ອມ

ແຜນທີ່ດິນລັດ

ເລກທີ: 2101 / ກຊສ.ກສດ

ຄຸ້ມຄອງນໍ້າໃຊ້ໂດຍ: ບໍລິສັດ ໂຟຟ້າບ້າງຽນ 1 ຈຳກັດ
ຕາມເອກະສານຢັ້ງຢືນ: ຂໍ້ຕົກລົງຂອງທ່ານລັດຖະມົນຕີວ່າການ ກະຊວງສື່ສານ ແລະ ສື່ງແອດລັອມ, ສະບັບເລກທີ 4466/ກຊສ.ລົງວັນທີ 31 ກໍລະກົດ 2015
ເພື່ອນໍາໃຊ້ເຂົ້າໃນເປົ້າໝາຍ: ປູກສັງ (ທີ່ຢູ່ອາໄສ)

ທີ່ຕັ້ງຂອງຕອນດິນ

ບຸກຄົນ: ບ້ານ ຫາດຍັນ (ຄຸ້ມຄອງຊາຍຄຳ)
ເມືອງ: ບໍລິຄັນ ແຂວງ: ບໍລິຄຳໄຊ
ໃບແຜນທີ່ຕາດິນເລກທີ: A 346-060, A 348-060... ຕອນດິນເລກທີ:
ຈຸດທີ່ຕັ້ງສິ່ງແວດລ້ອມດິນ: N 2059488.816, E 349172.640
ມາດຕາສ່ວນ: 1: 30 000 ເນື້ອທີ່ຂອງດິນ: 276 ເຮັກຕາ: 0000 ຕາແມັດ

ຕອນດິນຢູ່ໃນການຄຸ້ມຄອງຂອງບໍລິສັດ ໂຟຟ້າບ້າງຽນ 1 ຈຳກັດ



ອອກໃຫ້: _____ ນະຄອນຫຼວງວຽງຈັນ ວັນທີ: _____ ວັນທີ: 2 AUG 2015 ປີ: _____

ສຳເລັດໜ້າກົມຄຸ້ມຄອງສິ່ງແວດລ້ອມ

ຄຳເຫຼັກ ເພັດກິມມະສີ



ສາທາລະນະລັດ ປະຊາທິປະໄຕ ປະຊາຊົນລາວ

ສັນຕິພາບ ເອກະລາດ ປະຊາທິປະໄຕ ເອກະພາບ ວັດທະນາຖາວອນ

ກະຊວງຊັບສະຍາກອນທຳມະຊາດ ແລະ ສິ່ງແວດລ້ອມ
ກົມຄຸ້ມຄອງພື້ນທີ່

ແຜນທີ່ດິນລັດ

ທີ 2103 / ກຊສ.ກອດ
ເລກທີ: _____ / ກຊສ.ກອດ

ຄຸ້ມຄອງນໍ້າໄຮ້ໂດຍ: ບໍລິສັດ ໄຟຟ້ານໍ້າງຽບ 1 ຈຳກັດ
ຕາມເອກະສານບັງຄັບ: ຂໍ້ຕົກລົງຂອງສານລັດຖະມົນຕີວ່າການ ກະຊວງຊັບສະຍາກອນທຳມະຊາດ ແລະ
ສິ່ງແວດລ້ອມ, ສະບັບເລກທີ 4466/ກຊສ.ມົນຕີ ກະກຸມ 31 ກະກຸມ 2015
ເພື່ອນໍາໃຊ້ເຂົ້າໃນເປົ້າໝາຍ: ກະສິກໍາ (ປູກຕົ້ນໄມ້)

ທີ່ຕັ້ງຂອງຕອນດິນ

ຖະໜົນ: _____ ບ້ານ: ຫາດຍືນ (ເຄັມຫາດຊາຍຄຳ)
ເມືອງ: ບໍລິຄັນ _____ ແຂວງ: ບໍລິຄັນໄຊ
ໃບແຜນທີ່ຕາດິນເລກທີ: A 344-060, A 346-060, _____ ຕອນດິນເລກທີ: _____
ຈຸດທີ່ຕັ້ງພິກັດຕອນດິນ: N 2061025.550, E 347043.829
ມາດຕາສ່ວນ: 1: 30 000 ເນື້ອທີ່ຂອງດິນ: 330 ເຮັກຕາ: 0000 ຕາແມັດ

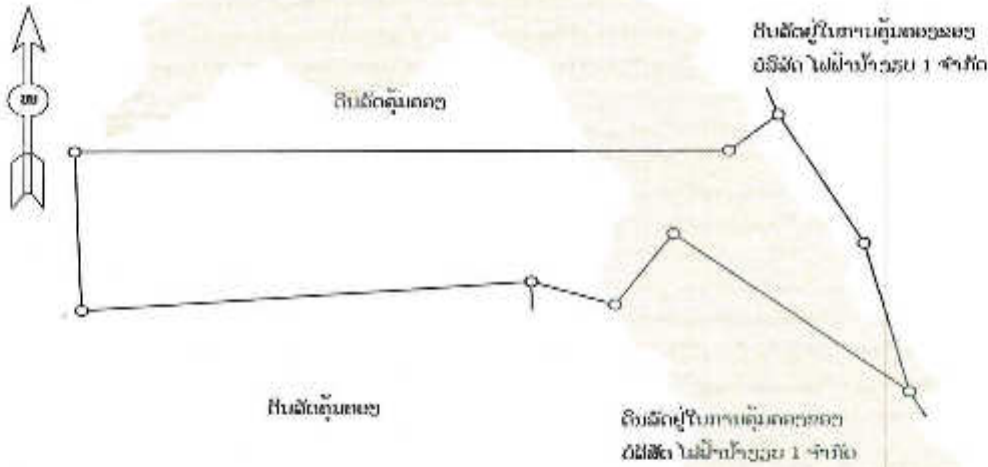

ອອນໃຫ້ທີ່: _____ ນະຄອນຫຼວງວຽງຈັນ ວັນທີ: _____ ເດືອນ: 12 AUG 2015 ປີ: _____



ຄຳເຫຼັກ ເພັດກິມມະສີ



ສາທາລະນະລັດ ຝະຊາທິປະໄຕ ຝະຊາຊົນລາວ
ສັນຕິພາບ ເອກະລາດ ຝະຊາທິປະໄຕ ເອກະພາບ ວັດທະນາຖາວອນ
ກະຊວງຊັບພະຍາກອນທຳມະຊາດ ແລະ ສິ່ງແວດລ້ອມ
ກົມຄຸ້ມຄອງທີ່ດິນ

ແຜນທີ່ດິນລັດ

ເລກທີ: 2105 / ກຊສ.ກສດ

ຄຸ້ມຄອງນໍາໃຊ້ໂດຍ: ບໍລິສັດ ໂຟຟ້າປ້າງຮຸບ 1 ຈຳກັດ
ຕາມເອກະສານຢັ້ງຢືນວິທີກວດກາຂອງການລັດຖະມົນຕີອໍານາດ ກະຊວງຊັບພະຍາກອນທຳມະຊາດ ແລະ
ສິ່ງແວດລ້ອມ, ຜະນິດເລກທີ 4466/ກຊສ.ວິນວັນທີ 31 ກໍລະກົດ 2015
ເພື່ອນໍາໃຊ້ເຂົ້າໃນເປົ້າໝາຍ: ປູກສົ່ງ (ເອ້ງວດັບນໍ້າເມື່ອຮູ້ມໃຊ້)

ທີ່ຕັ້ງຂອງຕອນດິນ { ຖະໜົນ: ບ້ານ ຫາດປື້ນ (ຄົມຫາດຊາຍຄໍ່າ)
ເມືອງ: ບໍລິຄັນ ແຂວງ: ບໍລິຄໍາໄຊ
ໃບແຜນທີ່ຕາດິນເລກທີ: A 348-058 ຕອນດິນເລກທີ:
ຈຸດທີ່ຕັ້ງພິກັດຕອນດິນ: N 2058992.565, E 348663.249
ມາດຕາສ່ວນ: 1: 10 000 ເນື້ອທີ່ຂອງດິນ: 42 ເຮັກຕາ: 0000 ຕາແມັດ

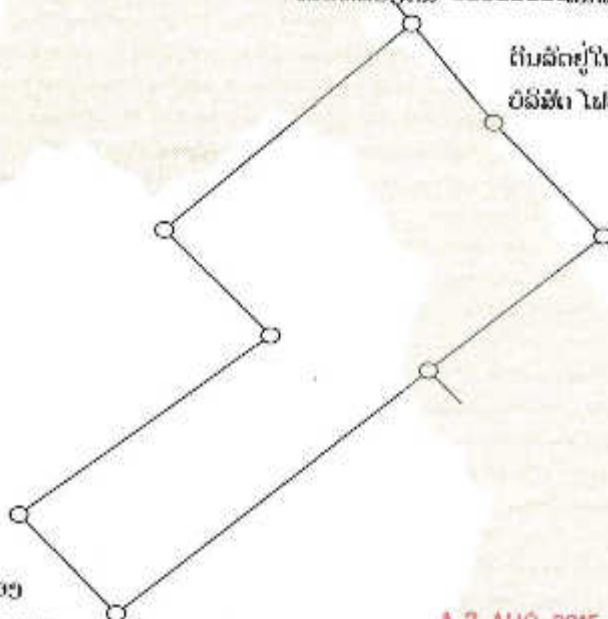

ດິນລັດຢູ່ໃນການຄຸ້ມຄອງຂອງ
ບໍລິສັດ ໂຟຟ້າປ້າງຮຸບ 1 ຈຳກັດ

ດິນລັດຄຸ້ມຄອງ

ອອກໃຫ້: ບະຄອນຫຼວງວຽງຈັນ ວັນທີ: 12 AUG 2015 ເດືອນ: ປີ:

ຫົວໜ້າກົມຄຸ້ມຄອງທີ່ດິນ



ຄໍາເຫັນ ເພີ່ມຕື່ມ



ສາທາລະນະລັດ ປະຊາທິປະໄຕ ປະຊາຊົນລາວ
ສັນຕິພາບ ເອກະລາດ ປະຊາທິປະໄຕ ເອກະພາບ ວັດທະນະຊາດອັນດຳເນີນ

ກະຊວງຊັບພະຍາກອນທຳມະຊາດ ແລະ ສິ່ງແວດລ້ອມ
ກົມຄຸ້ມຄອງທີ່ດິນ

ແຜນທີ່ດິນລັດ

ທີ 2942

ເລກທີ: / ກຊສ.ກຊດ

ຄຸ້ມຄອງນໍ້າໃຊ້ໃດຍ: ບໍລິສັດ ໄຟຟ້ານໍ້າງຽມ 1 ຈໍາກັດ
ຕາມເອກະສານຮຽງຮຽນ ຈື່ງຄຳລິງຂອງທ່ານ ວັດທະນິນ ທິວໍວາກາຍ ກຊສ ສະບັບເລກທີ 6423/ກຊສ.ວິກັບ
ທີ 10 ກັນຍາ 2014 ວ່າດ້ວຍການອະນຸຍາດທີ່ດິນລັດເພື່ອຜັບເຜັດຂອງຊັບການບົກບ້າຍຈັດສັນ ແລະ
ພົ້ນຜູ້ຊີວິດການເປັນຜູ້ຂອງປະຊາຊົນທີ່ໄດ້ຮັບຜົນກະທົບຈາກໂຄງການໃຊ້ນໍ້າເສື່ອມໄຟຟ້ານໍ້າງຽມ 1
ເພື່ອນໍ້າໃຊ້ເຂົ້າໃນຊຳພາຍ ຂອງບັນຍັດບ້າຍຈັດສັນ ແລະ ເພື່ອຜູ້ຊີວິດຄວນເປັນຜູ້ຂອງປະຊາຊົນ
ທີ່ໄດ້ຮັບຜົນກະທົບຈາກໂຄງການກໍ່ສ້າງເສື່ອມໄຟຟ້ານໍ້າງຽມ 1

ທີ່ຕັ້ງຂອງຕອນດິນ

ຕອນດິນ: _____ ບ້ານ: ສາດພິນ ທະບູນ
ເມືອງ: ບໍລິຄັນ ແຂວງ: ບໍລິຄັນ
ໃບເຜ່ຍທີ່ຕາດິນເລກທີ: A 348-062, A 348-069, A 350-067 ຕອນດິນເລກທີ: _____
ຈຸດທີ່ຕັ້ງໃຫ້ຕອນດິນ: N 2060058.117 E 351068.881
ມາດຕາລວມ: 1.88.000 ພື້ນທີ່ຂອງຕີນ: 1745 ເຮັກຕາ: 1385 ຕາເມັດ



19 SEP 2014

ອອກໃຫ້ສື່: ບະດອບທວງວຽງຈັນ ວັນທີ: _____ ຕີນ: _____ ອີ: _____

ຫົວໜ້າກົມຄຸ້ມຄອງທີ່ດິນ



ສິສິນດອນ ສິທາວິງ



ສາທາລະນະລັດ ປະຊາທິປະໄຕ ປະຊາຊົນລາວ

ສັນຕິພາບ ເອກະລາດ ປະຊາທິປະໄຕ ເອກະພາບ ວັດທະນາຖາວອນ

ກະຊວງຊັບພະຍາກອນທຳມະຊາດ ແລະ ສິ່ງແວດລ້ອມ
ກົມຄຸ້ມຄອງທີ່ດິນ

ແຜນທີ່ດິນລັດ

ເລກທີ: 3143 / ກຊສ.ກທດ

ຄຸ້ມຄອງນຳໃຊ້ໂດຍ: ບໍລິສັດ ໄຟຟ້ານ້ຳງຽບ 1 ຈຳກັດ
ຕາມເອກະສານທີ່ຍື່ນ: ຈົດກຳລັງຂອງຫານລັດຖະມົນຕີອາການ ກະຊວງຊັບພະຍາກອນທຳມະຊາດ ແລະ
ສິ່ງແວດລ້ອມ, ສະເພີ້ເລກທີ 7447/ກຊສ. ລົງວັນທີ 25 ທັນວາ 2015

ເນື້ອນຳໃຊ້ເຂົ້າໃນເກົ້າສາມາຍ: ບຸນເລເບີບປົກເອັກສາ ແລະ ເຂດສຳນາທານີນຂອງປະຊາຊົນທີ່ເຖິກຜົນ
ກະທົບຈາກໂຄງການເຂື່ອນໄຟຟ້ານ້ຳງຽບ 1

ທີ່ຕັ້ງຂອງຕອນດິນ

ຖະໜົນ: ບ້ານ ຫາດຍື່ນ (ອມຫາດຊາຍຄຳ)
ເມືອງ: ບໍລິຄັນ ແຂວງ: ບໍລິຄຳໄຊ
ໃບແຜນທີ່ຕາດິນເລກທີ: A 348-052, A 350-052, A 346-054... ຕອນດິນເລກທີ:
ຈຸດທີ່ຕັ້ງເມັດຕອນດິນ: N 2059360.162, E 346341.180
ມາດຕາສ່ວນ: 1: 100 000 ເນື້ອທີ່ຂອງດິນ: 3715 ເຮັກຕາ: 0872 ຕາແມັດ



ດິນຜ່າປ້ອງກັນແຫ່ງຊາດ
ແຫຼ່ງນ້ຳ: ສອຍ-ນ້ຳເບີກ

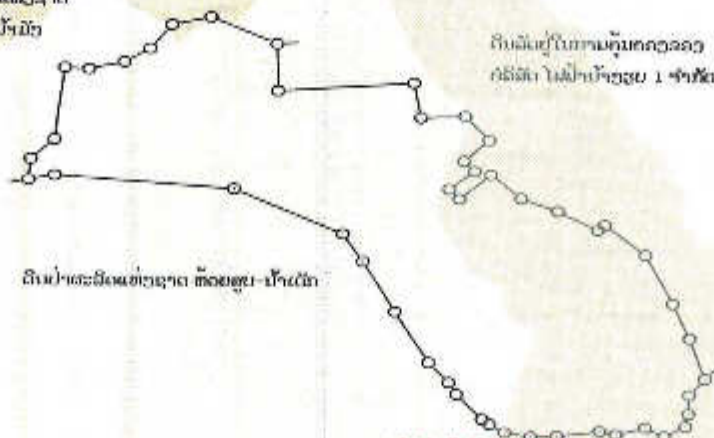

ດິນລັດຢູ່ໃນການຄຸ້ມຄອງຂອງ
ບໍລິສັດ ໄຟຟ້ານ້ຳງຽບ 1 ຈຳກັດ

ດິນຜ່າຜະລິດແຫ່ງຊາດ ຫ້ວຍສອຍ-ນ້ຳເບີກ

ອອກໃຫ້: ນະຄອນຫຼວງວຽງຈັນ ວັນທີ: 25 DEC 2015 ເດືອນ: ມີ:

ສ.ສ.ກ ທິວທຳກົມຄຸ້ມຄອງທີ່ດິນ



ຄຳເຫຼັກ ເພັດກິມມະສີ



Lao People's Democratic Republic

Peace Independence Democratic Unity Prosperity

Ministry of Natural Resources and Environment

Department of Land Administration

Ref. N° 2101 / MoNRE.DoLA.

(Category) State Land Map

Used and managed by: Nam Ngiep 1 Hydropower company Limited (the NNP1)

In reference to certification document: Agreement of Minister of Ministry of Natural Resources and Environment, Ref.N°. 4466/MoNRE, dated 31 July 2015.

Use purpose of land: Building (Accommodation)

Road: Village: **Hat Gniun (Khum Hatsaykham)**

District: **Bolikhan** Province: **Bolikhamsay**

Land map Ref.N°: A 346-060, A348-060 Land plot N°

Coordinate reference point: N 2059488.816, E 349172.640

Map scale: 1:30 000 Land area: 276 ha: 0000 m²

Land Location

State land used by: the NNP1

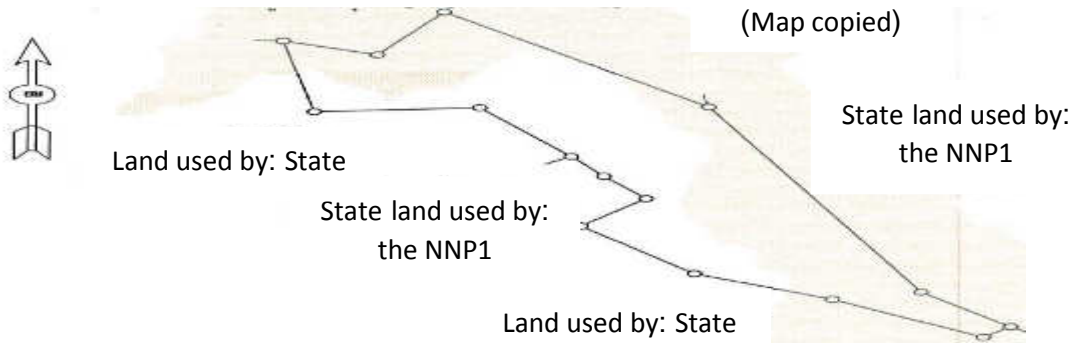

Issued in Vientiane Capital, date 12 Aug 2015

Deputy Head Land Administration Department

Stamped and signed

Khamlek Phetkommalee



Lao People's Democratic Republic

Peace Independence Democratic Unity Prosperity

Ministry of Natural Resources and Environment

Department of Land Administration

Ref. N° 2103 / MoNRE.DoLA.

(Category) State Land Map

Used and managed by: Nam Ngiep 1 Hydropower company Limited (the NNP1)

In reference to certification document: Agreement of Minister of Ministry of Natural Resources and Environment, ref.N° 4466/ MoNRE, dated 31 July 2015.

Use purpose of land: Agriculture (Plantation)

Land Location

Road: Village: **Hat Gniun (Khum Hatsaykham)**

District: **Bolikhan** Province: **Bolikhamstay**

Land map ref. N°: A 344-060, A 346-060 Land plot N°.....

Coordinate reference point: N 2061025.550, E 347043.829

Map scale: 1:30 000 Land area: 330 ha: 0000 m²

(Map copied)

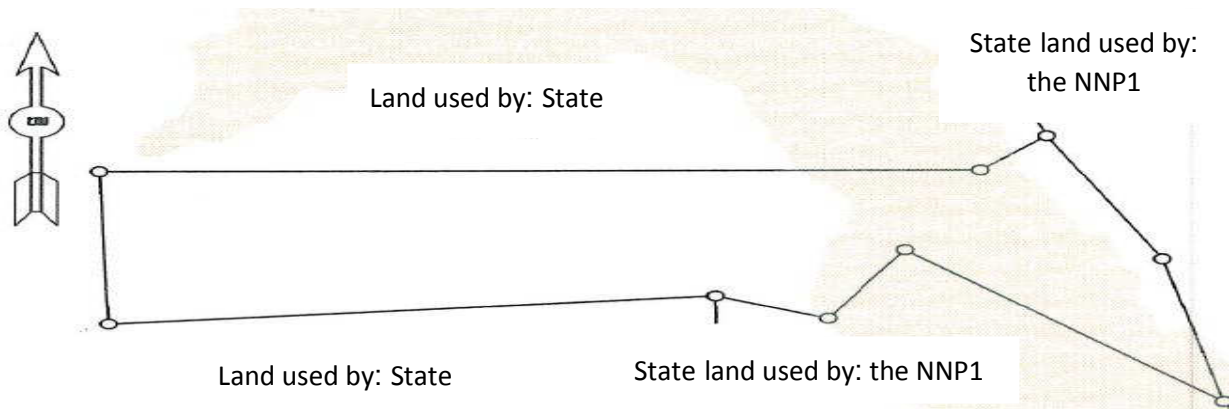

Issued at Vientiane Capital, date 12 Aug 2015

Deputy Head Land Administration Department

Stamped and signed

Khamlek Phetkommalee



Lao People's Democratic Republic

Peace Independence Democratic Unity Prosperity

Ministry of Natural Resources and Environment

Department of Land Administration

Ref. 2105 /MoNRE.DoLA.

(Category) State Land Map

Used and managed by: Nam Ngiep 1 Hydropower company Limited (the NNP1)

In reference to certification document: Agreement of Minister of Ministry of Natural Resources and Environment, Ref.N° 4466/ MoNRE, dated 31 July 2015.

Use purpose of land: Construction (Watershed for use)

Land Location

Road: Village: **Hat Gniun (Khum Hatsaykham)**

District: **Bolikhan**

Province: **Bolikhamstay**

Land map ref. N°: A 348-058

Land plot N°

Coordinate reference point: N 2058992.565, E 348663.249

Map scale: 1:10 000

Land area: 42

ha: 0000 m²

(Map copied)

State land used by:
the NNP1

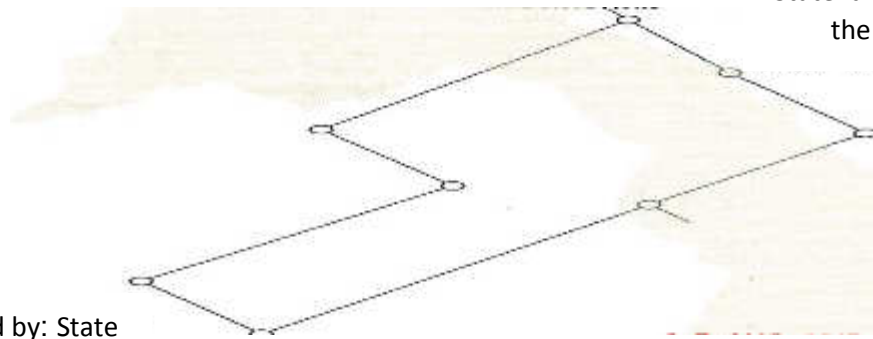

Land used by: State

Issued at Vientiane Capital, date 12 Aug 2015

Deputy Head Land Administration Department

Stamped and signed

Khamlek Phetkommalee



Lao People's Democratic Republic

Peace Independence Democratic Unity Prosperity

Ministry of Natural Resources and Environment

Department of Land Administration

Ref.N° 2942 / MoNRE.DoLA.

(Category) State Land Map

Used and managed by: Nam Ngiep 1 Hydropower company Limited (the NNP1)

In reference to certification document: Agreement of Minister of Ministry of Natural Resource and Environment, ref. N° 6423/MoNRE, dated 10 Sep 2014 on State Land Approval for Resettlement and livelihood of the project affected people from the NNP1

Use purpose of land: Building (Accommodation)

Land Location

Road: Village: **Hat Gniun + Someun**

District: **Bolikhan** Province: **Bolikhamsay**

Land map ref.: A 348-062, A348-060, A 350-062 Land plot N°

Coordinate reference point: N 2060058.117, E 351068.881

Map scale: 1:80 000 Land area: 1745 ha: (and) 1385 m² (Map copied)

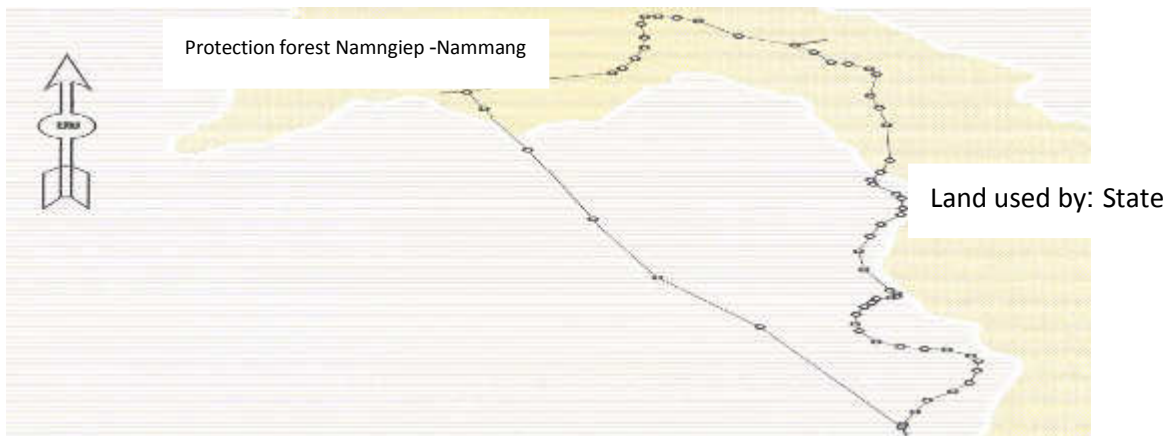

Issued at Vientiane Capital, date 19 SEP 2014

Deputy Head Land Administration Department

Stamped and signed

Siphandone SIHAVONG



Lao People's Democratic Republic

Peace Independence Democratic Unity Prosperity

Ministry of Natural Resources and Environment

Department of Land Administration

Ref.N° 3143 / MoNRE.DoLA.

(Category) State Land Map

Used and managed by: Nam Ngiep 1 Hydropower company Limited (the NNP1)

In reference to certification document: Agreement of Minister of Ministry of Natural Resources and Environment, Ref.N° 7447/ MoNRE, dated 25 Dec 2015.

Use purpose of land: Protection zone and living of the Project affected people from the NNP1.

Land Location

Road: Village: **Hat Gniun (Khum Hatsaykham)**
 District: **Bolikhan** Province: **Bolikhamstay**
 Land map ref. N°: A 348-052, A350-052, A 346-054 Land plot N°.....
 Coordinate reference point: N 2059360.162, E 346341.180
 Map scale: 1:10 000 Land area: 3715 ha: (and) 0872 m²

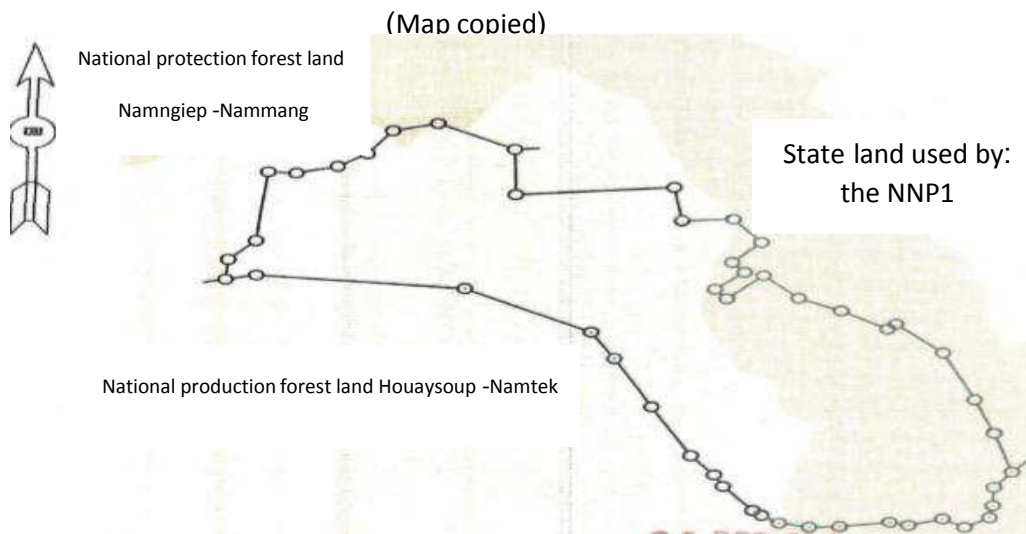

Issued at Vientiane Capital, date 25 Dec 2015

Deputy Head Land Administration Department

Stamped and signed

Khamlek Phetkommalee

Annex F

Self-Resettlement Plan Format

The following document is the English version of the forms and documents used to support a household with the preparation of their self-resettlement, through the structured preparation of a Self-Resettlement Plan. Several documents are existing standard GOL documents, while others are created specifically for the project purpose.

Staff from the company and district will support the household with the preparation of the Self Resettlement Plan.

Based on the principle of adaptive management, the Self Resettlement Plan prepared by each PAP may differ from the outline below, but is expected to follow the principles captured in the documents.

For actual use by the PAPs, Lao language documents will be used.

Self-Resettlement Plan

Family ID: 0001

Contents

1.	Household information	2
2.	Assets in current location and compensation Value.....	2
3.	Relocation support	2
4.	Reason for self-resettling	3
5.	Destination of self-resettlement	4
6.	Facilities available at new location	4
7.	House at new location	5
8.	Plan for physical relocation.....	5
9.	List of NNP1 Supported Livelihood Activities involved in at current location since 2014 until ..	6
10.	Planned land assets owned after relocation.....	6
11.	Self-Estimated Annual household income (including consumption).....	6
12.	If the family has children of school going age, plan for education of children.....	7
13.	Family Health Information	7
14.	Planned use of compensation funds.....	8
15.	Supporting documents:.....	9

Attached documents:

No	Document	Attached (Y/N/NA)
SRP-02	Copy of Final Choice on resettlement	
SRP-03	Certificate of employment if GOL staff	
SRP-04	A) Request moving out from old village B) Approval of moving out from old village	
SRP-05	Request moving in to new village	
SRP-06	Acceptance of living in new village.	
SRP-07	Public facilities list in the new village signed by Village Chief	
SRP-08	Proof of land ownership at new village	
SRP-09	Agreement to purchase land at new village	
SRP-10	Land title of housing land including house	
SRP-11	DAFO approval of moving Wood	
SRP-12	Livelihood Activity Plan	
SRP-13	DAFO approval of moving Livestock	
SRP-14	School acceptance form in new village.	
SRP-15	Vulnerable HH support request from HH to Project	
SRP-16	House floor plan design sketch	
SRP-17	Compensation expenditure Plan	
SRP-18	Request letter requesting approval of Self-Resettlement Plan by RMU	

ບໍລິສັດ ໄຟຟ້ານໍ້າງຽບ1 ຈຳກັດ

Nam Ngiep1 Power Company

 ເຮືອນເລກທີ (House No): 236, ໜ່ວຍ (Unit): 16, ບ້ານໂພນສິນວນ (Phonsinuan Village), ເມືອງສີສັດຕະນາກ (Sisattanak District),
ນະຄອນຫຼວງວຽງຈັນ, (Vientiane Capital) ໂທລະສັບ (Telephone): +85621261251, ແຟັກ (Fax): +85621261252

SRP-01

ການວາງແຜນຍົກຍ້າຍດ້ວຍຕົນເອງ /Self-Resettlement Plan

I.1. ມູນທົ່ວໄປກ່ຽວກັບຄົວເຮືອນ /Household information

ຊື່ຫົວໜ້າຄົວເຮືອນຊາຍ /Male HoHH Name:

ຊື່ຫົວໜ້າຄົວເຮືອນຍິງ /Female HoHH Name

 ໜ່ວຍ/Unit: **1**

 ເຮືອນເລກທີ/HouseNo **34**

 ປຶ້ມສຳມະໂນຄົວເລກທີ /FBookNo: **34**

 ອອກວັນທີ /IssueDate:**19/10/2007**

 ບ້ານ/Village: **ຫ້ວຍປາມ້ອມ /Houaypamom**

 ເມືອງ/District: **ຮົ່ມ /Hom**

 ແຂວງ/Province: **ໄຊສົມບູນ /Xaysomboun**

ຫົວໜ້າຄອບຄົວ(ຊາຍ) -Male Head of Household



ຫົວໜ້າຄອບຄົວ(ຍິງ) -Female Head of Household

I.2. ສະມາຊິກຄົວເຮືອນ /Member in Household

ລ/ດ No.	ລ/ຫຄົນ P.ID	ລາຍຊື່ຜູ້ຖືກກະທົບ PAP Name	ວ.ດ.ປເກີດ DOB	ເພດ Sex	ສະຖານະ Status	ສາຍສຳພັນ Relative	ອາຊີບ Occupation	ໄດ້ສິດ? Elig.?	ຮູບພາບ Photo
1	01816		20/10/1974	ຜູ້ຊາຍ Male	ຍັງຢູ່ Present	ຫົວໜ້າຄອບຄົວ Head of Household	ຊາວສວນ Farmer	ໄດ້/Yes	
2	01817		02/03/1976	ຜູ້ຍິງ Female	ຍັງຢູ່ Present	ຫົວໜ້າຄອບຄົວ Head of Household	ຊາວສວນ Farmer	ໄດ້/Yes	
3	01822		18/09/1977	ຜູ້ຍິງ Female	ຍັງຢູ່ Present	ເມຍ Wife	ຊາວສວນ Farmer	ໄດ້/Yes	
4	01818		04/06/2004	ຜູ້ຊາຍ Male	ຍັງຢູ່ Present	ລູກຊາຍ Son	ນັກຮຽນ Student	ໄດ້/Yes	
5	01819		10/05/2006	ຜູ້ຊາຍ Male	ຍັງຢູ່ Present	ລູກຊາຍ Son	ນັກຮຽນ Student	ໄດ້/Yes	
6	01823		11/03/2006	ຜູ້ຍິງ Female	ຍັງຢູ່ Present	ລູກສາວ Daughter	ນັກຮຽນ Student	ໄດ້/Yes	

ລ/ດ No.	ລ/ທຄົນ P.ID	ລາຍຊື່ຜູ້ຖືກກະທົບ PAP Name	ວ.ດ.ປເກີດ DOB	ເພດ Sex	ສະຖານະ Status	ສາຍສໍາພັນ Relative	ອາຊີບ Occupation	ໄດ້ສິດ? Elig.?	ຮູບພາບ Photo
7	01824		15/05/2008	ຜູ້ຊາຍ Male	ຍັງຢູ່ Present	ລູກຊາຍ Son	ນັກຮຽນ Student	ໄດ້/Yes	
8	01820		06/01/2010	ຜູ້ຍິງ Female	ຍັງຢູ່ Present	ລູກສາວ Daughter	ອື່ນໆ Other	ໄດ້/Yes	
9	01821		01/09/2011	ຜູ້ຍິງ Female	ຍັງຢູ່ Present	ລູກສາວ Daughter	ອື່ນໆ Other	ໄດ້/Yes	
10	01825		06/05/2013	ຜູ້ຍິງ Female	ຍັງຢູ່ Present	ລູກສາວ Daughter	ອື່ນໆ Other	ໄດ້/Yes	
11	36556		20/06/2016	ຜູ້ຍິງ Female	ຍັງຢູ່ Present	ລູກສາວ Daughter	ອື່ນໆ Other	ບໍ່ໄດ້/No	
12	36555		01/05/2016	ຜູ້ຍິງ Female	ຍັງຢູ່ Present	ລູກສາວ Daughter	ອື່ນໆ Other	ບໍ່ໄດ້/No	

II. ຊັບສິນທີ່ມີໃນປະຈຸບັນ ແລະ ມູນຄ່າການຊົດເຊີຍ /Assets in current location and compensation Value

ລດ No	ປະເພດດິນ/ Land Type	ລະຫັດດິນ/ Land ID	ລາຄາ/ Rate (kip)	ເນື້ອທີ່ດິນໃນອ່າງ(m2) / AreaInsideReservoir	ເນື້ອທີ່ດິນນອກອ່າງ ຈະນໍາໃຊ້ບໍ່?(m2) Area Outside Reservoir will Use?	ມູນຄ່າຊົດເຊີຍດິນໃນອ່າງ AmountInsideReservoir	ລວມມູນຄ່າຊົດເຊີຍດິນ/ TotalAmountCompen. (ກີບ/Kip)
				ເນື້ອທີ່ດິນນອກອ່າງ(m2) AreaOutsideReservoir	ຈະນໍາໃຊ້/Will Use?	ມູນຄ່າຊົດເຊີຍດິນໃນອ່າງ AmountOutsideReservoir	
1	ດິນສວນ Garden land	0200111	4,000	0		0	0
				4,509	ຈະນໍາໃຊ້/Will Use	0	
2	ດິນປຸກສ້າງ Residential/Housing land	0200103	24,000	1,355		32,520,000	32,520,000
				0	ຈະບໍ່ໃຊ້/No use	0	
3	ດິນສວນ Garden land	0200104	4,000	1,226		4,904,000	4,904,000
				0	ຈະບໍ່ໃຊ້/No use	0	
4	ດິນປຸກສ້າງ Residential/Housing land	0200101	24,000	1,127		27,048,000	27,048,000
				0	ຈະບໍ່ໃຊ້/No use	0	
5	ດິນປຸກສ້າງ Residential/Housing land	0200105	24,000	1,675		40,200,000	40,200,000
				0	ຈະບໍ່ໃຊ້/No use	0	
6	ດິນໄຮ່ 1-3 ປີ ຢູ່ເຂດໄຊສົມບູນ Rotational shifting cultivation 1-3 years for XSB area	0200106	500	0		0	0
				12,420	ຈະນໍາໃຊ້/Will Use	0	
7	ດິນສວນບໍ່ໄດ້ບົວລະບັດແບບຕໍ່ເນື່ອງ Fallow Garden land	0200107	0	0		0	0
				10,573	ຈະນໍາໃຊ້/Will Use	0	
8	ດິນໄຮ່ 1-3 ປີ ຢູ່ເຂດໄຊສົມບູນ Rotational shifting cultivation 1-3 years for XSB area	0200108	500	5,275		2,637,500	4,476,500
				3,678	ຈະບໍ່ໃຊ້/No use	1,839,000	
9	ດິນປຸກສ້າງ Residential/Housing land	0200102	24,000	1,926		46,224,000	46,224,000
				0	ຈະບໍ່ໃຊ້/No use	0	
10	ດິນສວນປູກໄມ້ອຸດສາຫະກຳ Garden land for industrial plantation	0200110	3,000	2,540		7,620,000	7,620,000
				0	ຈະບໍ່ໃຊ້/No use	0	

ລດ No	ປະເພດດິນ/ Land Type	ລະຫັດດິນ/ Land ID	ລາຄາ/ Rate (kip)	ເນື້ອທີ່ດິນໃນອ່າງ(m2) / AreaInsideReservoir	ເນື້ອທີ່ດິນນອກອ່າງ ຈະນໍາໃຊ້ບໍ່?(m2) Area Outside Reservoir will Use?	ມູນຄ່າຊົດເຊີຍດິນໃນອ່າງ AmountInsideReservoir	ລວມມູນຄ່າຊົດເຊີຍດິນ/ TotalAmountCompen. (ກີບ/Kip)
				ເນື້ອທີ່ດິນນອກອ່າງ(m2) AreaOutsideReservoir		ມູນຄ່າຊົດເຊີຍດິນໃນອ່າງ AmountOutsideReservoir	
11	ດິນສວນ Garden land	0200114	4,000	2,125		8,500,000	8,500,000
				0	ຈະບໍ່ໃຊ້/No use	0	
12	ດິນສວນບໍ່ໄດ້ບົວລະບັດແບບຕໍ່ເນື່ອງ Fallow Garden land	0200115	0	0		0	0
				2,073	ຈະນໍາໃຊ້/Will Use	0	
13	ດິນໄສ່ 1-3 ປີ ຢູ່ເຂດໄຊສົມບູນ Rotational shifting cultivation 1-3 years for XSB area	0200116	500	0		0	0
				12,122	ຈະນໍາໃຊ້/Will Use	0	
14	ດິນໄສ່ 1-3 ປີ ຢູ່ເຂດໄຊສົມບູນ Rotational shifting cultivation 1-3 years for XSB area	0200117	500	0		0	0
				10,025	ຈະນໍາໃຊ້/Will Use	0	
15	ດິນຄັງສັດບໍ່ໄດ້ຮັບການພັດທະນາ Pasture land	0200118	600	23,842		14,305,200	18,696,600
				7,319	ຈະບໍ່ໃຊ້/No use	4,391,400	
16	ດິນຄັງສັດບໍ່ໄດ້ຮັບການພັດທະນາ Pasture land	0200119	600	18,696		11,217,600	27,000,600
				26,305	ຈະບໍ່ໃຊ້/No use	15,783,000	
17	ດິນສວນ Garden land	0200112	4,000	0		0	0
				11,453	ຈະນໍາໃຊ້/Will Use	0	
18	ດິນໄສ່ 1-3 ປີ ຢູ່ເຂດໄຊສົມບູນ Rotational shifting cultivation 1-3 years for XSB area	0200113	500	7,148		3,574,000	7,210,000
				7,272	ຈະບໍ່ໃຊ້/No use	3,636,000	
19	ດິນສວນ Garden land	0200109	4,000	3,458		13,832,000	56,100,000
				10,567	ຈະບໍ່ໃຊ້/No use	42,268,000	
ລວມມູນຄ່າການຊົດເຊີຍດິນ /Total Amount compensation (ກີບ/LAK):							280,499,700

II.2. ມູນຄ່າຊົດເຊີຍສິ່ງປຸກສ້າງ /Assets Structure Compensation Value

ລດ No	ປະເພດດິນ/ Land Type	ລະຫັດສິ່ງປຸກສ້າງ/ Structure_ID	ເນື້ອທີ່/ Area(m2)	ມູນຄ່າວັດສະດຸ / MaterialValue(ກີບ)	ມູນຄ່າແຮງງານ / Labour Value(ກີບ)	ມູນຄ່າເຄື່ອງມື /Tools Value (ກີບ)	ລວມມູນຄ່າຊົດເຊີຍ/ TotalAmount. (ກີບ/Kip)	ໝາຍເຫດ/ Remark
1	ເຮືອນຄົວ /Kitchen	02001_02_S	48.80	19,303,789	8,228,400	550,644	28,082,833	ເຮືອນຄົວ1
2	ເຮືອນ /House	02001_01_S	24.00	18,490,757	4,494,000	459,695	23,444,452	ເຮືອນ1
3	ຖຽງນາ /Ricefield hut	02001_15_S	7.04	608,294	422,250	20,611	1,051,155	ຖຽງນາ3
4	ອື່ນໆ /Other	02001_06_S	1.60	534,406	123,038	13,149	670,593	ຮ້ານຫອມ1
5	ອື່ນໆ /Other	02001_05_S	27.00	670,857	82,025	15,058	767,940	ຮ້ານພື້ນ1
6	ຄອກສັດປີກ /Poultry pen	02001_04_S	1.80	1,138,264	86,921	24,504	1,249,689	ຄອກໄກ່1
7	ຄອກສັດນ້ອຍ /Animal pen	02001_03_S	6.00	1,710,132	82,025	35,843	1,828,000	ຄອກໝູ
8	ເຮືອນ /House	02001_08_S	51.80	19,545,096	6,546,000	521,822	26,612,918	ເຮືອນ3
9	ເຮືອນ /House	02001_07_S	41.00	15,776,551	6,160,400	438,739	22,375,690	ເຮືອນ2
10	ຖຽງນາ /Ricefield hut	02001_14_S	6.90	256,790	542,250	15,981	815,021	ຖຽງນາ2
11	ຖຽງນາ /Ricefield hut	02001_13_S	6.90	799,656	182,250	19,638	1,001,544	ຖຽງນາ1
12	ອື່ນໆ /Other	02001_12_S	2.00	515,925	82,025	11,959	609,909	ຮ້ານຫອມ
13	ອື່ນໆ /Other	02001_11_S	2.80	359,400	82,025	8,829	450,254	ຮ້ານພື້ນ2
14	ຄອກສັດປີກ /Poultry pen	02001_10_S	1.21	605,811	82,025	13,757	701,593	ຄອກໄກ່2
15	ເຮືອນຄົວ /Kitchen	02001_09_S	21.00	5,267,491	1,644,863	138,247	7,050,601	ເຮືອນຄົວ2
ລວມມູນຄ່າການຊົດເຊີຍດິນ /Total Amount compensation (ກີບ/LAK):							116,712,192	

III. ການຊ່ວຍເຫລືອສະໜັບສະໜຸນ /Relocation support
III.1 ການຊ່ວຍເຫລືອສະໜັບສະໜຸນສະບຽງອາຫານ /Food support

ລ/ດ No	ລາຍການ /List	ຫົວໜ່ວຍ/ Unit	ຈຳນວນ/ຄົນ/3ເດືອນ /Qty/Psn/3Mon.	ລາຄາ/ Rate	ຈ/ນຄົນທີ່ໄດ້ສິດ /Elig.Psn	ລວມມູນຄ່າ ກີບ /Amount (LAK)
1	ນ້ຳມັນພືດ /Cooking Oil	ລິດ/litre	0.5	10,000	10	50,000
2	ເກືອໄອໂອດິນ /Salt	ກິໂລ/kg	1	4,000	10	40,000
3	ຫມາກເຜັດແຫ້ງ /Dry Chilly	ກິໂລ/kg	0.1	35,000	10	35,000
4	ນ້ຳຕານ /Sugar	ກິໂລ/kg	0.2	10,000	10	20,000
5	ຖົ່ວເຫລືອງແຫ້ງ /Peanuts	ກິໂລ/kg	7	10,000	10	700,000
6	ໄຂ່ໄກ່ /Egg	ຫນ່ວຍ/ Unit	92	1,000	10	920,000
7	ຊີ້ນຫມູແຫ້ງ /Dry pork	ກິໂລ/kg	1	200,000	10	2,000,000
8	ເຂົ້າສານ ອາຍຸຕໍ່າກ່ວາ 15ປີ /Rice for people <15 years	ກິໂລ/kg	45	6,500	7	2,047,500
9	ເຂົ້າສານ ອາຍຸ 15ປີ ຂຶ້ນໄປ /Rice for people >15 years	ກິໂລ/kg	63	6,500	3	1,228,500
ລວມມູນຄ່າທັງໝົດ /Total Amount (ກີບ /LAK):						7,041,000

III.2 ການຊ່ວຍເຫລືອສະໜັບສະໜຸນຄ່ານ້ຳ, ໄຟຟ້າ ແລະ ຂີ້ເຫຍື້ອ /Water, Electricity, and Garbage fees

ລ/ດ No	ລາຍການ /List	ຫົວໜ່ວຍ /Unit	ລາຄາ/ເດືອນ/ຄົວເຮືອນ /Rate/Mon/HH	ຈຳນວນເດືອນ /TotalMonth	ລວມມູນຄ່າ (ກີບ) /Amount (LAK)
1	ໄຟຟ້າ /Electricity fee		50,000	3	150,000
2	ນ້ຳ /Water fee		20,000	3	60,000
3	ອະນາໄມຂີ້ເຫຍື້ອ /Garbage fee		10,000	3	30,000
4	ຄ່າມ້າງສົ່ງປຸກສ້າງຫລັກ+ຂົນຂັ້ນ+ລົງລົດ /Dismantling + loading+unloading to trucks fee				7,699,000
ລວມມູນຄ່າທັງໝົດ /Total Amount (ກີບ /LAK):					7,939,000

ລວມມູນຄ່າຊົດເຊີຍທັງໝົດ/Grand Total Compensation Value (II+III) ກີບ/LAK:	412,191,892
--	--------------------

4. Reason for self-resettling

Tic applicable criteria	Criteria
	<p>i. A Project Affected Household will move close to relatives. In this case, the request has to be accompanied by a letter of these relatives, acknowledged and stamped by the relevant village authorities, stating that these relatives will accept into the village the people of the Project Affected Household and can prove their capacity to do so by providing a statement of their livelihood;</p>
	<p>ii. The Project Affected Household can provide either :</p> <ul style="list-style-type: none"> a. a pre-agreement on land acquisition in an area other than the resettlement site sufficient to re-establish a livelihood that is at least above the National Poverty Line OR b. one or several working contract(s) of at least 10 months of duration with a (combined) salary high enough to support the applicant's family (benchmark is the National Poverty Line) OR c. sufficient capital and a business plan to start a business that has the potential to support the applicant's family (benchmark is the National Poverty Line) OR d. retirement using annual interest payments from their capital in a fixed-term-deposit account to support the applicant's family (benchmark is the National Poverty Line)
	<p>iii. Members of the requesting PAP may be Civil Servants in the District of Origin and are requested via a written document by the relevant District Governor to continue their service in the district and therefore resettle in a community of the District of Origin. A copy of the letter needs to be provided to the Project.</p>
	<p>iv. Any other proof that full cash compensation will likely not disrupt the family's livelihood but allow an improvement. The PRLRC will assess the supporting documents and make a case-by-case decision based on data obtained by the Confirmation Survey and the document provided by the PAP and/or if relevant by third parties.</p>

5. Destination of self-resettlement

The destination of the self-resettlement is to:

No.	Item	
5.1	Province name	
5.2	District name	
5.3	Village cluster (khoumbaan)	
5.4	Village name	
5.5	Unit number	

6. Facilities available at new location

No	Facility	At new location
6.1	Electricity	<ol style="list-style-type: none">1. Grid2. No grid
6.2	Water supply	<ol style="list-style-type: none">1. No improved water supply2. Public well, GFS tap stand3. Nampapa with household connection
6.3	Road access	<ol style="list-style-type: none">1. None2. Dirt road with only dry season access3. Dirt road with all year round4. Paved road
6.4	Distance from new house to the nearest market (km)	
6.5	Distance from new house to the nearest primary school (km)	
6.6	Distance from new house to the nearest secondary school (km)	
6.7	Distance from new house to the nearest health centre (km)	
6.8	Distance from new house to the nearest district town (km)	

7. House at new location

No	Item	At new location
7.1	Way to organize new house	<ol style="list-style-type: none"> 1. Move in with relative 2. Buy existing house 3. Buy existing house and expand/renovate it. 4. Build new house
7.2	Style of new house	<ol style="list-style-type: none"> 1. Hmong style villa on the ground 2. Laoloum style house 3. Two story house
7.3	Floor size of the new house (m2)m2
7.4	Roofing materials	<ol style="list-style-type: none"> 1. Grass/bamboo/wood 2. Correlated iron 3. Tile
7.5	Wall materials	<ol style="list-style-type: none"> a. Bamboo b. Wood c. Brik/stone/cement block
7.6	Floor materials	<ol style="list-style-type: none"> I. Earth II. Wood III. Cement/tile
7.7	Toilet	Yes / No

8. Plan for physical relocation

No	Item	
8.1	Planned date for moving	
8.2	Estimated distance to new location (km)(km)
8.3	Do you want the project to arrange the dismantling of your house or do you prefer to do it by yourself and be paid for this dismantling?	
8.4	Do you want the project to arrange the moving of your household goods or do it by yourself be reimbursed for this transportation?	
When arranging their own transportation:		
8.5	Type of truck for moving household goods and assets, animals	
8.6	Estimated number of trucks needed for moving household goods and assetsTrucks
8.7	Source of truck	<ol style="list-style-type: none"> 1. Self owned 2. Renting
8.8	Estimated cost for transportation (LAK)Kip

9. List of NNP1 Supported Livelihood Activities involved in at current location since 2014 until

No	NNP1 Promoted Livelihood Activity the family is or has participated in.	Start date of LRA	Is LRA currently still ongoing by themselves (Y/N)	Level of success of LRA (self-assessment (0-10 max))
9.1	Fish raising			
9.2	Rice			
9.3	Chicken			
9.4	Mushroom			
9.5	Forage			
9.6	Vegetable growing			
9.7	Animal vaccination			
9.8	Others, specify			

10. Planned land assets owned after relocation

No	Land type	Location 1. Old village, still owned 2. New location	Size (m2)	Is land documentation available
10.1				
10.2				
10.3				

11. Self-Estimated Annual household income (including consumption).

No	Source of income	Estimated Value of current annual income in KIP	% of total annual income	Estimated Value of annual income after resettlement (LAK)	% of total annual income
11.1	Agriculture				
11.2	Fishing				
11.3	Employment				
11.4	Business				
11.5	Forest products				
11.6	Livestock				
11.7	Hunting				
11.8	Others (interest)				
11.9	Total				

12. If the family has children of school going age, plan for education of children.

No	Item	
12.1	How many children in the family are in Primary school?	
12.2	How many children in the family are in Secondary school?	
12.3	Name of primary school the children go to?	
12.4	Name of secondary school the children go to?	
12.5	When will the children transfer from existing school to new school	

13. Family Health Information

No	Issue	
13.1	Number of people in the HH living with disability	
13.2	Special consideration the HH is planning during relocation for people in the HH living with disability	
13.3	Number of people in the HH living with special needs	
13.4	Special consideration the HH is planning during relocation for special needs	
13.5	Number of pregnant women in the HH	
13.6	Special consideration the HH is planning during relocation for pregnant women	
13.7	Number of children aged 0-2 year in the family	
13.8	Special consideration the HH is planning during relocation for children aged 0-2 year in the family	
13.9	Number of children in the family	
13.10	Number of children fully vaccinated according to GOL vaccination program for their age?	

14. Planned use of compensation funds

Total amount of compensation funds (LAK): _____

No	Category	Total (LAK)	Schedule of expenditure (LAK per quarter)				
			Q4/2016	Q1/2017	Q2/2017	Q3/2017	Q4/2017
14.1	Moving to new location						
14.2	New house						
14.3	General Living cost						
14.4	Land purchases						
14.5	Land development / change of land type						
14.6	Investment in Livelihood activity other than land purchasing						
14.7	Bank deposit and savings						
14.8	Purchase Car/ Truck						
14.9	Purchase motorbike						
14.10	Purchase Household goods and electrical items.						
14.11	Pay off debt						
14.12	Invest in business						
14.13	Others, specify:						
14.14	Others, specify:						
14.15	Others, specify:						

15. Supporting documents:

No	Document	Attached (Y/N/NA)
SRP - 02	Copy of Final Choice on resettlement	
SRP-03	Certificate of employment if GOL staff	
SRP-04	C) Request moving out from old village D) Approval of moving out from old village	
SRP-05	Request moving in to new village	
SRP-06	Acceptance of living in new village.	
SRP-07	Public facilities list in the new village signed by Village Chief	
SRP-08	Proof of land ownership at new village	
SRP-09	Agreement to purchase land at new village	
SRP-10	Land title of housing land including house	
SRP-11	DAFO approval of moving Wood	
SRP-12	Livelihood Activity Plan	
SRP-13	DAFO approval of moving Livestock	
SRP-14	School acceptance form in new village.	
SRP-15	Vulnerable HH support request from HH to Project	
SRP-16	House floor plan design sketch	
SRP-17	Compensation expenditure Plan	
SRP - 18	Request letter requesting approval of Self-Resettlement Plan by RMU	

Other documents

No	Document
SRP -19	Committee review of SRP
SRP-20	RMU approval of SRP
SRP-21	PRLRC approval of SRP



Lao People's Democratic Republic
Peace Independence Democracy Unity Prosperity

=====000=====

Province:.....

District:.....

Village:.....

Memo of Final Resettlement Survey

Purposed

This final resettlement survey is purpose to finalize the decision of villagers impacted by Hydro-Power project of Nam Ngiep1, whether to resettle of project plan or self-resettlement, these information will apply to finalize compensation process and compensation documents in accordance with compensation policy.

Instruction of questionnaires

This form is comprised 5 parts:

- Section1: Households data and participants
- Section2: Certification of households on asset registration process
- Section3: Entitlement dissemination among settler and self-resettlement and also compensation calculation value.
- Section4: Resettlement to HouaySoup resettlement Area
- Section5: Livelihood Training participation
- Section6: Certification of households on final decision

Section1.

- Place:.....Date:.....
- Enumerator's Name(1):.....,From:.....Tel:.....
- Enumerator's Name(1):.....,From:.....Tel:.....
- Households information, Name of Head family.....;
Spouse.....,NNP1-HH-ID:.....,

Section2: Certification of households on asset registration process

- 1) Your family has complete registered all asset?, Yes, Still ongoing, If still in process, how many assets still ongoing.....Plots.
- 2) Your family has complete certification asset registration?, Yes, No, if no, please specify reason:.....
.....
- 3) Did you agreed of all your asset informing?, Yes, All, No some, Other(Specify):.....
- 4) Do you have assets not impacted or located above full supply level (320EL)?
 - o Yes; How many:.....Unit (reminded by enumerator)
 - o No;

Do you plan to continue use the asset above full supply level?

 - o No, Reason:.....
 - o Yes, I will use and reason.....
.....

Section3: Dissemination on resettle to HouaySoup Resettlement Site

My family have been aware the basic entitlement matrix or basic right for resettlement to HouaySoup Resettlement Area with project, and my understanding on explanation as following level.

- 1) Choice of resettlement 3 level, Poor, Middle , Well understood.
- 2) Basic right of resettlers, Poor, Middle , Well understood.
- 3) Grievance Procedure, Poor, Middle , Well understood.
- 4) Other (Specified):.....
.....
.....
- 5) Value of compensation amount for resettler to HouaySoup Resettlement Area
 - In cash:.....(Kip), value of asset not replacement
 - In cash:.....(Kip), value of surplus assets replacement
 - In kind:.....(Kip), value of fixed asset provided by NNP1
- 6) Value compensation for Self-Resettlement.
 - Total :.....(Kip), Value from all assets

Section4: Family Decision on resettlement

- 1) Where do your family decide to settle? HSRA, Self-Reset., No answer
- 2) In case, Self-resettlement,
 - o Village:....., District:....., Province:.....
 - o Do you have relative in new your resettlement purposed? Yes, No
 - o What kind of occupation you would like to apply in your new resettlement; Farmer; GoL’s staff; Business; Orthe (Specified):.....
.....
.....
 - o Could you give us a reason why don’t you resettle with project plans?
 - Do you have plan or plan in advance?
 - You don’t like the current resettlement location of project
 Other(Specified):.....
.....

See more detail on self-resettlement preparation documents

Section5: Family livelihood training participation

- 1) What kind of activities do you would like to train prior resettlement,
 - Agriculture
 - Fisheries
 - Cattle raising
 - Non-timber forest production
 - Off-farms
 - Other (Specified):.....
- 2) Could you please let we know that when convenience for you to participate on training?
 - Duration (month/Year):.....
 - Number of day:.....

Section 6: Comments of participations

1) Households comments,

This participation on dissemination of compensation policies and provided households decision, will apply to final compensation calculation and to proceed of future compensation process.

My family well known that, this resettlement survey is final state to choose for
resettle as project plan and self-resettlement plan. So, I would like to certify that
on my family choose as below:

Resettle to HouaySoup resettlement site.

Self-Resettlement

Household comments:

.....
.....
.....
.....

2) Enumerator's comments.

.....
.....
.....

Therefore, all of participants has agreed to make this memo for future
reference to concerns parties.

Date:.....

Households

Enumerator:

Head of family's name):.....

Spouse:.....

Village Chief:

District Coordinator

Resettlement management unit (RMU)

Lao People's Democratic Republic

Peace Independence Democracy Unity Prosperity

=====000=====

Province.....

District

Village.....

No.....

Unit.....

Date.....

Request

To: Mr..... Village head man of village.....

Subject: Request moving out from village..... District..... Province.....

My name is..... Age.....years old, Nationality..... Minority.....

Religious..... Occupation:..... Present address unit..... village.....

District..... Province.....

Respectfully requesting to head of village

Objective of the request:.....

.....

In front of village authority as well party organization and governance, I certify that

- Follow on instruction of party organization and governance strongly
- Active implementation all the tasks
- Will learn from progressive persons for building myself to be good person in society
- Will harmonize with other and colleague

Therefore, I write this request for you for consider and approve as appropriately.

Respectfully

Date:.....

Approved by Village head man

Requester

Old village

(stamp and signature)



Lao People's Democratic Republic

Peace Independence Democracy Unity Prosperity

=====000=====

Province:.....
District:.....
Village:.....

No.
Date

Movement Approval

Village head man of village..... District..... Province.....

Certify that Mr./Ms..... Age..... years. , Nationality..... Minority.....

Religious..... Present address unit..... village.....

District..... Province..... Family book
number....., date of issue..... ID number..... Date of issue..... issued
by.....

Contact number..... with family member Persons, male..... person and
female..... Moving to. village..... District..... Province.....

Reason of moving out.....
.....
.....

Therefore, the village authority issue this certificate for reference and request to all concerned
parties providing convenience to this family.

Approved by Village head man
Old village
(stamp and signature)

List name of followers:

- 1.
2.
3.
4.
5.
6.
7.

Lao People's Democratic Republic
Peace Independence Democracy Unity Prosperity

=====000=====

Province

District

Village.....

No..... Date.....

Unit.....

Request

To: Mr..... Village head man of village.....

Subject: Request moving in to village..... District..... Province.....

My name is..... Age.....years old, Nationality..... Minority.....

Religious..... Occupation:..... Present address unit..... village.....

District..... Province.....

Respectfully requesting to head of village

Objective of the request:.....

.....

In front of village authority as well party organization and governance, I certify that

- Follow on instruction of party organization and governance strongly
- Active implementation all the tasks
- Will learn from progressive persons for building myself to be good person in society
- Will harmonize with other and colleague

Therefore, I write this request for you for consider and approve as appropriately.

Respectfully

Date:.....

Approved by Village head man

Requester

Of new village

(stamp and signature)



Lao People's Democratic Republic

Peace Independence Democracy Unity Prosperity

=====000=====

Province.....

District.....

Village.....

No.....

Unit.....

Date.....

Acceptance letter

- According to the law of interior number 03/LNC, date 21/10/2003
- According to the law of family registration number 12/LNC, date 27/11/2009
- According to the request of Mr./Mrs..... Number..... Date.....
- According to the Agreement of village authority..... on date.....

Village Head Man Certify that

Accept Mr./Ms..... Present address unit.....

village.....District..... Province..... Family book number....., date of issue..... ID number..... Date of issue.....

Contact number..... with family member Persons, male..... person and female..... Moving from village..... District..... Province.....

Reason of moving in
.....
.....

Requested Individual or family who request to moving must prepare the right and full documents for further approval as mentioned in the law.

Therefore, village authority issue this acceptance letter as reference for prepare movement documents, this acceptance letter will be expired in the 6 months.

Village head man
(stamp and signature)



Lao People's Democratic Republic

Peace Independence Democracy Unity Prosperity

=====000=====

Province.....

District.....

Village.....

No.....

Unit.....

Date.....

Village Head Man Certification

The following public facilities are available in the village:

No	Facility	Facilities available
1	Electricity	1. Grid 2. Solar 3. Water turbine 4. Generator 5. No grid
2	Water supply	1. No improved water supply 2. Public well, GFS tap stand 3. Nampapa with household connection
3	Road access	1. None 2. Dirt road with only dry season access 3. Dirt road with all year round 4. Paved road
4	This village has a market?	Yes / No
5	The village has primary school?	Yes / No
6	The village has secondary school?	Yes / No
7	The village has health centre?	Yes / No

Therefore, village authority issue this certificate as reference.

Village head man
(Stamp and signature)



Lao People’s Democratic Republic

Peace Independence Democracy Unity Prosperity

=====000=====

Province.....

District.....

Village.....

Unit.....

No.....

Date.....

Agricultural Land Certificate

Name of warranty person Age.....years old, Nationality..... Minority.....

Religious..... Occupation:..... Present address unit..... village.....

District..... Province.....

Warrant Mr./Ms. Age.....years old, Nationality..... Minority.....

Religious..... Occupation:..... Present address unit..... village.....

District..... Province.....

Has land area for

- Housing land: _____ m²
- Paddy rice fields: _____ m²
- Garden land: _____ m²
- Plantation land: _____ m²
- Grazing land: _____ m²
- Upland: _____ m²
- Others () _____ m²

Agricultural land about..... m²

Therefore, the village authority issue this certificate as for reference.

Approved by Village head man

New village

(stamp and signature)



Lao People's Democratic Republic

Peace Independence Democracy Unity Prosperity

=====000=====

Province.....

District.....

Village.....

No.....

Unit.....

Date.....

Memorandum on Buying and Selling Land

Village head man of village district..... province.....

In front of three witnesses as below:

- 1. Mr..... age..... Years, nationality..... Occupation Address
2. Mr..... age..... Years, nationality..... Occupation Address
3. Mr..... age..... Years, nationality..... Occupation Address

I am..... Age.....years old, Occupation And Mrs..... Occupation Present address unit..... village.....

District..... Province.....

We had discussed and agreed that: selling land size about..... m^2

Total amount..... kip to Mr..... Age.....years old, Occupation And Mrs..... Occupation Present address unit..... village.....

after they receive compensation from NNP1, they will pay the agreed amount mentioned above.

Therefore, all parties agree to issue this memorandum and it had read to all to understand well for conducting signature.

Buyer Name and signature

Seller Name and signature

I certify that this memo is truly

Village..... Date.....

Village head man signature (Land location)

(stamp and signature)



Lao People's Democratic Republic

Peace Independence Democracy Unity Prosperity

=====000=====

Province.....

District

Village.....

No.....

Unit.....

Date.....

Request Moving Wood

To: DAFO

(via village authority of)

Subject: Request moving wood

- According to the rules and regulation concerning to moving or transporting wood from/ to other villages, district and province.
- According to the real situation of the family impacted from Dam construction.

My name is..... spouse name..... HHID present address.....

Request moving as detail below:

1. Number:.....
2. Number:.....
3. Number:.....
4. Number:.....
5. Number:.....
6. Number:.....

All above will be moved to village..... district.....

Province.....

Date:.....

Approved by Village head man

Requester

Old village

(stamp and signature)

Livelihood Plan

A. General Information:

Interviewee's names(husband/wife) Mr. _____ Ms. _____ Household ID: _____	Interview place: _____ Date: _____ Interviewer: _____
--	---

B. Household information

Name of head family:

(Name of Spouse):

Family member: People, Women People

 Family's occupied at current village:

 Second occupied at current village:

Current Address: Unit: Hamlet:

Village: /District:

Province:

C. Land

No	Land type	Number of plots before Resettlement	Self	Total land area in current village	Total land area after self-Resettlement, including land above 320msl still cultivated and new land purchases (m ²)
1	Housing land				
2	Irrigated paddy rice fields (2 season)	-		-	
3	Paddy rice fields				
4	Garden land				
5	Plantation land				
6	Ploughed garden land				
7	Grazing land				
8	Fish pond				
9	Upland rotational land				
10	Industrial plantation				
11	Others _____				
12	Others _____				

D. Estimated Value of current annual income in KIP.

What kind of income sources you get income to your family (What is eaten and sold?)

	Items	Unit	Eaten	Sold	Total	Price in LAK	Total in LAK	Comment
1	Rice/Up land –Low land							
2	Cattle/Buffalo							
3	Pig							
4	Poultry							
5	Wild vegetable							
6	Vegetable							
7	Cash crop _____							
8	Cash crop _____							
9	Cash crop _____							
10	Fruit tree							
11	Fish from nature							
12	Fish from aquaculture							
13	NTFP							
14	Handicraft							
15	Timber							
16	From relative (in other place including abroad)							
17	Working/Employment							
18	Business/Shop							
19	Interest from the bank							
20	Gift							
21	Others							

If anything you would like to describe more.....

E. Estimated Value of annual income after resettlement (LAK)

Selected 2-4 kind of farm activities and selected 2-4 non-farm activity you think, will help your family to get better income and selected 2-4 non-farm activity

	Items	Unit/Size	Inputs/Investment (KIP)	Eaten	Sold	Price/Sold (KIP)	Profit (KIP)	Who is going to buy your product	Remark
	Farming activity								
1	Rice/Up land –Low land								
2	Cattle/Buffalo								
3	Pig								
4	Poultry								
5	Wild vegetable								
6	Vegetable								
7	Fish from nature								
8	Fish from aquaculture								
9	Cash crop _____								
10	Cash crop _____								
11	Cash crop _____								
12	Fruit tree								
	Non-farming activity								
13	Handicraft								
14	NTFP								
15	Timber								
16	Working/Employment								
17	Business/Shop								
18	Interest from the bank								
19	From relative (in other place including abroad)								
20	Others _____								
21	Others _____								

If anything you would like to describe more.....



Lao People's Democratic Republic

Peace Independence Democracy Unity Prosperity

=====000=====

Province.....

District

Village.....

No.....

Unit.....

Date.....

Request Moving Animals

To: DAFO

(via village authority of)

Subject: Request moving animals

- According to the rules and regulation concerning to moving or transporting animals from/ to other villages, district and province.
- According to the real situation of the family impacted from Dam construction.

My name is..... spouse name..... HHID present address.....

Request moving as detail below:

1. Number:.....
2. Number:.....
3. Number:.....
4. Number:.....
5. Number:.....
6. Number:.....

All above will be moved to village..... district.....

Province.....

Date:.....

Approved by Village head man

Requester

Old village

(stamp and signature)

Lao People’s Democratic Republic
Peace Independence Democracy Unity Prosperity
=====000=====

District Education and Sport Office

_____ Primary School

No...../HPS

_____ Primary School, Date...../...../2016

Student Acceptance Form

Attention: Director of School.

Subject: Acceptance student to attend new school.....

- Refer to: The requestor Mr/Ms.....

Date:/...../.....the student is in grade.....at the school year of 2015-2016 in the school District..... Province.....

I, _____ School Director accepts Mr/Ms.....date of birth...../...../..... to attend school at gradein the school year of..... in condition that all documents are fully submitted following the regulation of the Ministry of Education and Sport

Document to be attached:

- Request moving of the family form
- Referral form
- Student Curriculum vitae
- Certificate of Education
- Student moving application form
- Certificate of the Mass Organizations
- Monitoring book
- Village Certificate
- Village Guarantee Certificate

Director of _____ Primary School

Letter of Request

To: The Managing Director of the Namngiep 1 Hydro Power Company

My name isFamily name

ID Number, Address

Is categorized as vulnerable household type:

Would like to request the consideration from the company to assist our family during the resettlement to the new village as details as the following:

Destination village: District: Province...

Type of assistance

1)
.....

Date and time

2)
.....

Date and time

.....

3)
.....

Date and time

.....

Thus, I would like to submit this request for your consideration.

Date/...../.....

Certified by Head of the village

Head of the family

Name and signature

House floor plan design sketch

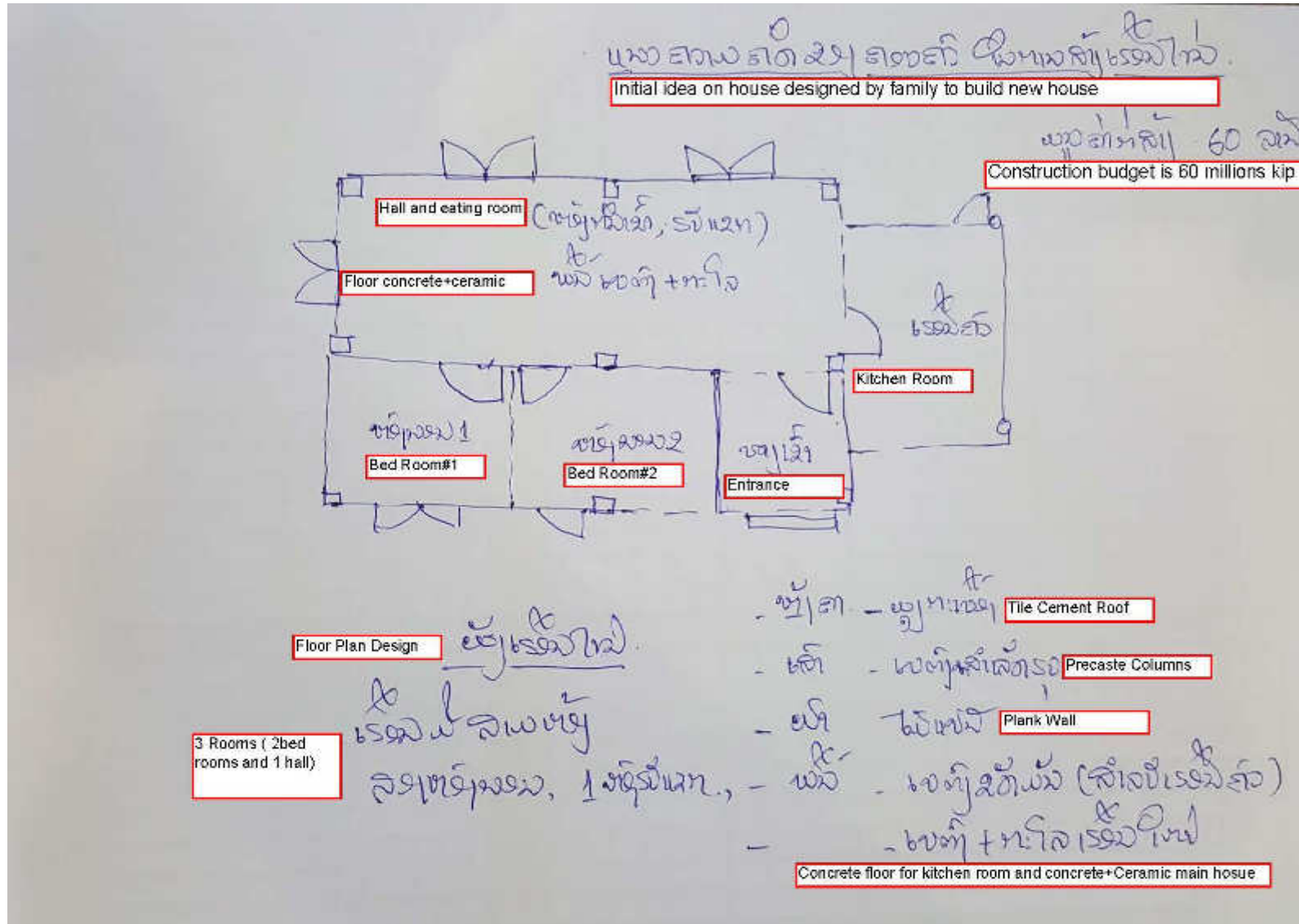



ແບບສໍາພາດ ການວາງແຜນການນໍາໃຊ້ເງິນ

Compensation Fund Expenditure Plan

ຂໍ້ມູນທົ່ວໄປ / General Information:

<p>ຊື່ຜູ້ຖືກສໍາພາດ (ຜົວ ແລະ ເມຍ) / Interviewee's names(husband/wife) ທ່ານ/Mr. _____ Pers_ID: _____) ນາງ/Ms. _____ Pers_ID: _____)</p>	<p>ເລກລະຫັດ / SMO ID: _____ ສະຖານທີ່ສໍາ/Interview place..... ວັນທີ / Date: _____ ຜູ້ສໍາພາດ / Interviewer: _____</p>
---	--

ຂໍ້ແນະນໍາການນໍາໃຊ້ແບບຟອມ/ Instruction of Financial Planning Form

ແບບຟອມສໍາພາດຊຸດນີ້ ເປັນແບບຟອມແນະນໍາວາງແຜນການນໍາໃຊ້ເງິນ, ຊຶ່ງຈະໄດ້ສະເພາະຄອບຄົວທີ່ຖືກຜົນກະທົບກັບໂຄງການໄຟຟ້ານໍ້າ ງຽບ1 ແລະ ທີ່ໄດ້ຮັບເງິນຊົດເຊີຍຫຼາຍກວ່າສິບລ້ານກີບຂຶ້ນໄປເທົ່ານັ້ນ. ຈຸດປະສົງຂອງການວາງແຜນ ການນໍາໃຊ້ເງິນ ແມ່ນເພື່ອຊ່ວຍໃຫ້ ປະຊາຊົນຜູ້ທີ່ໄດ້ຮັບຜົນກະທົບຈາກໂຄງການໄຟຟ້ານໍ້າງຽບ1 ກໍ່ຄືຄອບຄົວທີ່ໄດ້ຊົດເຊີຍເປັນເງິນສົດຈາກໂຄງການໃຫ້ນໍາໃຊ້ເງິນຖືກຕ້ອງຕາມເປົ້າ ໝາຍ ນໍາໃຊ້ແບບຍືນຍົງ ໃຫ້ສາມາດພື້ນຟູຊີວິດການເປັນຢູ່ໃຫ້ດີຂຶ້ນເທື່ອລະກ້າວ.

This form is for family financial planning apply to people affected and receive compensated from NNP1 Project and household who were received 10(ten) or above 10 million kip only. The proposed of family financial planning is aims to strengthening to PAP to manage their compensation cash and efficiencies expend money on livelihood restoration.

ແບບຟອມນີ້ປະກອບດ້ວຍ 5 ພາກໃຫຍ່/This form is comprised with 5 Sections.

ພາກທີ1 ຂໍ້ມູນທົ່ວໄປຂອງຄົວເຮືອນ/Section1: Household information

ພາກທີ2 ທ່ານຈະນໍາໃຊ້ເງິນທີ່ໄດ້ຈາກການຊົດເຊີຍໃນທາງໃດແດ່/Do you have plan to use compensation to which family's activities.

ພາກທີ3: ກິດຈະກຳພື້ນຟູ ຊີວິດການເປັນຢູ່ຂອງຄົວເຮືອນ/Household livelihood activities

ພາກທີ4 ແມ່ນກິດຈະກຳຫຼັກທີ່ຄົວເຮືອນກຳລັງດຳເນີນການຢູ່ ແມ່ນການສົ່ງເສີມໃຫ້ຄອບຄົວດັ່ງກ່າວໄດ້ດຳເນີນກິດຈະກຳທີ່ກຳລັງເຮັດຢູ່ນັ້ນ ທີ່ຢູ່ໃນທ່າຂະຫຍາຍ ໃຫ້ມີລາຍຮັບເພີ່ມຂຶ້ນໂດຍອີງໃສ່ພື້ນຖານທ່າແຮງຂອງຄອບຄົວນັ້ນໆ ໂດຍທາງໂຄງການຈະສະໜັບສະໜູນ ທາງດ້ານເຕັກນິກວິຊາການ ເພື່ອຂັບເຄື່ອນກິດຈະກຳໃຫ້ສືບຕໍ່/ Household's main activities or existing activities is being implementing and potential to increase the scale of activities and earn more income and household proposed to continue and the Project will provide technical support.

ພາກທີ5 ແມ່ນກິດຈະກຳໃໝ່ທີ່ຄົວເຮືອນມີຄວາມປະສົງຢາກດຳເນີນການ ຊຶ່ງເປັນກິດຈະກຳໃໝ່ ຫຼື ກິດຈະກຳທີ່ເຄີຍເຮັດມາກ່ອນແລ້ວ ແຕ່ບໍ່ ໄດ້ເຮັດໃນຊ່ວງນີ້/ New activity proposed by household where is potential to earn more income, the Project will provide technical support.

ພາກທີ6 ການມີສ່ວນຮ່ວມຮັບຊາບ/Section6: Signatures of relevant persons



ພາກທີ 1/Section 1: ຂໍ້ມູນທົ່ວໄປຂອງຄົວເຮືອນ/Household information

1./ ຂໍ້ມູນທົ່ວໄປຂອງຄົວເຮືອນ/Household information

ຊື່ແລະນາມສະກຸນຫົວໜ້າຄອບຄົວ/Name of head family:.....

ຊື່ແລະນາມສະກຸນ ຜົວ/ເມຍ(Name of Spouse):.....

ສະມາຊິກໃນຄອບຄົວມີທັງໝົດ/Family member:.....ຄົນ/People, ຍິງ/Women.....ຄົນ/People

ອາຊີບຕົ້ນຕໍຂອງຄອບຄົວໃນບ້ານເກົ່າ/Family's occupied at current village:.....

.....

.....

ອາຊີບສໍາຮອງຂອງຄອບຄົວໃນບ້ານເກົ່າ/Second occupied at current village:.....

.....

.....

ທີ່ຢູ່ໃນບ້ານເກົ່າ/Current Address: ໜ່ວຍທີ/Unit:..... ຄູ່ມ/Hamlet:.....

ບ້ານ/Village:.....ເມືອງ/District:.....

ແຂວງ/Province:.....

2. ຂໍ້ມູນກ່ຽວກັບການຊົດເຊີຍທີ່ໄດ້ຮັບ/Compensation information :

ຈໍານວນເງິນຊົດເຊີຍທີ່ໄດ້ຮັບຈາກໂຄງການນໍ້າງຽບ 1 ທັງໝົດ/Compensation value

(ເປັນຕົວເລກ/Number):.....ກີບ/LAK

ເປັນຕົວໜັງສື/In word:.....ກີບ/LAK

ການຊົດເຊີຍອື່ນໆທີ່ບໍ່ແມ່ນເງິນທີ່ໄດ້ຮັບຈາກໂຄງການນໍ້າງຽບ1, (ຖ້າມີ):In kind compensate, if have

1.....

2.....

3.....

4.....

3. / ຄອບຄົວໄດ້ເລືອກ/Household choose: ໄປດ້ວຍຕົນເອງ/self-motivation ໄປໃນແຜນ/Resettlement

4. / ຂໍ້ມູນກ່ຽວກັບສະຖານທີ່ບ່ອນທີ່ຈະຍົກຍ້າຍໄປຢູ່/New address proposed by household

ທີ່ຢູ່ໃນບ້ານໃໝ່/New Address: ໜ່ວຍທີ/Unit:..... ຄູ່ມ/Hamlet:.....

ບ້ານ/Village:.....ເມືອງ/District:.....ແຂວງ/Province:.....

ເນື້ອທີ່ດິນສໍາລັບປູກສ້າງເຮືອນມີຂະໜາດ/Housing land area(m2):.....ມ2/m2

ເນື້ອທີ່ດິນສໍາລັບທໍາການຜະລິດ/Agriculture land:.....ເຮັກຕາ/Ha ໃນນັ້ນ/Included:

- ປູກເຂົ້າ/Rice plantation Plan:.....ເຮັກຕາ/Ha;

- ປູກພືດອຸດສາຫະກໍາ/Tree industry land:.....ເຮັກຕາ/Ha;

- ດິນອື່ນໆ/Other Land:.....ເຮັກຕາ/Ha



ພາກທີ2/Section2. ທ່ານຈະນຳໃຊ້ເງິນທີ່ໄດ້ຮັບຈາກການທົດແທນແນວໃດ ກະລຸນາຫມາຍ "X" ໃສ່ໃນຮູບສີ່ແຈນ້ອຍ ແລະ ບັນດາລາຍການລຸ່ມນີ້. ສຳລັບແຕ່ລະລາຍການທີ່ເລືອກນັ້ນ, ເຂົ້າເຈົ້າຄວນຂຶ້ນກັບປະມານລວມທີ່ຈຳເປັນໃຊ້ຈ່າຍ./How would you plan to use compensation money? Please tick "X" in boxes of list below. Selected list, they should plan for the necessary budget.

ມູນຄ່າເງິນຊົດເຊີຍທີ່ໄດ້ຮັບຈາກໂຄງການ/Total compensation amount (Kip): _____

1 ປຸກສ້າງ/ສ້ອມແປງເຮືອນ (ໃຫ້ບອກມູນຄ່າ)/House improvement (Mention the amount): _____

ຈ່າຍຄືນໜີ້ (ໃຫ້ບອກມູນຄ່າ)/Pay Debt (Mention the amount)

ກອງທຶນບ້ານ/Village Fund _____

2 ຜູ້ປ່ອຍກູ້ຈາກທາງນອກ/ແມ່ຄ້າ/Outsider Loan/trader: _____

ແຫລ່ງທີ່ມາ/ເຫດຜົນຂອງໜີ້ສິນ/Source or reason for getting in debt: _____

ຝາກທະນາຄານ/Bank saving:

ຝາກມີກຳນົດ (.....ເດືອນ)/Fixed deposit (.....months): Interest benefit (_____)

3. ຝາກມີກຳນົດ (.....ເດືອນ)/Fixed deposit (.....months): Interest benefit (_____)

ຝາກມີກຳນົດ (.....ເດືອນ)/Fixed deposit (.....months): Interest benefit (_____)

ລວມມູນຄ່າ/Total Expenditure: _____

4. ຊື້ສິ່ງຈຳເປັນສຳລັບຄອບຄົວ/Spend on the necessary for household

ເຂົ້າ/Rice: _____

ຫມາກໄມ້ແລະຜັກ/Fruit and vegetables: _____

ຊີ້ນ, ໄກ່ ແລະ ປາ/Meat, Chicken, Fish: _____

ເຄື່ອງໃຊ້ໃນຄອບຄົວ (ຖ້ວຍ, ບ່ວງ ອື່ນໆ)/Household consumable: _____

ເຄື່ອງປຸງແຕ່ງອາຫານ (ນ້ຳຕານ, ນ້ຳປາ, ເກືອ, ນ້ຳມັນພືດ ອື່ນໆ)/Cooking seasoning (Sugar, fish source, Salt, cooking oil...): _____

ລວມມູນຄ່າທີ່ຈະໃຊ້ຈ່າຍ _____

Total Expenditure _____

ເຄື່ອງໃຊ້ປະຈຳວັນ (ສະບູ, ຢາສີແຂ້ວ ອື່ນໆ)/Daily consumable (Soap, toothpaste...): _____

ຢາປິວພະຍາດ/Medicine: _____

ເຄື່ອງນຸ່ງຫົ່ມ/Clothes: _____

ຄ່າຮຽນ ແລະ ອຸປະກອນການສຶກສາສຳລັບລູກ/Children's study fee and materials: _____

ອື່ນໆ ລະບຸ(Other Specify): _____

ລວມມູນຄ່າທີ່ຈະໃຊ້ຈ່າຍ _____

Total Expenditure _____

5. ຊື້ເຄື່ອງໃຊ້ໄຟຟ້າສຳລັບຄອບຄົວ (ໃຫ້ບອກມູນຄ່າແຕ່ລະລາຍການ)
Spend for Household's Electricity (Mention the amount of each item)

ຕູ້ເຢັນ/Refrigerator: _____

ໂທລະພາບ/Television: _____

ໂທລະສັບມືຖື/Mobile phone: _____

ເຄື່ອງຫລິ້ນຊີດີ/CD player: _____

ວິທະຍຸ/Radio: _____

ອື່ນໆ ລະບຸ/Other Specify: _____

ອື່ນໆ ລະບຸ/Other Specify: _____

ລວມມູນຄ່າທີ່ຈະໃຊ້ຈ່າຍ: _____

Total Expenditure _____

6. ຊື້ຊັບສິນທີ່ເປັນປະໂຫຍດ (ໃຫ້ບອກມູນຄ່າແຕ່ລະລາຍການ)
Spend for Household's necessary assets (Mention the amount of each item)

ລົດບັນທຸກ/Truck: _____

ລົດໄຖນາເດີນຕາມ/Hand tractor: _____

ເຮືອ/ຈັກເຮືອ/Boat/Boat engine: _____

ອື່ນໆ ລະບຸ/Other Specify: _____

ອື່ນໆ ລະບຸ/Other Specify: _____

ອື່ນໆ ລະບຸ/Other Specify: _____

ອື່ນໆ ລະບຸ/Other Specify: _____

ລວມມູນຄ່າທີ່ຈະໃຊ້ຈ່າຍ: _____

Total Expenditure _____



ພາກທີ 3/Section 3: ກິດຈະກຳພື້ນຟູ ຊີວິດການເປັນຢູ່ຂອງຄົວເຮືອນ/Household livelihood activities.

No	ກິດຈະກຳພື້ນຟູອາຊີບເກົ່າ/Existing Livelihood restoration:	No	ກິດຈະກຳພື້ນຟູອາຊີບໃໝ່/New Livelihood restoration Proposed:
1			
2			
3			
4			

ກິດຈະກຳທາງເລືອກໃນການຕັດສິນໃຈກ່ຽວກັບທາງເລືອກການພື້ນຟູອາຊີບ/Option on livelihood restoration activities

ລົງທຶນໃສ່ກິດຈະກຳສ້າງລາຍໄດ້ອື່ນນອກຈາກຂ້າງເທິງນັ້ນ / Other Enterprise business Investment

- ຮ້ານຂາຍຍ່ອຍ/Small shop: _____
- ລ້ຽງສັດນ້ຳ/Aquaculture: _____
- ວຽກປູກຝັງ/Agriculture: _____
 - ປູກຜັກ/Vegetable: _____
 - ປູກພືດເສດຖະກິດ/Cash crop: _____
 - ປູກພືດເສດຖະກິດ/Cash crop: _____
 - ໄມ້ໃຫ້ໝາກ/Fruit tree: _____
 - ປູກເຫັດ/Mush room: _____
- ສັດໃຫຍ່ Large animal
 - ງົວ(Cattle): _____
 - ຄວາຍ(Buffalo): _____
- ສັດນ້ອຍ small animal
 - ຫມູ/Pig: _____
 - ແບ້/Goat: _____
- ສັດປີກ/Poultry
 - ເປັດ/Duck: _____
 - ໄກ່/Chicken: _____
- ສັ່ງຮາກ/Handicraft
 - ລ້ຽງປາໃສ່ໝອງ/Fish in pond: _____
 - ລ້ຽງປາໃສ່ໃນນາເຂົ້າ /Fish in rice field: _____
 - ລ້ຽງປາໃສ່ກະຊັງ/Fish in cage: _____
 - ຜະລິດລູກປາ/Fish varieties: _____
 - ຕຳຫຼກ/Weaving handicraft: _____
 - ປູກມອນລ້ຽງມ້ອນ/Sink: _____
 - ຈັກສານ/Bamboo handicraft: _____
 - ຍິບແຊ່ວ/Hmong embroidery: _____
 - ຕີເຫຼັກ: _____
 - ກໍ່ສ້າງ: _____
- ເຄື່ອງປ່າຂອງດົງ/NTFP: _____
 - ຫວາຍ/rattan _____
 - ຢາງບົງ: _____
 - ໝາກແຄ້ນ/Sichuan piper : _____
 - ແຂມ: _____
 - ຕາວ: _____
 - ໄມ້ປ່ອງ: _____
- ອື່ນໆ: _____

ລວມມູນຄ່າທີ່ຈະໃຊ້ຈ່າຍ: _____ Total Expenditure _____	ລວມມູນຄ່າທີ່ຈະໃຊ້ຈ່າຍ: _____ Total Expenditure _____
--	--



ພາກທີ4/Section4. ກິດຈະກຳທີ່ກຳລັງດຳເນີນການມີຫຍັງແດ່/What kind of activities are you implementing(ນີ້ງກິດຈະກຳ/ໜ້າເຈ້ຍ)

ກິດຈະກຳທີ່ຄອບຄົວກຳລັງດຳເນີນການໃນປັດຈຸບັນ/Current existing activities (ບໍ່ເກີນ 1 ກິດຈະກຳ/ໜ້າ)

⇒ ຊື່ກິດຈະກຳທີ No:.....

⇒ ເລີ່ມຕົ້ນກິດຈະກຳ(ວັນ/ເດືອນ/ປີ)/Dated created activity:.....

⇒ ແນວຄິດລິເລີ່ມດຳເນີນກິດຈະກຳ(ຕິດບັອກ)/ Initiation/motivation to create activity:

- ຕົນເອງ/self-motivation,
- ຄົນອື່ນແນະນຳ/Another's recommendation,
- ໂຄງການລັດຖະບານ (ລະບຸ)/GoL agencies (Specified):.....
- ໂຄງການອື່ນໆ (ລະບຸ)/Project (Specified):.....
- ອື່ນໆ (ລະບຸ)/Other (specified):.....

⇒ ຈຳນວນເງິນລົງທຶນ/Investment cost:.....ກີບ(Kip).

⇒ ລະບຸແຫຼ່ງທຶນທີ່ໄດ້ມາຂອງຕົ້ນທຶນການລົງທຶນ/Identified investment resources:

- ຕົນເອງ/self,
- ພີ່ນ້ອງຊ່ວຍເຫຼືອ/Relative supports
- ທຶນຂອງລັດຖະບານຊ່ວຍເຫຼືອລ້າ/Grant supported by GoL,
- ທຶນຊ່ວຍເຫຼືອໂຄງການໄຟຟ້ານໍ້າງຽບ/NNP1 Project Supported,
- ທຶນກູ້ຢືນຈາກທະນາຄານ/Borrow money from the bank
- ທຶນກູ້ຢືນມອກລະບົບ/Borrow money
- ທຶນກູ້ຢືນອື່ນໆ(ລະບຸ)/Other(Specified):.....

⇒ ເວລາໃຫ້ຜົນຕອບແທນ/Cycle of beneficiaries return:.....ເດືອນ(months),

⇒ ຜົນຕອບແທນທີ່ໄດ້ມາເປັນທີ່/ Return satisfactory: ໜ້າພໍໃຈຫຼາຍ/very satisfied; ປານກາງ/Fine; ບໍ່ພໍໃຈ/not satisfied.

⇒ ທ່ານຍັງຢາກດຳເນີນການກິດຈະກຳນີ້ຕໍ່ໄປບໍ່?/Would you continue to undertake this activity? ຢາກ/Yes, ບໍ່/No, ຍ້ອນເຫດຜົນ/Why:.....

.....

⇒ ຖ້າທ່ານສິບຕໍ່ຈະລົງທຶນຕື່ມເທົ່າໃດ/How much investment cost will be used(if Yes):.....(ກີບ)/Kip,

⇒ ທ່ານມີຄວາມຕ້ອງຊ່ວຍເຫຼືອຫຍັງທາງດ້ານເຕັກນິກຕໍ່ກັບກິດຈະກຳນີ້/What you need on technical support from the project:

.....

.....

.....

⇒ ຂໍ້ແນະນຳຂອງພະນັກງານ/Recommendation of interviewer:.....

.....

.....

.....

ລວມມູນຄ່າທີ່ຈະໃຊ້ຈ່າຍ: _____
Total Expenditure _____

ພາກທີ5/Sections. ກິດຈະກຳທີ່ທ່ານຕ້ອງການຢາກເຮັດຕື່ມ/What kind of activities you would like to implement?
ກິດຈະກຳໃໝ່ທີ່ຄົວເຮືອນມີຄວາມປະສົງຢາກດຳເນີນການ/New activities proposed by households(ບໍ່ເກີນ1 ກິດຈະກຳ/ໜ້າ)

- ⇒ ຊື່ຊື່ກິດຈະກຳທີ່ No:.....
- ⇒ ຈະເລີ່ມຕົ້ນກິດຈະກຳ(ວັນ/ເດືອນ/ປີ)/When activity will start.....
- ⇒ ເກີດຈາກແຮງຈູງໃຈອັນໃດຈຶ່ງຢາກເຮັດກິດຈະກຳ(ຕິດບັອກ)/ Encourage to create activity:
- ຕົນເອງ/self-motivation,
 - ຄົນອື່ນແນະນຳ/Another's recommendation,
 - ໂຄງການລັດຖະບານ (ລະບຸ)/GoL agencies (Specified):.....
 - ໂຄງການອື່ນໆ (ລະບຸ)/Project (Specified):.....
 - ອື່ນໆ (ລະບຸ)/Other (specified):.....
- ⇒ ຈຳນວນເງິນລົງທຶນ/Investment cost:.....ກີບ(Kip).
- ⇒ ລະບຸແຫຼ່ງທຶນທີ່ໄດ້ມາຂອງຕົ້ນທຶນການລົງທຶນ/Identified investment resources:
- ເງິນຊົດເຊີຍໂຄງການໄຟຟ້ານໍ້າງຽບ1/NNP1 Project Supported,
 - ຕົນເອງ/self,
 - ພີ່ນ້ອງຊ່ວຍເຫຼືອ/Relative supports
 - ທຶນຂອງລັດຖະບານຊ່ວຍເຫຼືອລ້າ/Grant supported by GoL,
 - ທຶນກູ້ຢືນຈາກທະນາຄານ/Borrow money from the bank
 - ທຶນກູ້ຢືນມນອກລະບົບ/Borrow money
 - ທຶນກູ້ຢືມອື່ນໆ (ລະບຸ)/Other (Specified):.....
- ⇒ ຂະໜາດຂອງໂຄງການ(ເນື້ອທີ່ທີ່ແນວພັນ)/project size.....
- ⇒ ຈະໃຊ້ເວລາເທົ່າໃດຈຶ່ງຈະໄດ້ຜົນຕອບແທນ/How long will get beneficiaries return:.....ເດືອນ(months),
- ⇒ ຈຸດປະສົງເພື່ອ/What is Proposed: ຂາຍ/Sell, ບໍລິໂພກໃນຄອບເຮືອນ/Consumption, ອື່ນໆ (ລະບຸ)/Other(Specified):.....
- ⇒ ມີຕະຫຼາດຮອງຮັບແລ້ວບໍ່?/Has market for sell?, ມີ/Yes, ຢູ່ໃສ່Where, ບໍ່ມີ/No
- ⇒ ປະເມີນຄວາມສ່ຽງຕໍ່ການລົງທຶນມີຫຍັງແດ່?/What kind of risk: ບໍ່ມີຕະຫຼາດ/No market, ລາຄາຕົກຕໍ່າ/Price go down, ສິນຄ້າລົ້ນຕະຫຼາດ/surplus production, ອື່ນໆ/other (Specified).....
- ⇒ ຄາດການຜົນຕອບແທນຕໍ່ຄັ້ງຫຼືເດືອນຫຼືປີ/ Return Scale expectation.....
- ຄາດຄະເນຜົນຜະລິດ(ກິໂລ, ຈຳນວນໂຕ) product expectation
 - ຫົວໜ່ວຍລາຄາ Price
 - ເປັນເງິນ total
- ⇒ ທ່ານມີຄວາມຕ້ອງຊ່ວຍເຫຼືອຫຍັງທາງດ້ານເຕັກນິກຕໍ່ກັບກິດຈະກຳນີ້/What you need on technical support from the project:
- ⇒ ຂໍ້ແນະນຳຂອງພະນັກງານ/Recommendation of interviewer:.....

ລວມມູນຄ່າທີ່ຈະໃຊ້ຈ່າຍ/Total Expenditure _____
Total Expenditure _____



ພາກທີ6/Sections. ໃຫ້ຜູ້ສຳພາດອະທິບາຍຄືນໃຫ້ຜູ້ຖືກຜົນກະທົບບາງເນື້ອໃນທີ່ສຳຄັນລຸ່ມນີ້/the interviewer explain more to PAP as below:

1.	ອະທິບາຍຄືນໃຫ້ຜູ້ໄດ້ຮັບການທົດແທນຮູ້ວ່າ ເງິນທີ່ໄດ້ຮັບຈາກການທົດແທນຈະບໍ່ເສຍພາສີ ຫລື ຄ່າທຳນຽມໃດໆ <i>Explain to PAP that The compensation amount is not included any tax or fee</i>
2.	ອະທິບາຍຂັ້ນຕອນຂອງການຮ້ອງທຸກໃຫ້ຜູ້ໄດ້ຮັບການທົດແທນໃນກໍລະນີເຂົາເຈົ້າບໍ່ເຂົ້າໃຈຊັດເຈນ ຫລື ບໍ່ພໍໃຈການທົດແທນ <i>Explain Grievance Process if the PAP not understand or not satisfied</i>
3.	ທ່ານສັງເກດເຫັນວ່າໃນເວລາສຳພາດນັ້ນ, ແມ່ນໃຜເປັນຜູ້ຕອບຄຳຖາມຫລາຍກວ່າ? <i>The interviewer observed who gives more answer?</i> <input type="checkbox"/> ມີແຕ່ຝ່າຍຊາຍ (ຜີວ) ຕອບ <i>Male gives more answer (Husband)</i> <input type="checkbox"/> ມີແຕ່ຝ່າຍຍິງ (ເມຍ) ຕອບ <i>Female gives more answer (Wife)</i> <input type="checkbox"/> ຝ່າຍຊາຍ ແລະ ຝ່າຍຍິງ (ຜີວ ແລະ ເມຍ) ຕອບເທົ່າທຽມກັນ. <i>Male and female both give answer (Husband and wife)</i> <input type="checkbox"/> ຜີວ ແລະ ເມຍ ໄດ້ປຶກສາຫາລືກັນແຕ່ລະເທື່ອກ່ອນຕອບຄຳຖາມ <i>Husband and wife always discuss before answer the questions</i>

ລາຍເຊັນເຈົ້າຂອງ/ຜູ້ນຳໃຊ້ຊັບສິນ ເພື່ອຢັ້ງຢືນວ່າເຂົາເຈົ້າຮັບຮູ້ ແລະ ເຂົ້າໃຈສິດທິຕ່າງໆຂອງຕົນ

Signature of Land owner/Land user to certify their acknowledge and understand of their entitlement

ຊື່ແຈ້ງ ແລະ ລາຍເຊັນເຈົ້າຂອງ/ຜູ້ນຳໃຊ້ຊັບສິນ (ເມຍ)
Name and signature of land owner/land user (Wife)

ວັນທີ: _____

ຊື່ແຈ້ງ ແລະ ລາຍເຊັນເຈົ້າຂອງ/ຜູ້ນຳໃຊ້ຊັບສິນ (ຜີວ)
Name and signature of land owner/land user (Husband)

ວັນທີ: _____

ວັນທີ: _____

ພະນັກງານພາກສະໜາມ DWG

ວັນທີ: _____

ພະນັກງານພາກສະໜາມ SMO

ວັນທີ: _____

ນາຍບ້ານ

ວັນທີ: _____

ກອງເລຂາ/RMU

ວັນທີ: _____



Lao People's Democratic Republic

Peace Independence Democracy Unity Prosperity

=====000=====

Province.....

District.....

Village.....

No..... Date.....

Request letter

On self-resettlement

To: Mr..... RMU

Subject: Request moving out from village..... District..... Province.....

My name is..... Date of birth.....

Spouse name Date of birth

Present address house number: unit..... village hamlet.....
village.....District..... Province..... HHID.....

Family member persons, female..... persons.

All compensation amount kip

Amount in word kip

Other support from NNP1 as below

- 1./.....
- 2./.....
- 3./.....
- 4./.....
- 5./.....

After my family received instruction from PRLRC Xaysomboun province, listened to the explanation on the entitlements of different resettlement from concerned technical staff and other related government staff. We had discussed among family in detail. Therefore we all agreed and decided together **on self-resettlement**. This decision making is not threatened or pushed by someone, but it is our volunteer in the family.

Main Reason for decision making is

.....

.....

.....

.....

.....

All related documents are attached as below:

No	Document	Available
1	Copy of Final Choice on resettlement	Yes
2	Certificate of employment if GOL staff	
3	Request moving out from old village	
4	Request moving in to new village	
5	Movement Approval	
6	Acceptance of living in new village.	
7	Public facilities list in the new village signed by Village Chief	
8	Proof of land ownership at new village	
9	Agreement to purchase land at new village	
10	Land title of housing land including house	
11	DAFO approval of moving Wood	
12	Livelihood Activity Plan	
13	DAFO approval of moving Livestock	
14	School acceptance form in new village.	
15	Cash Compensation expenditure Plan	

We understand well on situation and criteria of new village where the place that we will move in including livelihood plan as attached to this request for guarantee that my family will be eradicated from poverty as guideline and policy of the government issued. After moving to new place we promise that we will not request additional compensation from NNP1 and will active on livelihood establishment, will not be making any issue to the project and concerned authority. We will be aiming to be model family as good Lao population.

For certifying our decision making officially, therefore we conduct signature in below for future reference.

Hope that all concerned authorities and RMU will consider and approve as appropriate.

Your sincerely,

Village..... Date.....

Requester signature or finger print.....

Spouse signature or finger print.....

Date



Lao People's Democratic Republic
Peace Independence Democracy Unity Prosperity

=====000=====

Province.....

District.....

No..... Date.....

Review of Self Resettlement Request

- According to the Resettlement and Compensation Policy Agreement No. 1170 date 29/9/2015
- According to the instruction of PRLRC concerning to self-resettlement

Dements from Self Resettlement Plan

No	Document	Valid	Not valid
SRP - 02	Copy of Final Choice on resettlement		
SRP-03	Certificate of employment if GOL staff		
SRP-04	Request moving out from old village Approval of moving out from old village		
SRP-05	Request moving in to new village		
SRP-06	Acceptance of living in new village.		
SRP-07	Public facilities list in the new village signed by Village Chief		
SRP-08	Proof of land ownership at new village		
SRP-09	Agreement to purchase land at new village		
SRP-10	Land title of housing land including house		
SRP-11	DAFO approval of moving Wood		
SRP-12	Livelihood Activity Plan		
SRP-13	DAFO approval of moving Livestock		
SRP-14	School acceptance form in new village.		
SRP-15	Vulnerable HH support request from HH to Project		
SRP-16	House floor plan design sketch		
SRP-17	Compensation expenditure Plan		
SRP - 18	Request letter requesting approval of Self-Resettlement Plan by RMU		

According to the request of..... PAH decided on self-resettlement

On date..... the committee including RMU, DCC and NNP1P has reviewed all concerned documents of the Self Resettlement Plan of PAP ID No _____ and assessed them as follows:

Based on the Self Resettlement Plan and supporting documents the Committee has found:
(Circle finding and strike through the wrong answer)

- 1) The PAP is eligible / ~~not eligible~~ for self-resettlement based on the criteria
- 2) A full set of documents has / ~~has not~~ been provided as required
- 3) Is the self-Resettlement plan likely / ~~not likely~~ to meet income target (above poverty and economic parity)
- 4) The self-resettlement plan is likely / ~~not likely~~ to be implemented successfully.

Therefore, the committee in unison decide to either

- (i) Support the Self-Resettlement Application
- (ii) Request for more information or
- (iii) Reject the Self-Resettlement Plan based on provided information

Therefore, the committee issue this assessment for reference and request to RMU for further approval.

Date.....	Date	Date
RMU.....	DCC	NNP1PC



Lao People's Democratic Republic

Peace Independence Democracy Unity Prosperity

=====000=====

Province.....

Resettlement Management Unit

No..... Date.....

Request Letter to PRLRC
On Self-Resettlement Approval

To: PRLRC
Subject: Self-Resettlement Approval

- According to the Resettlement and Compensation Policy Agreement No. 1170 date 29/9/2015
- According to the committee's letter Certifying consideration on self-resettlement no..... date.....

Following the committee's decision that the names below are considered self-resettlers:

- 1. Mr./Ms. spouse name..... HHID.....
2. Mr./Ms. spouse name..... HHID.....
3. Mr./Ms. spouse name..... HHID.....
4. Mr./Ms. spouse name..... HHID.....
5. Mr./Ms. spouse name..... HHID.....
6. Mr./Ms. spouse name..... HHID.....
7. Mr./Ms. spouse name..... HHID.....
8. Mr./Ms. spouse name..... HHID.....
9. Mr./Ms. spouse name..... HHID.....
10. Mr./Ms. spouse name..... HHID.....

RMU has no objection, therefore would like to pass these requests to PRLRC for further approval.

Your Respectfully.

Date.....

RMU.....



Lao People's Democratic Republic

Peace Independence Democracy Unity Prosperity

=====000=====

Province.....

PRLRC.....

No..... Date.....

**Approval Letter
On Self-Resettlement**

- According to the Resettlement and Compensation Policy Agreement No. 1170 date 29/9/2015
- According to the Request Letter of RMU No..... Date.....

PRLRC approved that Mr..... Spouse name..... HHID
 Present address Unit.....
 Village..... District..... Province.....
 and it will be moved to Unit..... Village.....
 District..... Province.....

This household must

- Follow on instruction of party organization and governance strongly
- Be good person in society
- Harmonize with other and colleague
- Away from illegal activities (drug abuse, forest destroy and etc...)

Therefore, the PRLRC issue this approval certificate as reference for further implementing.

Date.....

PRLRC.....