

Social Safeguard Due Diligence Report

Project number: 47282-009
October 2020

Afghanistan: Energy Sector Development Investment Program (Tranche 7)

Construction of Two Incoming Line Bays in 220/32/20 kV Pol-e-Hashimi Substation

Prepared by the Da Afghanistan Breshna Sherkat for the Asian Development Bank.

This social safeguard due diligence report is a document of the recipient. The views expressed herein do not necessarily represent those of ADB's Board of Directors, Management, or staff, and may be preliminary in nature. Your attention is directed to the ["terms of use"](#) section on ADB's website.

In preparing any country program or strategy, financing any project, or by making any designation of or reference to a particular territory or geographic area in this document, the Asian Development Bank does not intend to make any judgments as to the legal or other status of any territory or area.

SOCIAL SAFEGUARD DUE DILIGENCE REPORT (DDR)
CONSTRUCTION OF TWO INCOMING LINE BAYS IN 220/32/20 KV POL-E-HASHIMI SUBSTATION



ISLAMIC REPUBLIC OF AFGHANISTAN
DA AFGHANISTAN BRESHNA SHERKAT (DABS)

MFF, ESIP, Tranche-7, ADB Grant: TBD
Contract No.: TBD

SOCIAL SAFEGUARD DUE DILIGENCE REPORT (SSDDR)
Construction of Two Incoming Line Bays in 220/32/20 kV Pol-e-Hashimi Substation

October 2020

GLOSSARY

Affected person	Persons in the project's area of influence experiencing economic, social or environmental impacts Compensation Payment in cash/voucher or kind to which the affected people are entitled in order to replace the lost asset, resource or income.
Cut-off date	A cut-off date is a date of eligibility for entitlements, which is required to be disclosed. A person settling in the project affected area after this published date and claiming compensation will not be eligible to receive compensation. If a country's laws do not provide for such a cut-off date, generally the project level census start or end date is determined to be the cut-off date.
Displaced person	Person affected by involuntary acquisition of land or involuntary restrictions on land use resulting in physical or economic displacement.
Economic displacement	Loss of land, assets, access to assets, income sources, or means of livelihoods as a result of (i) involuntary acquisition of land, or (ii) involuntary restrictions on land use or on access to legally designated parks and protected areas.
Entitlements	All compensation, relocation and income restoration measures due to displaced persons, specified by their property status and particular losses.
Involuntary resettlement	Development project results in unavoidable resettlement losses that people affected have no option but to rebuild their lives, incomes and asset bases elsewhere.
Non-titled displaced person	Displaced persons without formal legal rights to land or claims to land recognized or recognizable under national law; eligible for compensation of non-land assets.
Replacement cost	Compensation for acquired land, structures and other assets, including (i) fair market value, (ii) transaction costs, (iii) interest accrued, (iv) transitional and restoration costs, and (v) other applicable payments, if any.
Socio-economic survey	Assessment of the social and economic conditions of the displaced persons through a combination of quantitative and qualitative research methods, providing a baseline and benchmark for monitoring and evaluation.
Vulnerable person	A distinct group of people who may suffer disproportionately from resettlement effects. The SPS defines vulnerable groups as households below the poverty line, the elderly, female headed households, and disabled headed households, those without legal title to assets, landless, women, children and indigenous people.

Table of Contents

1	Abbreviations	3
2	Introduction.....	4
3	Background	6
4	Scope of Sub-project and DDR.....	7
5	Rationale for Due Diligence on Land Transfer	8
6	Legal and Policy Framework	10
7	Location of Sub-Project	10
8	Methodology.....	13
9	Field visits and Stakeholder and/or Public Consultation.....	13
10	The Issue of Encroachers	18
11	Conclusions.....	18

Figures:

Figure 1: Pol-e-Hashimi substation on Google Earth	9
Figure 2: Herat province districts map	11
Figure 3: Photo of Pol-e-Hashimi substation land.....	11
Figure 4: Photo of Pol-e-Hashimi substation land.....	12
Figure 5: Pol-e-Hashimi substation location on GIS.....	12
Figure 6: Consultation meeting with district governor and local people.....	17

Tables:

Table 1: GPS Coordinates of Pol-e-Hashimi substation.....	9
Table 2: Involuntary Resettlement Screening Checklist.....	13
Table 3: Attendances Sheet of Public Consultation Meeting.....	16

Annexure:

Annex 1: Land documents showing the ownership of government land allotted to Pol-e-Hashimi substation	20
• Annex 1.1: Formal letter from Herat governor office to MUDL provincial department	20
• Annex 1.2: Formal letter from DABS' Herat Branch to Governor Office.....	21
• Annex 1.3: Formal letter from Survey and Cadaster department to Herat DABS' Branch	23
• Annex 1.4: Formal letter from MUDL provincial department to Herat governor office.....	24
• Annex 1.5: Tasked delegation report to Survey and Cadaster department.....	26
• Annex 1.6: formal letter from Survey and Cadaster Dept. to Technical Dept. of Land Ownership.....	28
• Annex 1.7: Cadaster sketch of Pol-e-Hashimi substation land	29
• Annex 1.8: Formal letter from MUDL provincial department to MUDL HQ.....	31

GLOSSARY

Affected person	Persons in the project’s area of influence experiencing economic, social or environmental impacts Compensation Payment in cash/voucher or kind to which the affected people are entitled in order to replace the lost asset, resource or income.
Cut-off date	A cut-off date is a date of eligibility for entitlements, which is required to be disclosed. A person settling in the project affected area after this published date and claiming compensation will not be eligible to receive compensation. If a country’s laws do not provide for such a cut-off date, generally the project level census start or end date is determined to be the cut-off date.
Displaced person	Person affected by involuntary acquisition of land or involuntary restrictions on land use resulting in physical or economic displacement.
Economic displacement	Loss of land, assets, access to assets, income sources, or means of livelihoods as a result of (i) involuntary acquisition of land, or (ii) involuntary restrictions on land use or on access to legally designated parks and protected areas.
Entitlements	All compensation, relocation and income restoration measures due to displaced persons, specified by their property status and particular losses.
Involuntary resettlement	Development project results in unavoidable resettlement losses that people affected have no option but to rebuild their lives, incomes and asset bases elsewhere.
Non-titled displaced person	Displaced persons without formal legal rights to land or claims to land recognized or recognizable under national law; eligible for compensation of non-land assets.
Replacement cost	Compensation for acquired land, structures and other assets, including (i) fair market value, (ii) transaction costs, (iii) interest accrued, (iv) transitional and restoration costs, and (v) other applicable payments, if any.
Socio-economic survey	Assessment of the social and economic conditions of the displaced persons through a combination of quantitative and qualitative research methods, providing a baseline and benchmark for monitoring and evaluation.
Vulnerable person	A distinct group of people who may suffer disproportionately from resettlement effects. The SPS defines vulnerable groups as households below the poverty line, the elderly, female headed households, and disabled headed households, those without legal title to assets, landless, women, children and indigenous people.

1 Abbreviations

ADB	- Asian Development Bank
AF	-Affected Family
AP	-Affected Person
ESDIP	- Energy Sector Development Investment Program
DABS	-Da Afghanistan Breshna Sherkat
DDR	-Due Diligence Report
DP	-Displaced Person
CSC	-Construction Supervision Consultants
TA	-Technical Assistance
EA	-Executing Agency (DABS)
EMA	-External Monitoring Agency
ESSU	-Environmental and Social Safeguard Unit
HEP	-Herat Electrification Project
kV	-Kilo volt
LAL	- Land Acquisition Law
LAR	-Land Acquisition and Resettlement
LARF	-Land Acquisition and Resettlement Framework
LARP	-Land Acquisition and Resettlement Plan
MMF	- Multi-tranche Financial Facility
MoF	- Ministry of Finance
MUDL	- Ministry of Urban Development and Land
NGO	-Nongovernment Organization
PMO	-Project Management Office
PMPI	-Project Management and Project Implementation
RP	-Resettlement Plan
SPS	-Safeguard Policy Statement
Sqm	- Square Meter
SS	-Substation
TL	- Transmission Line
WB	-World Bank

1 Executive Summary

1. The Herat Electrification Project (HEP) is to provide electricity to households, institutions, and businesses in the selected areas of Herat Province, Afghanistan, with focus on the districts of Chesht, Hobai, Karrokh and Pashtun-Zarghoon of Herat Province. The Project is expected to contribute to Da Afghanistan Breshna Sherkat's (DABS) overall objectives of alleviating poverty and ensuring inclusivity of access to reliable electricity for all segments of the population. The main components including construction of Pol-e-Hashimi 220/32/20 kV substation are funded by the Work Bank (WB). The construction of two incoming line bays, to be located within the substation land, will be funded by ADB under the ESIIIP of MFF.

2. The investment program, including its Tranches 1 - 6 have been categorized as Involuntary Resettlement (IR) Category B. Following ADB's Safeguard Policy Statement (SPS 2009), and the Afghanistan's amended Land Acquisition Law, LARF was prepared by DABS in October 2015 to guide the preparation of LARPs for subprojects and mitigate any impacts, should they arise. It was further updated in October 2017-18. The latest update was done in October 2019 to apply sectional project site handover approach, where upon availability of final project design, LAR impacted and non-LAR impacted areas will be identified based on sectional due diligence reports (DDRs) and sectional implementation ready LARPs. The updated LARF applies to all subprojects of this MFF.

3. This Tranche 7 will include:

- **Output 1: Transmission capacity in western Afghanistan expanded.** The project will finance the construction of (i) about 135 km of 220-kilovolt (kV) transmission line from a new 220/20kV Pul-e-Hashemi substation in Herat center to the proposed 220/20kV Shindand substation in Shindand District; and (ii) about 176 km of 220kV transmission line from the proposed 220/20kV Shindand substation to the proposed 220/20kV Farah substation in Farah center.
- **Output 2: Power distribution network and capacity expanded.** The project will finance: (i) upgrade of a new 220/20kV Pul-e-Hashemi substation in Herat center with two 220kV line bays; (ii) commissioning of a 2 X 16 megavolt-amperes substation in Shindand District; (iii) construction of a new 20/0.4kV Shindand distribution network; (iv) commissioning of a 2 X 40 megavolt-amperes substation in Farah center; and (v) construction of a new 20/0.4kV Farah distribution network.
- The associated facility includes the World Bank-funded new 220/20kV Pul-e-Hashemi substation, which is at the award stage. The construction period is 18 months, which is aligned with the tranche 7 infrastructure construction schedule.

4. This Tranche 7 is categorized as A due to approximately 405 severely impacted persons in two LARPs for two transmission lines. This is mainly due to preliminary calculation of all temporary and permanent impacts on full ROW. These may be reduced during project implementation and application of mitigation measures aiming to minimize any adverse impacts.
5. This DDR relates to the Pol-e-Hashimi 220/32/20 kV substation for construction of two incoming line bays. The DDR has been prepared by DABS to substantiate that the 73,669.68 sqm land required for the said substation, where the two incoming line bays will be also constructed, has been released from the Ministry of Urban Development and Land and there is no physical and economic displacement of the people in this area.
6. A team comprising Senior Engineer from DABS, Social Safeguard Expert from Environmental Social Safeguard Unit, and a representative from DABS Provincial (Herat) Department reviewed and visited of the substation site at Pol-e-Hashimi in November 2019. It was found that the substation site of 220/32/20 kV Pol-e-Hashimi substation is a government property (Annex 1) that is situated in the Zinda Jan district of Herat province. The feasibility report, consultation with Land and other district and provincial government Departments involved in land identification/determination process, confirm that the land allocate for construction of Pol-e-Hashimi substation does not have LAR and livelihood impact on the nearby villages/communities.
7. The Land Directorate of Herat province identified its delegation consisted of two officials, to the Governor Office for identification of land, via letter no. 487/490 dated 25/Feb/2019. The delegation identified the required land and presented its report on 30/Sept/2019. The Geodesy and Cadaster Department of Herat province formally sent the sketch, prepared by the delegation, of required land in a specific form to the Technical Affairs Department of Land Directorate of Herat province for further action via letter no. 1592/1037 dated 21/Oct/2019. The sketch has been derived from segment number 23 of Cadaster map which is kept in archive of Cadaster Department of Herat Land Directorate (Annex 1.4, Annex 1.5 and Annex 1.6). The above stated letter (1592/1032) through which the sketch was provided and certified is acceptable for DABS as an official document as per Afghanistan intergovernmental procedures.
8. The substation related activities will involve no land acquisition and resettlement impacts, as the project will be located on the available state land, which is free of any squatter and dispute.
9. Two incoming bays will be constructed within the allotted land of Pol-e-Hashimi substation to connect Sindand substation via 220 kV transmission line.

2 Introduction

10. Afghanistan is a net energy importer. While indigenous renewable energy and fossil fuels resources exist, these need to be developed. By 2032, the power demand in Afghanistan is forecast to reach 3,500 MW and electric consumption to touch 18,400 GWh, and meeting this demand requires development of all viable import and local generation.

11. The Afghanistan National Development Strategy set out ambitious goals for increasing access to electricity in major urban and rural areas. The objective of this strategy is to reach above 65 percent of households and more than 90 percent of commercial and non-residential establishment's access sustainable electricity supply. This definitely requires considerable financing to meet this electrification projection which recently was estimated sitting at 25 to 30 percent nationwide. According to Afghanistan's Power Sector Master Plan (2013), overall electrification of the country will reach 65 percent by 2032 with an expected peak load of 3,500 Mega-Watt (MW).

12. The Asian Development Bank (ADB) has been supporting Afghanistan's energy sector since 2001 and is the largest on-budget development partner of the Government of Afghanistan.

3 Background

13. Herat is the Province in Afghanistan with the second highest combined commercial and technical losses just following Kabul Province. Any improvement in the Herat system will positively affect the overall viability of DABS as a power utility. Secondly, Herat is a microcosm in terms of electricity network that within its own borders combines all challenges that the overall electricity network in Afghanistan experiences, such as a large dependency from imports and challenges of interconnecting the domestic (hydro-based) generation with the international system. While focusing on electrification of Herat rural districts, the Project is also a test case for how electrification can be sustainably undertaken, including through off-grid pilots, and how an electricity network can be made to grow together over time.

14. The Da Afghanistan Breshna Sherkat (DABS - Afghanistan Electricity Corporation), established as an independent and autonomous corporation for the generation, import, transmission and distribution of power across the country, is responsible as the Implementation agency (IA) to implement the Project through its Program Management Office (PMO), supported by a Program Management and Project Implementation Consultants (PMPIC).

15. Energy Supply Improvement Investment Program (ESIIP) is being implemented in Afghanistan through financing from Asian Development Bank (ADB) under a Multi-tranche Financial Facility (MFF) that has been divided into a number of tranches or groups of subprojects. Each of the program's tranches constitutes a project which, in turn, has been divided into several subprojects involving the construction of the power transmission and substation projects. The two incoming line bays to be constructed within the premises of 220/32/20 kV Pol-e-Hashimi substation is sub-project under Tranche-7 of the MFF. T7 consists of Pol-e-Hashimi – Shindand and Shindand – Farah 220 kV TL, Sindand and Farah 220/20 kV substations construction as well as construction of two incoming line bays in Pol-e-Hashimi substation.

16. The land area for construction two incoming line bays of the subject substation has been determined based on the feasibility report, site visits, documents review, and stakeholder consultation. The 73,669.68 sqm area, allotted for the substation, is more than adequate to accommodate the switchyard, switchgear, control room and other essential accessories of the subject substation as well as to accommodate construction of two incoming line bays. The preliminary and subsequently the detailed design may only consider some revision in the technical specification of the electrical devices and in civil work to some extent but enough space is available to accommodate the substation subsequent to the detailed design.

17. During the site visit took place in November 2018, review of feasibility report and based on consultation with stakeholders, no land acquisition and resettlement impact has been identified and this social safeguards Due Diligence of Pol-e-Hashimi 220/32/20 kV substation sub-project has been conducted by DABS through its PMPIC.

4 Scope of Sub-project and DDR

18. This DDR relates to the Pol-e-Hashimi 220/32/20 kV substation. The DDR has been prepared by DABS to substantiate that the 73,669.68 sqm land, required for the Pol-e-Hashimi substation, has been allotted from the Ministry of Urban Development and Land (Annex 1) and there is no physical and economic displacement of the people in this area.

19. This substation will be powered by extending a double circuit transmission lines from the Noor-e-Jahad substation, two 220kV incoming line bays for connection with Shindand substation, and connection with West-North Power Sector (WNPS) to the Afghanistan, distributing power from Salma HPP and Iran Power System – existing connection from 132/20kV SS Turbat – e – Jam with 132kV TL double circuit.

20. Substation design and construction in Pol-e-Hashemi, shall include all 220KV, 132kV, Bus-Bar, 20kV switchgear, gantry and structures necessary to support circuits as indicated in conceptual design drawings. The installation shall include all required

breakers, switches, arrestors, switchgears, transformers and metering equipment, and other components necessary to operate the system. The construction will also include two incoming line bays that will connect Shindand substation via Pol-e-Hashimi – Shindand 220 kV TL.

21. Civil work plus installation of electrical equipment related to the substation and two incoming line bays in the allotted substation land have zero impact on the outside of the DDR area. The Scope of this project shall include all calculation, design, manufacture, assembly and acceptance testing of all equipment at the contractor or Manufactures workshop as well as the supply, customs clearance, delivery, unloading, erection, adjusting, painting, identification, commissioning, trial operation of all equipment, to facilitate the handing over to the Employer on a turnkey basis fully operational and complete substations suitable for satisfactory operation.

22. The substation will be located in state land and can be approached via main Zinda Jan-Herat road. The distance of the substation from the main road is not more than 300m. Therefore, development of new access road is not required. The area located within the 300m distance of the substation is also state owned land and does not have any LAR impact, considered public road and can be always utilized for transportation of electrical equipment and other construction material.

5 Rationale for Due Diligence on Land Transfer

23. The 73,669.68 sqm land for the 220//32/20 kV Pol-e-Hashimi substation has been identified and allotted to DABS by the MUDL Provincial Department (Annex 1). To comply with the requirement of inter-governmental land title transfer process, this DDR has been prepared by DABS to provide information on presence of any no LAR issues related to the construction of substation.

24. The Land Directorate of Herat province identified its delegation consisted of two officials, to the Governor Office for identification of land, via letter no. 487/490 dated 25/Feb/2019. The delegation identified the required land and presented its report on 30/Sept/2019. The Geodesy and Cadaster Department of Herat province formally sent the sketch, prepared by the delegation, of required land in a specific form to the Technical Affairs Department of Land Directorate of Herat province for further action via letter no. 1592/1037 dated 21/Oct/2019. The sketch has been derived from segment number 23 of Cadaster map which is kept in archive of Cadaster Department of Herat Land Directorate (Annex 1.4, Annex 1.5 and Annex 1.6). The land is free of any cultivation and completely barren land as well as there is no livelihood and no income sources are affected. The access to the allotted land does not affect the daily activities and access to income sources of the villagers in that area

25. DABS started its process via MUDL Provincial Department of Herat province with the governors' office to provide the state land to DABS for construction of the substation in November 2018.

26. According to the coordinates (Table 1) and legal documents translated to English, attached as Annex 1, the identified and selected land which was owned by the government and formally allotted to DABS for construction of 220/32/20 kV Pol-e-Hashimi substation. The below table is showing 4 corners coordinates of the identified land of the subject substation (Figure 1).

Table 1: GPS Coordinates of Pol-e-Hashimi substation

S.N	Corner Points	Easting	Northing
1	P1	061 54.960	34 19.840
2	P2	061 54.787	34 19.839
3	P3	061 54.740	34 19.991
4	P4	061 54.897	34 19.995

Figure 1: Pol-e-Hashimi substation on Google Earth

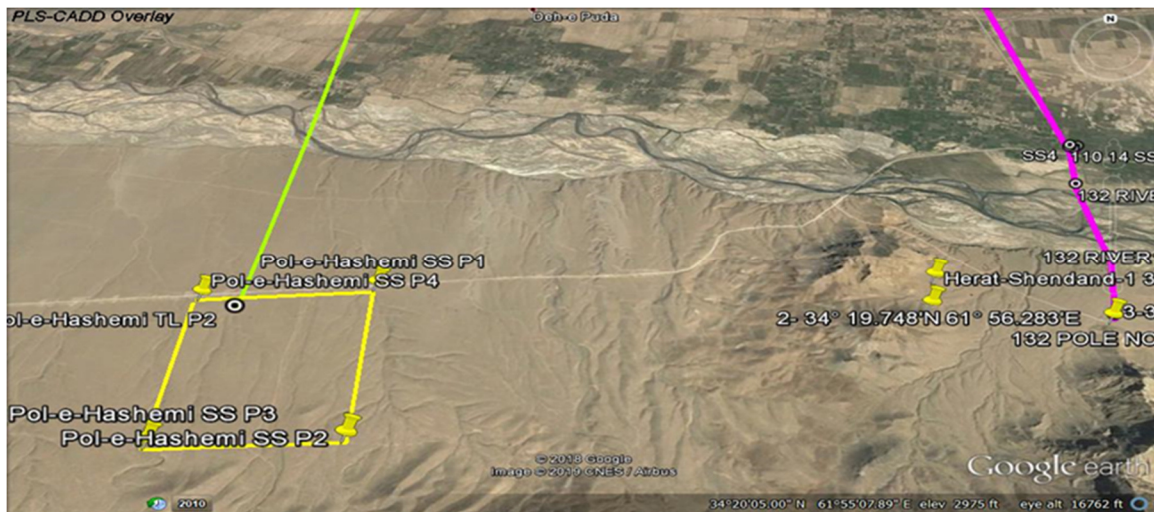

6 Legal and Policy Framework

27. The laws and regulations of Afghanistan and provisions ADB's SPS, 2009 has been followed while conducting due diligence for this subproject. The Land law of Afghanistan confirms that government lands are regulated by MUDL and that public welfare projects on government lands must be approved by MUDL. Once of the article of the Law on Land Acquisition allows the transfer of government owned properties for the implementation of projects of public interest as well as allowing implementation of urban master plans and all other plans for projects of public interest.

7 Location of Sub-Project

28. The 220//3220 kV Pol-e-Hashimi SS is located in Zinda Jan district of Herat province.

29. The Herat Province is one of the larger and more prosperous regions of the country (Figure 2). Located in the west and adjacent to both Iran and Turkmenistan, it has benefitted from a prosperous agricultural sector as well as access to reasonably priced electricity supply imported from both neighbours. Its total population was estimated at 1.89 million in 2015, with over 70 percent located in rural areas. According to the 2013/2014 Afghanistan Living Condition Survey (ALCS), 36 percent of employment was in agriculture, 27 percent in services, and 21 percent in construction. In the same survey, 60 percent of households reported having access to grid-based electricity supply. Apart from grid-connected customers, an additional one-third of the households reported having some form of off-grid supply, primarily based on renewables such as mini-hydro and small solar systems, raising the total proportion of houses having access to some form of electricity supply to 93 percent. Figures 3 and 4 and 5 are showing the Pol-e-Hashimi substation land picture and location on GIS.

Figure 2: Herat province districts map



Figure 3: Photo of Pol-e-Hashimi substation land



Figure 4: Photo of Pol-e-Hashimi substation land



Figure 5: Pol-e-Hashimi substation location on GIS

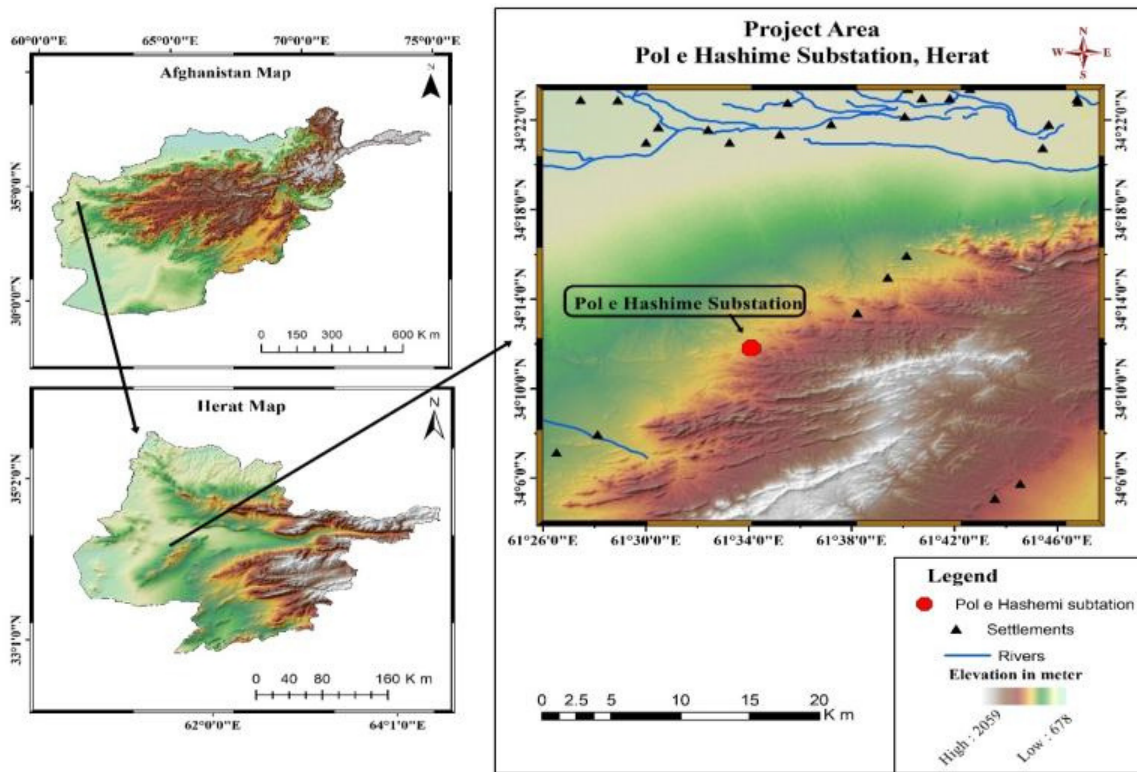

8 Methodology

30. Present due diligence assessment was conducted based on available documents, site visits and consultation with local people, provincial government officials and stakeholders. The methodology applied in preparation of the DDR for this project is enumerated as follows:

(i) The scope of the project was studied including the technical details of the project by and had discussions with the PMO officers, and the relevant members of the team on the scope of works of the project. By not having the detailed design at this stage, the 73,669.68 sqm land has been determined based on the preliminary design report.

(iii) Field visits were made by land committee which reported that 73,669.68 sqm area selected for Pol-e-Hashimi substation is 100 % governmental land with no livelihood activities (Figures 3 and 4).

(vi) The DDR preparation work commenced with the field visits and discussion with the relevant governmental organizations; on land ownership and approvals by various local governmental organizations to undertake the project works.

(v) This DDR was then prepared by assimilating the feasibility report, findings of the field visits, and discussions with relevant government officials, people from the adjacent villages, and information gathered during consultation conducted by assigned committee according to Afghanistan Land Acquisition Law and procedures regulation as well as ADB requirements.

9 Field visits and Stakeholder and/or Public Consultation

31. An initial field visit was carried out and the resettlement screening and indigenous people screening was done (Table 2). Since there were no impacts of resettlement and indigenous people; the study was continued for a due diligence with further field visits and consultations with local authorities and communities. The result of field visit indicated/resulted that land allotted for the substation is free from any LAR issues.

Table 2: Involuntary Resettlement Screening Checklist

SOCIAL SAFEGUARD DUE DILIGENCE REPORT (DDR)

CONSTRUCTION OF TWO INCOMING LINE BAYS IN 220/32/20 kV POL-E-HASHIMI SUBSTATION

Probable Involuntary Resettlement Effects	Yes	No	Not Known	Remarks
Involuntary Acquisition of Land				
1. Will there be land acquisition?		√		Land acquisition for the DDR area of non-LAR impact area is not needed.
2. Is the site for land acquisition known?	√			It is not privately owned.
3. Is the ownership status and current usage of land to be acquired known?	√			The land plot is government owned property.
4. Will easement be utilized within an existing Right of Way (ROW)?	√			As the non-LAR impact area is government owned land, so easement can be utilized any time.
5. Will there be loss of shelter and residential land due to land acquisition?		√		There is no shelters and residential land within the identified and allotted land
6. Will there be loss of agricultural and other productive assets due to land acquisition?		√		The non-LAR area is not cultivated and does not have any types of products.
7. Will there be losses of crops, trees, and fixed assets due to land acquisition?		√		There was no trees and other assets and were not seen any crops growing.
8. Will there be loss of businesses or enterprises due to land acquisition?		√		The identified and allocated land was seen without any businesses.
9. Will there be loss of income sources and means of livelihoods due to land acquisition?		√		Since the identified and allotted is desert, businesses for income sources were not seen.
Involuntary restrictions on land use or on access to legally designated parks and protected areas				
10. Will people lose access to natural resources, communal facilities and services?		√		The villages or comminutes residential area are a bit for away from the identified and allotted land and their natural resources are close to their villages, so their access to businesses and daily work are not interrupted.
11. If land use is changed, will it have an adverse impact on social and economic activities?		√		Since the allotted land does not have any charges and its government property, no impact on social and economics was seen.
12. Will access to land and resources owned communally or by the state be restricted?		√		Even access to public land and resource were not seen to be restricted by this allotted land identified for the construction of substation.
Information on Displaced Persons:				
Any estimate of the likely number of persons that will be displaced by the Project? If yes, approximately how many? _____				[] No [] Yes [√] Not applicable
Are any of them poor, female-heads of households, or vulnerable to poverty risks?				[] No [] Yes [√] Not applicable
Are any displaced persons from indigenous or ethnic minority groups?				[] No [] Yes [√] Not applicable

32. The land committee visited the areas where the proposed project is to be implemented in Zinda Jan district of Herat province. The committee visited the full placement of the proposed 220//32/20 kV Pol-e-Hashimi substation to ascertain the present land ownership and use for the project. Documents, approving the governmental land ownership and confirming the implementation of the project, were collected from the concerned authorities during the visits. The team members, specified in Para 4, visited the Herat province Governor Office, Department of Land, Department of Agriculture, Department of Irrigation, Department of Culture and Department of Mining to for further discussion and obtaining consent for the land and construction of the substation.

33. A consultation meeting was held with the relevant stakeholders in Zinda Jan district governor office on November 5, 2019. A number of elders, villagers were also called to the meeting (Table 3). The objectives of the meeting was to share the project relevant information with stakeholders and understand their concerns. The information shared included project activities, proposed Poli Hashimi substation. They were briefed about the 220/32/20 kV substation project and selection of land located closed to their villages. They were also notified in relation to the benefit of this project and distribution of reliable power to their villages once the substation is completed and energized. The elders and Head of Shura collectively agreed with land selected/allotted for the substation and confirmed that the land is barred and non-cultivated (Figure 6). They were also showing happiness for construction of the substation and certified that we will not be affected at any means. They propose employment of skill and unskilled labor from their villages during construction of the project if possible. The elders also confirmed that civil work plus installation of electrical equipment in the allotted substation land have zero impact on the outside of the substation area. Participants were pleasant, they hope that this substation will fulfil their problems in terms of electricity shortage and load shedding. The below Table 3 is showing list of people attended the meeting.

SOCIAL SAFEGUARD DUE DILIGENCE REPORT (DDR)

CONSTRUCTION OF TWO INCOMING LINE BAYS IN 220/32/20 KV POL-E-HASHIMI SUBSTATION

Table 3: Attendances Sheet of Public Consultation Meeting dated 5/Nov/2019

لیست مشورین جلسہ تاریخی ۱۳ عقرب ۱۳۹۸ مطابق ۵. NOV. 2019

شماره	اسم	قریہ	موقف	مقام
۱	شکر اللہ شاکر	ولسوالی زندجان	ولسوال	راہ افشاہ
۲	احمد شاہ	کبوتر خان	کمان قوم	راہ افشاہ
۳	حاجی محمد شاہ فقیری	کبوتر خان	کمان قوم	راہ افشاہ
۴	ارباب بسم اللہ	رباط افغانھا	کمان قوم	راہ افشاہ
۵	حاجی عبدالرشید	سگھر خان	معلم	راہ افشاہ
۶	حاجی غلام محی الدین	قیلہ ناک	دھقان	راہ افشاہ
۷	حاجی عبدالظاهر	دہ سرخ	دھقان	راہ افشاہ
۸	ارباب وکیل احمد	گاو سیاہ	کمان قوم	راہ افشاہ
۹	عبدالرسول	بایان	دھقان	راہ افشاہ
۱۰	عبدالبعیر	رباط افغانھا	دھقان	راہ افشاہ

Translation of the above attendance sheet

S/No	Name	Village	Position
1	Shukrullah Shakir	Zinda Jan district	District Governor
2	Ahmad Shah	Kabotar Khan	Elder
3	Haji Muhammad Shah Faeqeri	Kabotar Khan	Elder
4	Arbab Bismillah	Rabat Afghan Ha	Elder
5	Haji Abdur Rashid	Saghar Khan	Teacher
6	Haji Ghulam Mahiuddin	Qilla Nok	Former
7	Haji Abdul Zahir	De Surkh	Former
8	Arbab Wakeel Ahmad	Gaw Eseyah	Elder
9	Abdul Rasool	Bahyan	Former
10	Abdul Baseer	Rabat Afghan Ha	Former

Figure 6: Consultation meeting with district governor and local people



10. Grievance Redress Mechanism and Project Institutional Arrangements

34. A grievance redress mechanism has been established and available at project site locations. DABS has formed grievance redress committees (GRCs) to address project grievances. The chairman and members designated from the concerned departments and local communities for the GRCs for the subproject in order to receive and facilitate the resolution of peoples' concerns, and grievances about the project's activities. Each GRC is composed of the following members:

<input type="checkbox"/> Representative of the District Governor	In-Chair
<input type="checkbox"/> Representative from the Security HQ	Member
<input type="checkbox"/> Representative from Land Department	Member
<input type="checkbox"/> Representative from Provincial Council	Member
<input type="checkbox"/> Representative of DABS Office from concerned	District Member
<input type="checkbox"/> Representative from CSC (Local Resettlement Specialist)	Member
<input type="checkbox"/> Affected persons appointed by Representatives	Member

35. The committees will be chaired by the representative of the concerned District Governor or his representative. Grievances will be sent in written form to the committee and will be heard and resolved within 21 days of submission of the complaint.

36. The safeguards unit of DABS and supervision consultant will conduct monitoring of project implementation activities and ensure effectiveness of GRM. In case, if any unanticipated impact will be identified during project implementation (construction period), DABS will stop construction works in areas for unanticipated impact areas until corrective

action plan is prepared and implemented in accordance with the latest land acquisition and resettlement framework (LARF) for all MFF subprojects which work for this .

37. Semi-annual and annual social safeguards monitoring reports will be prepared and submitted for ADB review and further disclosed. These social safeguards monitoring reports shall provide summary of all social grievances or other relevant issues on this subproject.

10 The Issue of Encroachers

38. During the filed visit conducted by the team stated in Para 4, no livelihood activity has been identified and no encroachers have been observed within the compound of the land allocated for the subject substation.

11 Conclusions

The review concludes that:

39. As per the findings of due diligence study and detailed feasibility study documents neither permanent nor temporary impact to households, farmers and private legal entities are expected due to the construction of 220/32/20 kV substation and the two incoming line bays to be constructed within the compound of this substation. There will be no impact regarding land acquisition and no physical/economic displacement that may trigger involuntary resettlement.

40. One of the conditions for the release of final payment to the civil works contractors is the submission of proof that DDR followed and neither permanent nor temporary impact has been observed during the construction period. If there is unanticipated impacts, then, temporarily used lands should fully restored to their pre-project conditions.

41. Civil work plus installation of electrical equipment in the allotted substation land have zero impact on the outside of the DDR area allotted for construction of the subject substation.

42. The DABS will be responsible for documenting monitoring reports on DDR completion reports through its PMU/PIC to ADB for review on the semi-annual basis.

43. As per the official documents attached as Annex 1, the identified and selected land (Figure 1) is government owned property which has been formally allotted to DABS for construction of substation and two incoming line bays.

44. The land plot of the substation is entirely free from any LAR issues (Figure 3 and 4). No structures, crops or trees will be affected by the construction of the subject substation.

45. Activities relating to possession of land and the construction of substation have not been started as yet at the site.

46. During the field visit conducted by the team specified in Para 4, no encroachers have been observed within the compound of land allocated for Pol-e-Hashimi substation.

47. The field visit as well as consultation with people from neighboring villages and other stakeholders plus district government official resulted that the substation construction does not have any social and livelihood impact and the substation land is free from any LAR issues and agriculture activities.

Annex 1: Land documents showing the ownership of government land allotted to Pol-e-Hashimi substation

Annex 1.1: Formal letter from Herat governor office to MUDL provincial department

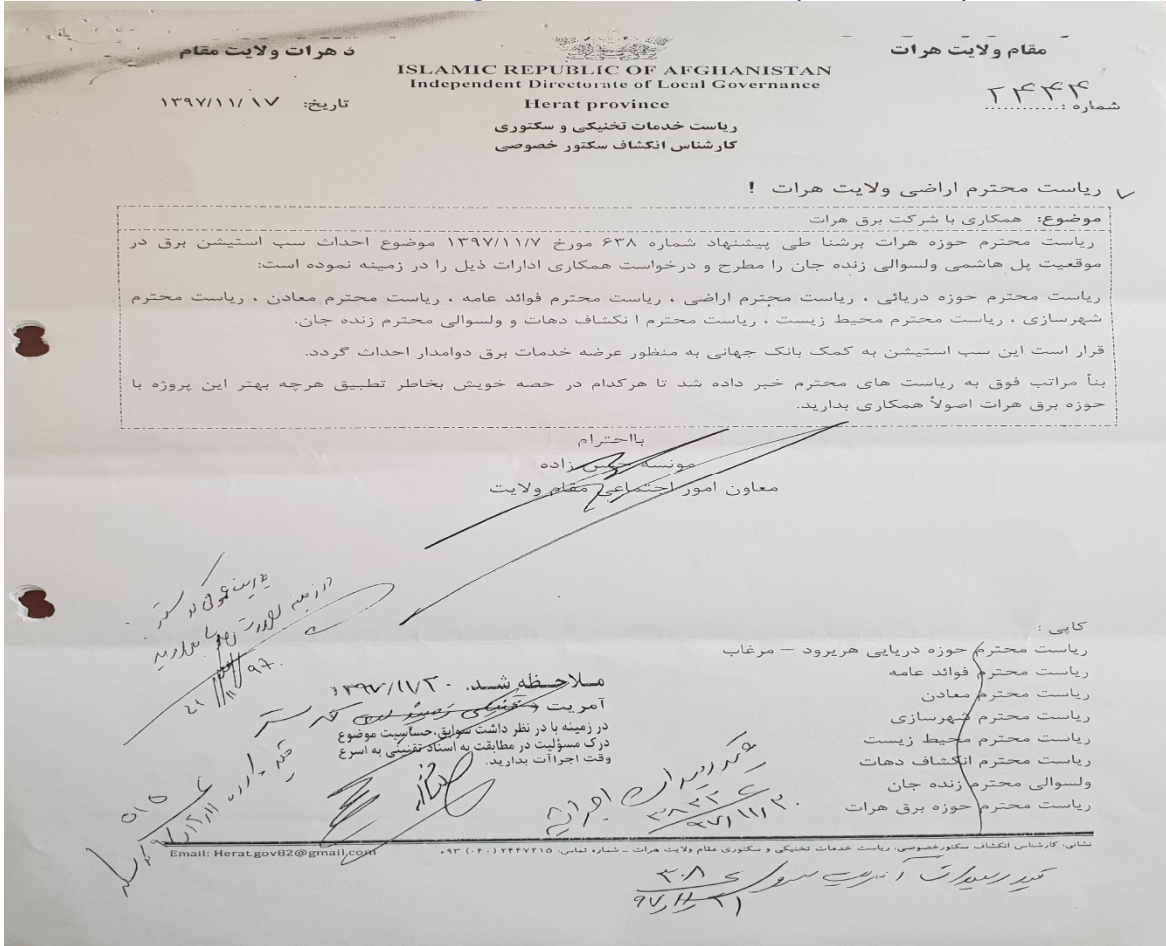

Annex 1.1: Translation of formal letter from Herat governor office to MUDL provincial department

Islamic Republic of Afghanistan
Independent Directorate of Local Governance
Herat Province
Technical and Sectorial Services Authority
Private Sector Development Expert

Ref#: 2444

Date: 06, Feb, 2019

To Herat Land Authority,

Sub: Cooperation with Herat Local DABS

Herat Local DABS through request letter No 638 dated: 06, Feb, 2019, has requested for cooperation of the following organizations in construction of substation in Pule Hashemi Zenda Jan district.

Harirod River Region Directorate, Land Directorate, Public Works Directorate, Mines Directorate, Urban Development Directorate, Environment Directorate, Rural Development Directorate and Zenda Jan District Government.

This substation construction is going to be financed by World Bank to provide sustainable power.

Regards
Mounesa Hasanzada
Governor Deputy of Social Affairs
{Signed}

Annex1.2: Formal letter from DABS' Herat Branch to Governor Office

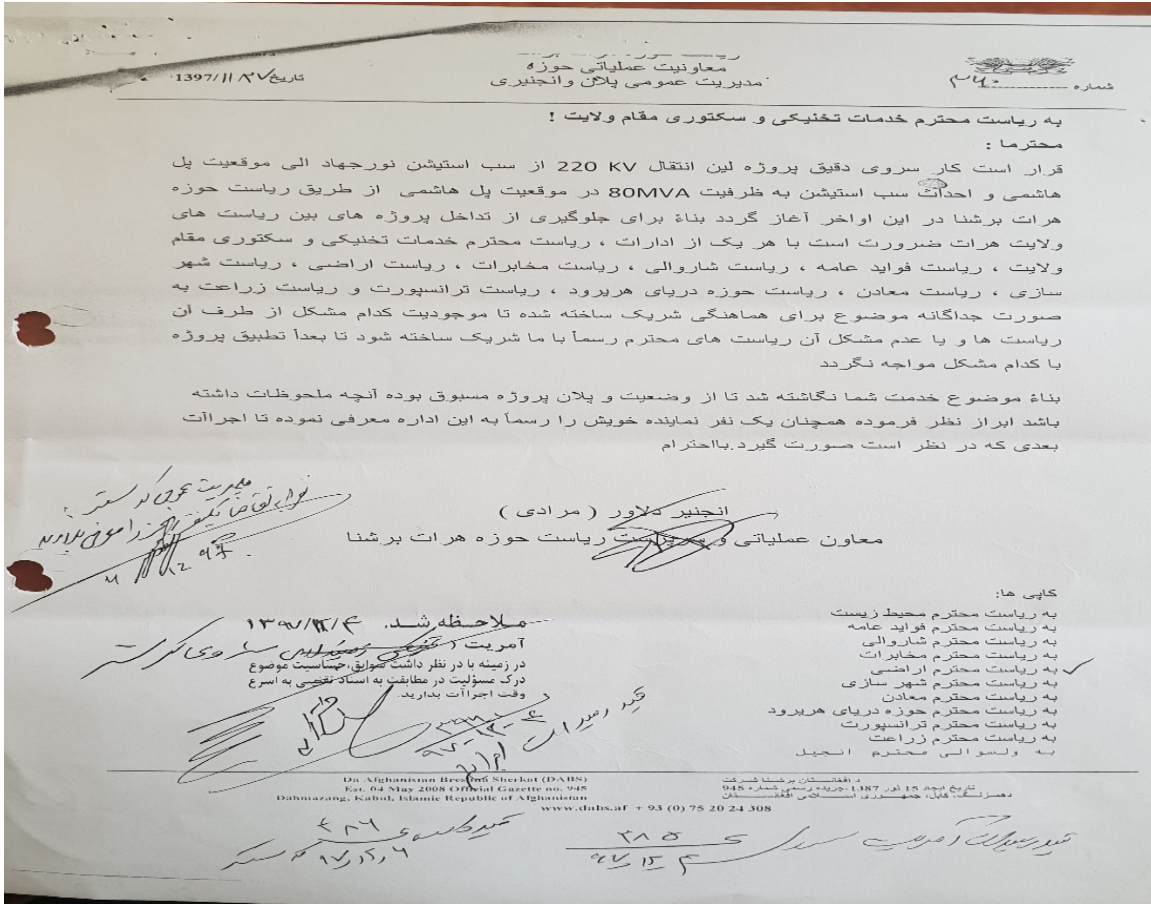

Annex 1.2: Translation of the formal letter from DABS' Herat Branch to Governor Office

Herat Zone DABS
Zone Operational Directorate
Plan and Engineering General Office

Ref#: 360

Date: 16/Feb/2019

To Herat Government Technical and Sectorial Services Authority,

Recently Regional Department of DABS is planning to start detail survey of 220 kV transmission line project from Nourul Jahad substation to Pule Hashimi as well as construction of substation with 80 MVA capacity in Pule Hashemi. Therefore, in order to for better coordination with other projects to be implemented in Herat province, the subject matter should be shared individually with each organizations including Herat Government Technical and Sectorial Services Directorate, Public Works Directorate, Municipality, Telecommunication Directorate, Land Directorate, Urban Development Directorate, Mines Directorate, Harirod River Directorate, Transportation Directorate and Agriculture Directorate. The matter is therefore sharing with the said departments for coordination and to make sure that if there is any issue the respected department would share with us in order to not face with any problem during implementation of the said projects.

Therefore, you are kindly informed about the project plan and status and your comments will be welcomed - you are kindly requested to introduce your representative to us for further executions.

Engr. Delawar Muradi
Deputy and Acting Head of DABS Regional Department, Herat
{Signed}

To Cadaster General Office: 23/Feb/2018
Based on the request,
Please introduce one Engr.
{Signed}

To Cadaster Survey Land Affairs Directorate: 23/Feb/2019
Considering the background execute according to the law.
{Signed}

Copies to:
Environment Department
Public Works Department
Municipality
Telecommunication Department
Land Department
Urban Development Department
Mines Department

Harirod River Regional Department
Transport Department
Agriculture Department
Angil District

Annex 1.3: Formal letter from Survey and Cadaster department to Herat DABS' Branch

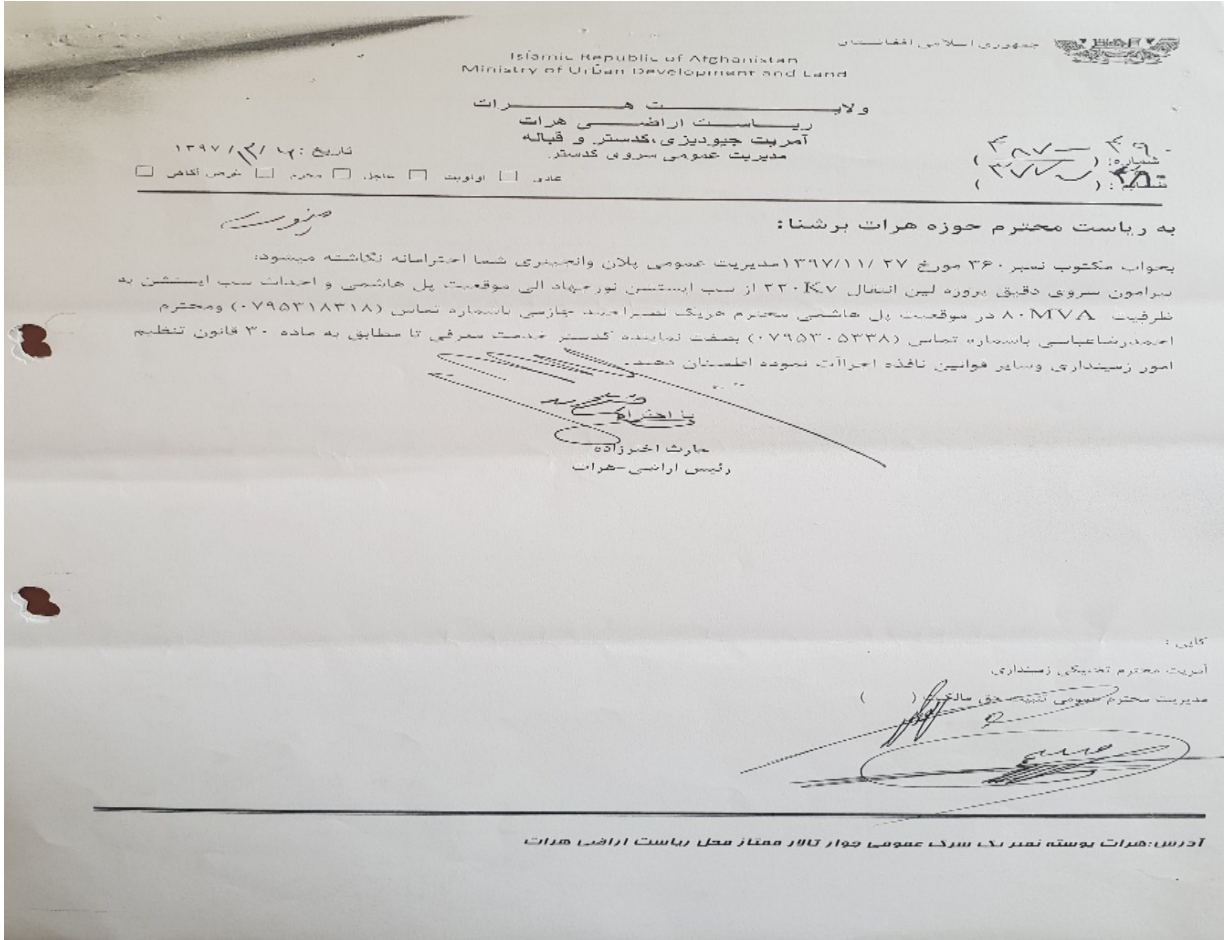

Annex 1.3: Translation of Formal letter from Survey and Cadaster department to Herat DABS' Branch

Islamic Republic of Afghanistan
Herat Land Authority
Geodesy, Cadaster and Deed Directorate
Cadaster Survey General Office

Ref#: 487—490
377---380

Date: 25, Feb, 2019

To Herat Zone DABS,

SOCIAL SAFEGUARD DUE DILIGENCE REPORT (DDR)
CONSTRUCTION OF TWO INCOMING LINE BAYS IN 220/32/20 KV POL-E-HASHIMI SUBSTATION

This is to reply your Plan and Engineering General Office letter No (360) dated 16/Feb/2019.

Hereby Mr. Naseer Ahmad Jazemi with Contact # (0795318318) and Mr. Ahmad Riza Abbasi with Contact#(0795305338) are introduced to you as Cadaster representatives for cooperation and construction of substation in Pule Hashemi of Zenda Jan district to execute in accordance with Land Affairs Law article 30 as well as other relevant laws and regulations and ensure us accordingly.

Regards,
Haris Akhtarzada
Head of Herat Land Department
{Signed}

Annex 1.4: Formal letter from MUDL provincial department to Herat governor office

SOCIAL SAFEGUARD DUE DILIGENCE REPORT (DDR)

CONSTRUCTION OF TWO INCOMING LINE BAYS IN 220/32/20 KV POL-E-HASHIMI SUBSTATION

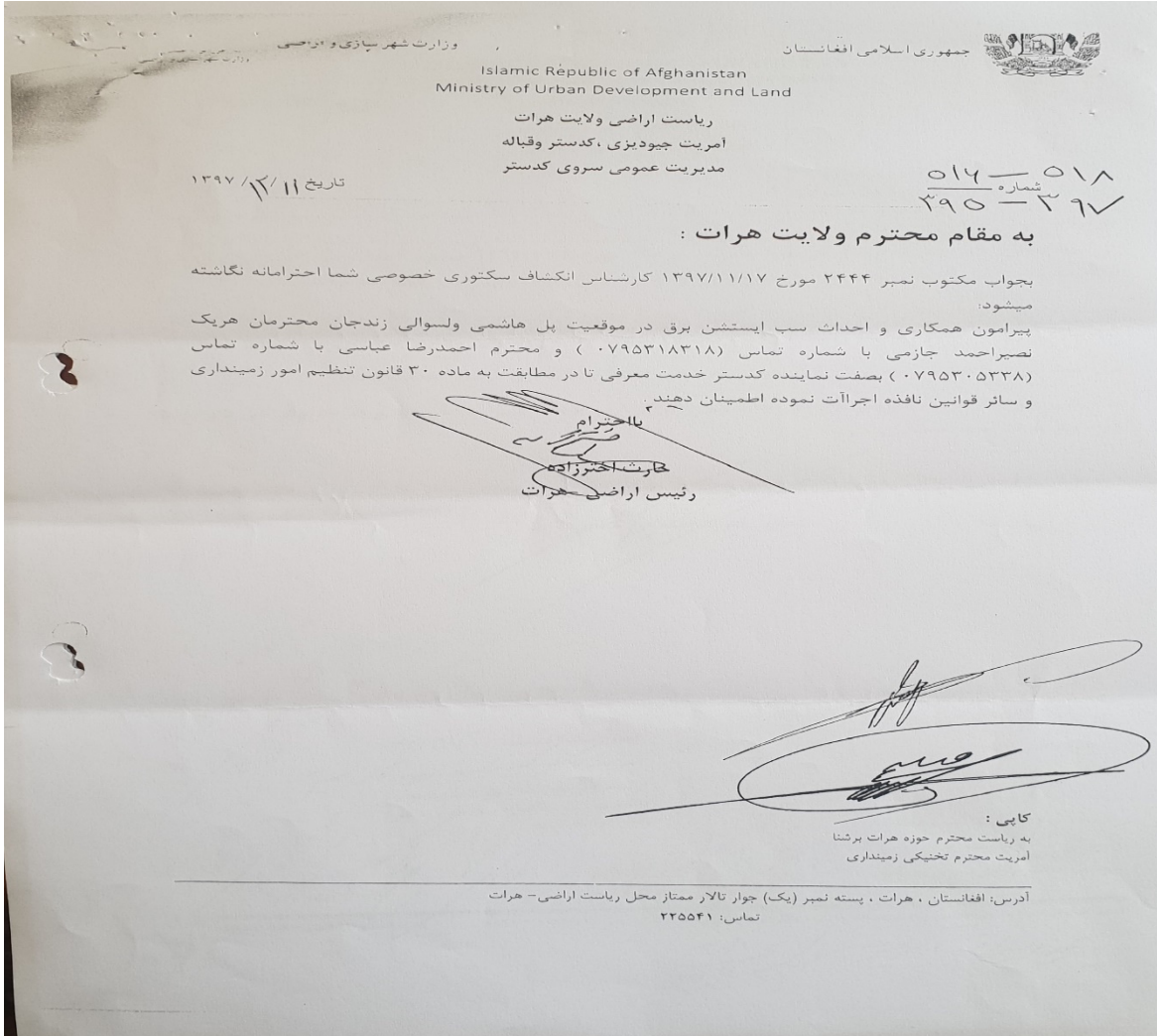

Annex 1.4: Translation of formal letter from MUDL provincial department to Herat governor office

Islamic Republic of Afghanistan
Ministry of Urban Development and Land
Herat Land Authority
Directorate of Geodesy, Cadaster and Deed
Cadaster Survey General Office

Ref #: 516----5
395--397

Date: 02, Mar, 2019

To Herat Government,

This is to reply your Private Sector Development Expert letter No (2444) dated: 06, Feb, 2019.

SOCIAL SAFEGUARD DUE DILIGENCE REPORT (DDR)
CONSTRUCTION OF TWO INCOMING LINE BAYS IN 220/32/20 kV POL-E-HASHIMI SUBSTATION

Hereby Mr. Naseer Ahmad Jazemi with Contact # (0795318318) and Mr. Ahmad Riza Abbasi with Contact#(0795305338) are introduced to you as Cadaster representatives for cooperation and construction of substation in Pule Hashemi Zenda Jan district to execute in accordance with Land Affairs Law article 30 as well as other relevant laws and regulations and ensure us accordingly.

Regards,

Haris Akhtarzada

Head of Herat Land Authority

{Signed}

Annex 1.5: Tasked delegation report to Survey and Cadaster department.

SOCIAL SAFEGUARD DUE DILIGENCE REPORT (DDR)

CONSTRUCTION OF TWO INCOMING LINE BAYS IN 220/32/20 KV POL-E-HASHIMI SUBSTATION

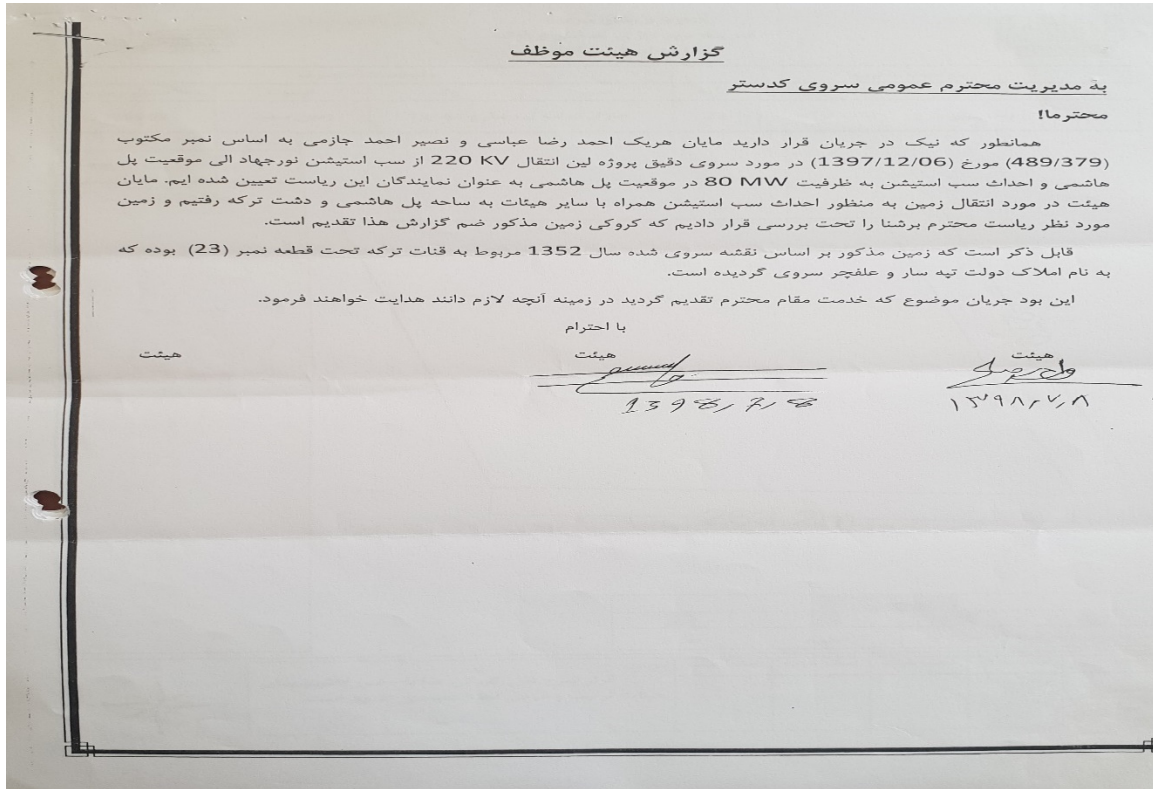

Annex 1.5: Translation of the tasked delegation report to Survey and Cadaster department.

Report of the assigned committee

To Cadaster Survey General Office

Dear Sir,

As you well know, we, Ahmad Riza Abbasi and Naseer Ahmad Jazemi based on letter No (379/489) dated: 25, Feb, 2019 were assigned as representatives of this Authority for detail survey of 220kv transmission line project from Nourul Jahad substation to Pule Hashemi location as well as construction of substation with 80 MW capacity at Pule Hashemi. We and the other committee went to Pule Hashemi and Dashte Taraka district, visited and evaluated the land for handover for construction of substation and prepared the croquis (sketch) which attached to this report.

It is remarkable to state that, according to survey map of 1973, the above mentioned land is under lot number (23) which has been surveyed as State owned hill and pasture land.

The report is kindly presented to you for further executions.

Regards,

SOCIAL SAFEGUARD DUE DILIGENCE REPORT (DDR)
CONSTRUCTION OF TWO INCOMING LINE BAYS IN 220/32/20 KV POL-E-HASHIMI SUBSTATION

Islamic Republic of Afghanistan
Ministry of Urban Development and Land
Herat Land Authority
Directorate of Geodesy, Cadaster and Deed
Cadaster Survey General Office

Ref #: 1592/1037

Date: 21, Oct, 2019

To teh Technical Land Affairs Directorate,

Dear Sir,

Herewith the copy of the report as well as the croquis (sketch) along with (4) sheets of background and cooperation related document in regard to construction of power substation at Pule Hashimi of Zenda Jan district are sent to you to execute in accordance with land affairs arrangement law as well as other relevant laws.

Regards,

Engr. Abubakr Rahimi

Acting Head of Geodesy, Cadaster and Deed

{Signed}

To Land Arrangement and Distribution Office,
Please execute in accordance with law and regulations.

{Signed}

26, Oct, 2019

Annex 1.7: Cadaster sketch of Pol-e-Hashimi substation land

SOCIAL SAFEGUARD DUE DILIGENCE REPORT (DDR)

CONSTRUCTION OF TWO INCOMING LINE BAYS IN 220/32/20 KV POL-E-HASHIMI SUBSTATION

اداره اراضی مریه
امریت جیوڈیزی، گدستر و قبائل
خوریہ سرری سادات

مشخصات متصرف				موقعیت ملکیت			
مساحت (متر مربع)	نوعیت	ولد	اسم	قلمه	قریہ / ناحیہ	ولسوالی	ولایت
66439	زمین سفید	املاک دولت تپہ سار و علفچر		23	قنات ترکہ	زندہ جان	ہرات
تاریخ		شماره					
1398/05/12		1					

ملاحظات

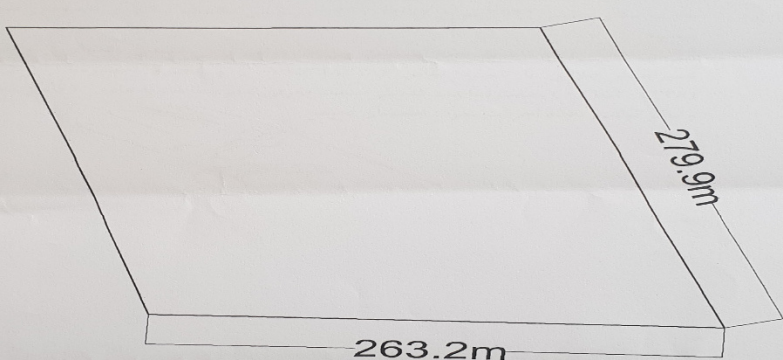

حدود زمین ملکیت				
شمال	جنوب	شرق	غرب	سرک و حریم سرک
				سول بر

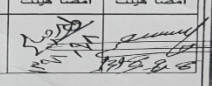

توضیح: قرار شرح فوق کروکی هذا با حضور داشت سایر هیئات ترتیب و غرضی اجراءات بعدی تقدیم است.

امضا هیئت	امضا هیئت	امضا هیئت	امضا هیئت	امضا هیئت
				

Annex 1.7: Translation of Cadaster sketch of Pol-e-Hashimi substation land

Sites Survey Form

Identification of the acquirer				Location of the land			
Area	Type of land	F/Name	Name	Lot	Village	District	Province
73,669.68	Blank land	State owned hill and pasture		23	Qanat Tarka	Zenda Jan	Herat
Date	No						
03, Aug, 2019	1						

Remarks

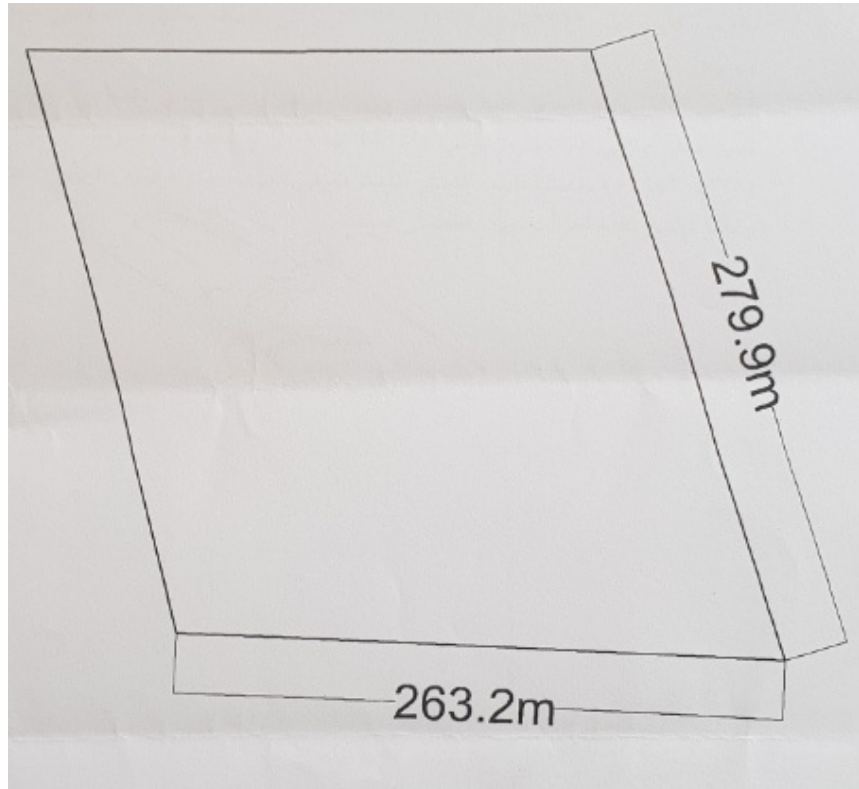

Land boundary			
West	East	South	North
flood path	flood path	Blank land	Road and road right of way

The croquis was prepared in presence of other committee and submitted to you for further process	Signature of the committee	Signature of the committee	Signature of the committee	Signature of the committee	Signature of the committee
				Signed	Signed

Annex 1.8: Formal letter from MUDL provincial department to MUDL HQ

SOCIAL SAFEGUARD DUE DILIGENCE REPORT (DDR)

CONSTRUCTION OF TWO INCOMING LINE BAYS IN 220/32/20 KV POL-E-HASHIMI SUBSTATION

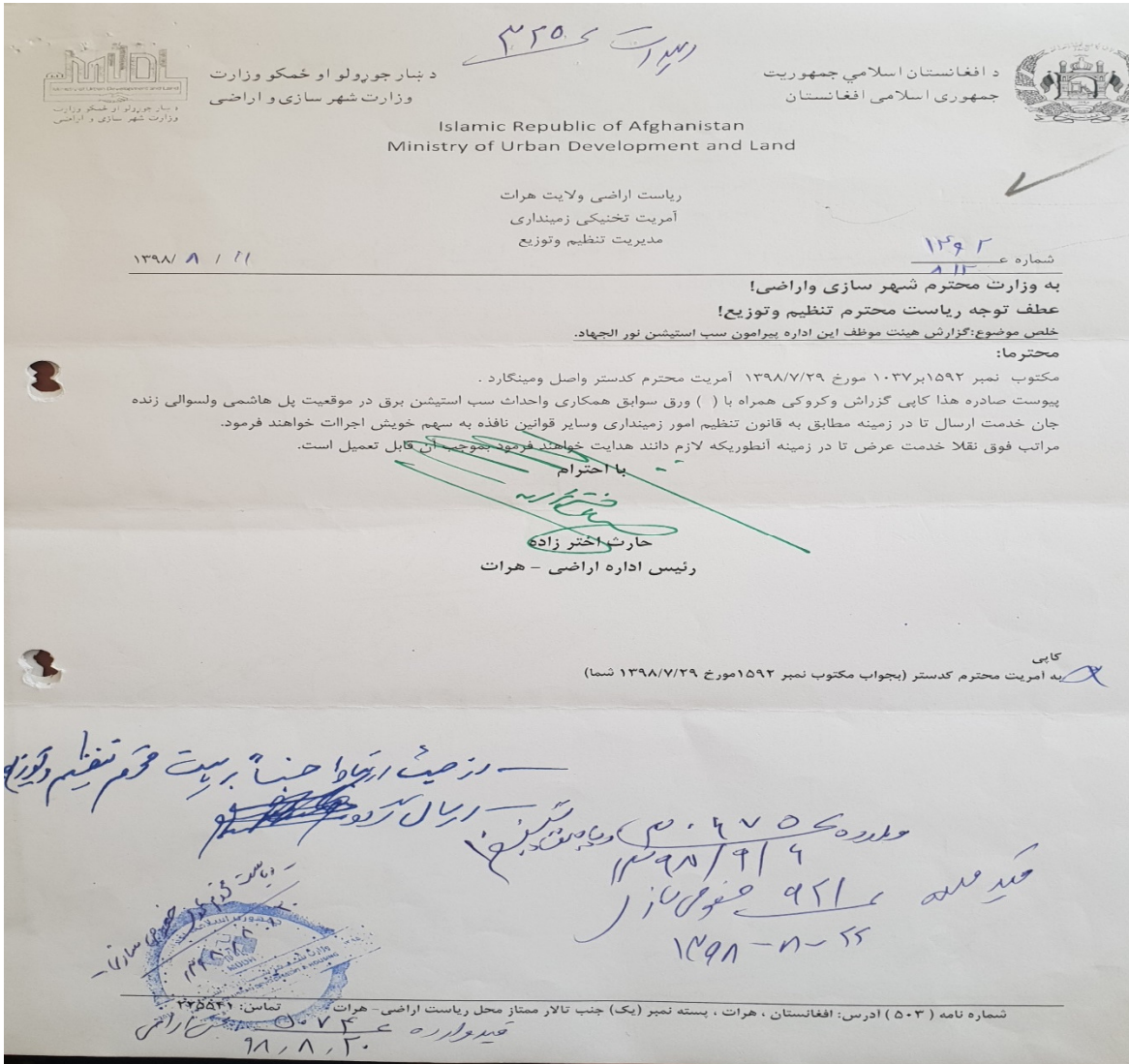

Annex 1.8: Translation of formal letter from MUDL provincial department to MUDL

Islamic Republic of Afghanistan
Ministry of Urban Development and Land
Herat Land Authority
Land Affairs Technical Directorate
Arrangement and Distribution Office

Ref #: 1492/812

Date: 02, Nov, 2019

To Ministry of Urban Development and Land,
Attention: Arrangement and Distribution Authority,

Sub: Report of the assigned committee on Nourul Jahad substation

SOCIAL SAFEGUARD DUE DILIGENCE REPORT (DDR)
CONSTRUCTION OF TWO INCOMING LINE BAYS IN 220/32/20 KV POL-E-HASHIMI SUBSTATION

Dear Sir,
Directorate of Cadaster submitted the letter No 1592/1037 dated: 21, Oct, 2019 which stated as below:

Herewith the copy of the report as well as the croquis along with () sheet background document of cooperation and construction of power substation at Pule Hashimi Zenda Jan district are sent to you to execute in accordance with land affairs arrangement law as well as other relevant laws.

The subject matter quoted to you, thus, you would kindly instruct as required.

Haris Akhonzada
Head of MUDL Provincial Department
{Signed}

SOCIAL SAFEGUARD DUE DILIGENCE REPORT (DDR)
CONSTRUCTION OF TWO INCOMING LINE BAYS IN 220/32/20 KV POL-E-HASHIMI SUBSTATION