

Resettlement Plan

Document stage: Draft for Consultation
Project Number: 49107-005
June 2019

IND: Proposed Tamil Nadu Urban Flagship Investment Program (Tranche 2) - Tiruchirappalli Underground Sewerage System Phase III PART B

Prepared by Tiruchirappalli City Municipal Corporation, Government of Tamil Nadu, for the Asian Development Bank.

This resettlement plan is a document of the borrower. The views expressed herein do not necessarily represent those of ADB's Board of Directors, Management, or staff, and may be preliminary in nature.

Photographs of Affected Persons facing Potential Temporary Impacts – Tiruchirapalli

65. Thomas Thangaraj – M 9791650359



66. Selvam – M 99656 35264



67. Ganesh K – M 99425 26002



68. Raja – M 81442 27976



69. Akbar – M 97875 39173



70. Kalaigananar



71. Ramasamy – M 95788 97097



Photographs of Affected Persons facing Potential Temporary Impacts – Tiruchirapalli

72. Anbalagan P – M 89032 93232



73. Mohanraj – M 94434 38746



74. Rajendran – M 0431 - 2473954



75. Ganesan – M 95663 21957



76. Sivakumar A – M 99949 07020



77. Absentee



78. Absentee



79. Absentee



LAND DETAILS

S.No	Component		Land				Proposals			Set backs	Outside Land
	(SPS)	Location	Ownership	Classification	Available	Required	Modules	Pathways	Green Belts	Within the Land	
1	SPS5	Indira Nagar, Ponmalai	Corporation	Park Site	2000 Sq.m	999.16 Sq.m	715.42 Sq.m	222.55 Sq.m	48.18 Sq.m	2.5m from the well on the North side, 38.91m on the west side, 6.86m on the south side and 10.65m on the Eastern side.	Residences and existing road are found on south of the site which is about 10m, In Northern side is Kilivaikal. EMP has provisions for buffer zones and odour control technology will be adopted.
2	SPS7	Lurdhu Nagar (JK Nagar Extension)	Corporation	Park Site	18.93 Hectre	789.65 Sq.m	419.02 Sq.m	198.76 Sq.m	171.07 Sq.m	21.43m from the well on the North side, 4.65m on the west side, 2.50m on the south side and 14.58m on the Eastern side.	Residences are found on North and west side of the site which is about 50m , 27m respectively. In South and east side is vacant land. EMP has provisions for buffer zones and odour control technology will be

S.No	Component		Land				Proposals			Set backs	
	(SPS)	Location	Ownership	Classification	Available	Required	Modules	Pathways	Green Belts	Within the Land	Outside Land
											adopted.
3	SPS8	Vimar Vihar, Kulavaipatty	Corporation	Park Site	614 Sq.m	307 Sq.m	307 Sq.m	-	-	4.7m on the north side, 4.08m from the south side, 12.38m from the east side and 1.60m from the west side from the well	There are no houses close by. There is a school is found on Northern side of the site which is about 90m. EMP has provisions for buffer zones and odour control technology will be adopted.
4	SPS9	Muthu Kumaraswamy nagar, K.Sathanur	Corporation	Park Site	1.15 Hectre	1200 Sq.m	757.13 Sq.m	326.00 Sq.m	116.87 Sq.m	6.69m away from the well on the north, 16.71m from the south side, 24.6m on the east side of the well and 3.3m from the west side.	Residences are found on eastern side of the site about 15m. EMP has provisions for buffer zones and odour control technology will be adopted. In other three sides are Vacant land of the site.

S.No	Component		Land				Proposals			Set backs	
	(SPS)	Location	Ownership	Classification	Available	Required	Modules	Pathways	Green Belts	Within the Land	Outside Land
5	SPS10	Inside of Existing STP campus, Panjapur	Corporation	Trichy Corporation	794 Sq.m	794 Sq.m	395 Sq.m	225 Sq.m	89 Sq.m	12.81m on the north side, 21.6m on the west and 5.59m on the south side, 3.81m on the east side.	Residences are found on South west side of the site is more 100m.
6	SPS11	Gasifier Crematorium, Karumandapam	Corporation	Trichy Corporation	0.23 Hectare	1295 Sq.m	812 Sq.m	310 Sq.m	173 Sq.m	7m on the north side, 2.5m on the west and 10m on the south side, 22m on the east side.	Residences are found on Western side about 50m and Eastern side is Existing road. EMP has provisions for buffer zones and odour control technology will be adopted. In the Northern side is Micro compost yard, In the Southern side is gasifier crematorium.
7	SPS12	Natchatra nagar, Karumandapam	Corporation	Park Site	1230 Sq.m	915.72 Sq.m	583.19 Sq.m	262.62 Sq.m	69.91. Sq.m	6.44m on the north side, 3.39m on the west and 17.84m on the south side, 25.7m on the east side.	Residences are found on Eastern side of the site about 20m. EMP has provisions for buffer zones and

S.No	Component		Land				Proposals			Set backs	
	(SPS)	Location	Ownership	Classification	Available	Required	Modules	Pathways	Green Belts	Within the Land	Outside Land
											odour control technology will be adopted. In other three sides are vacant land of the site.

Note: Consultations for all SPS sites will be conducted after the elections are concluded. Minutes of meetings will be appended to the updated resettlement plan, prior to start of construction.

SPS 3A (SPS 5)

இ. எண்: 59: திருவரம்பூர்.

39

1	2	3	4	5	6	7	8	9	10	11	12
63	4E	63-4E	ர	பு	...	4-3	6	4 32	0 02.0'	0 09	41 மு. அரசன்.
	5A	+5A	ர	பு	...	4-3	6	4 32	0 06.0'	0 24	40 ரெ. அங்குத்து.
	5B	-5B	ர	பு	...	4-3	6	4 32	0 03.5	0 14	676 மு. கணேசன்(1), மு. திரு ஞானம் (2).
	5C	-5C	ர	பு	...	4-3	6	4 32	0 03.0	0 13	355 செ. நேட்சன்.
	6A	-6A	ர	பு	...	4-3	6	4 32	0 01.5	0 06	326 மு. திருஞானம்.
	6B	-6B	ர	பு	...	4-3	6	4 32	0 01.5	0 06	119 கு. கணேசன்.
	6C	-6C	ர	பு	...	4-3	6	4 32	0 03.5	0 14	767 ச. ராம மற்றும் நான்கு பேர்களும். *
	7	-7	ர	பு	...	4-3	6	4 32	0 07.0	0 30	678 பெ. கப்பிர மணியன் (1), ச. துரைராஜ் (2).
									0 53.5	2 23	
64	1	64-1	ர	த B	...	4-3	6	17 59	0 96.0	16 89	368 திருவரம்பூர் பேரூராட்சி நிர்வாக அதிகாரி.
	2	-2	அ	புற	0 00.5
									0 96.5	16 89	வாய்க்கால்.
→ 65	1A	65-1பா, 2A,3A2	ர	த B	...	4-3	6	17 59	0 20.0	3 52	368 திருவரம்பூர் பேரூராட்சி நிர்வாக அதிகாரி.
	1B	-1பா,2D 3B,3A13, 3A23	ர	த B	...	4-3	6	17 59	0 42.5	7 50	368 திருவரம்பூர் பேரூராட்சி நிர்வாக அதிகாரி.
	1C	-1பா	ர	த B	...	4-3	6	17 59	0 02.5	0 44	453 கா. பொன் மாலா.
	1D	-1பா	ர	த B	...	4-3	6	17 59	0 02.5	0 44	563 நா.ராஜசேகரன்.
	1E	-1பா 3A5	ர	த B	...	4-3	6	17 59	0 02.5	0 44	477 அ. மாரப்பன்.
	1F	-1பா	ர	த B	...	4-3	6	17 59	0 02.5	0 44	679 மு. சந்திர சேகரன் (1), ரா. ஜெம்பு நாதன் (2).

B உய்யக் கொண்டான். வாய்க்கால் பிரிவு மல்லப்ப நாயக்கன் குத்தணை வாய்க்கால் இரண்டாவது வகுப்பு
* விவரப்பட்டியலைப் பார்க்கவும்.

[illegible][illegible]

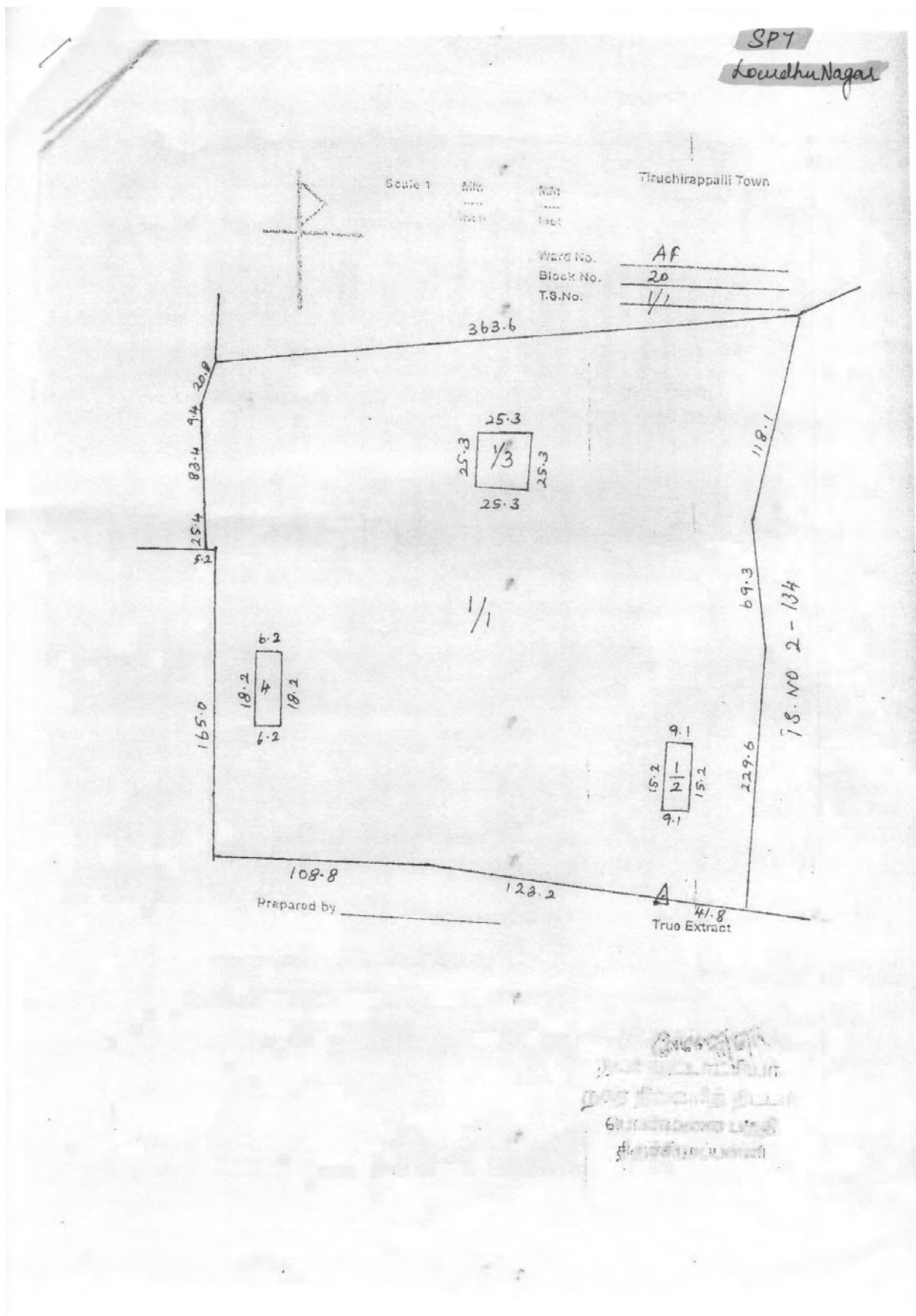

3. DTP Layout drawing and Footprint for SPS-8



4. Field Measurement Book (FMB) Sketch and Footprint for SPS-9

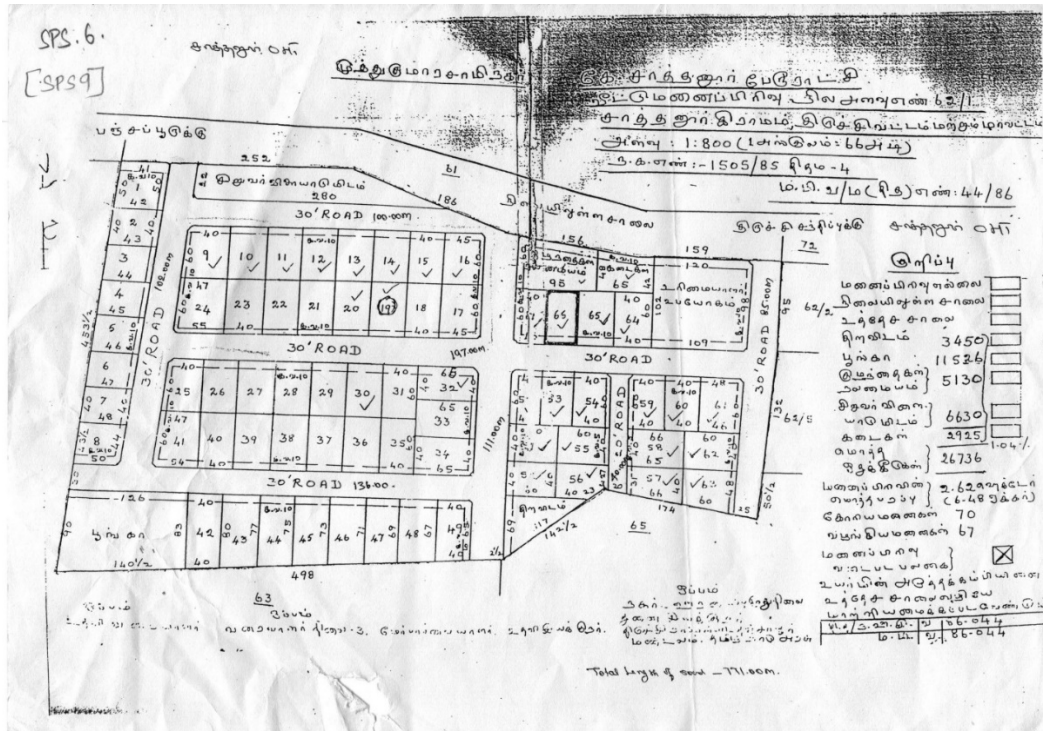

5. Field Measurement Book (FMB) Sketch and Ownership Record of SPS-10



6. Field Measurement Book (FMB) Sketch, Ownership Record and Footprint of SPS-11

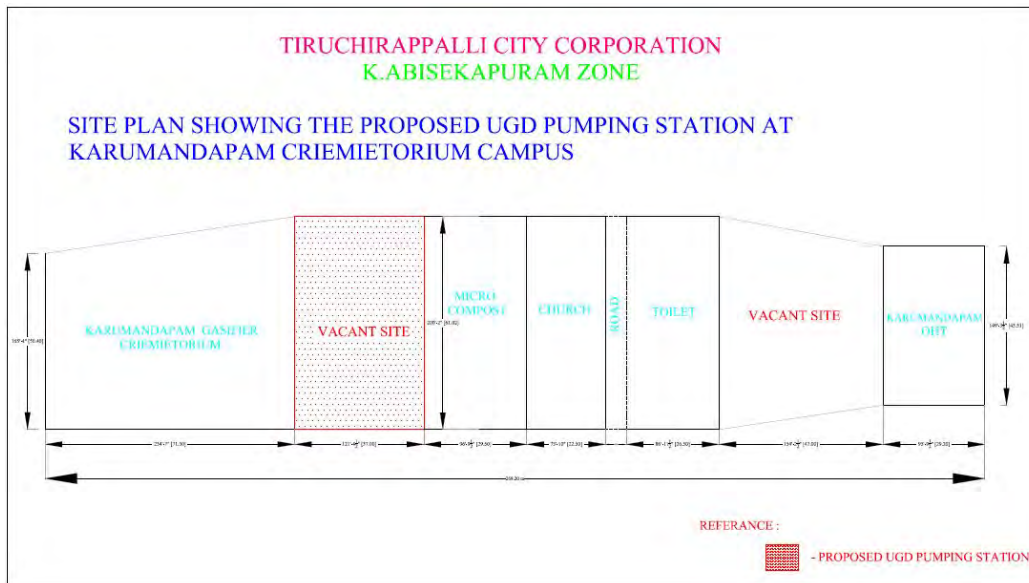

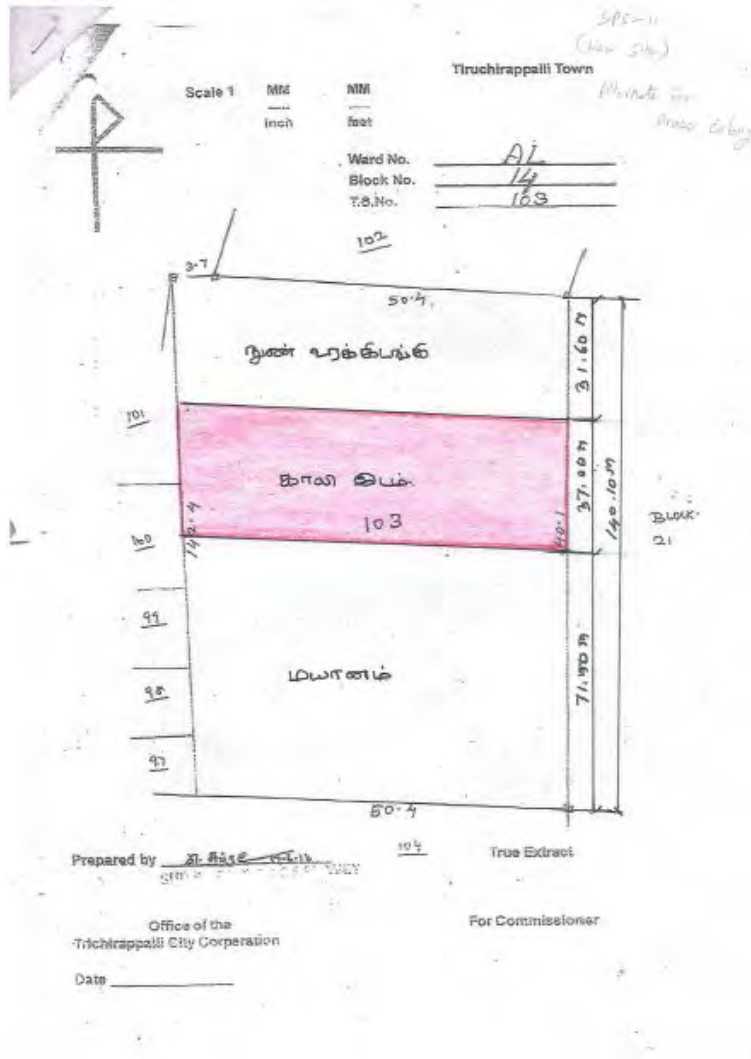

Natchatra Nagan

Tiruchirappalli Town

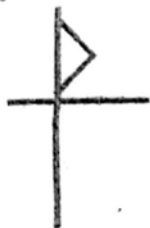

Scale 1 MM MM
 Inch feet

Ward No. AA
 Block No. 1
 T.S.No. 33-5 35-4 39-3

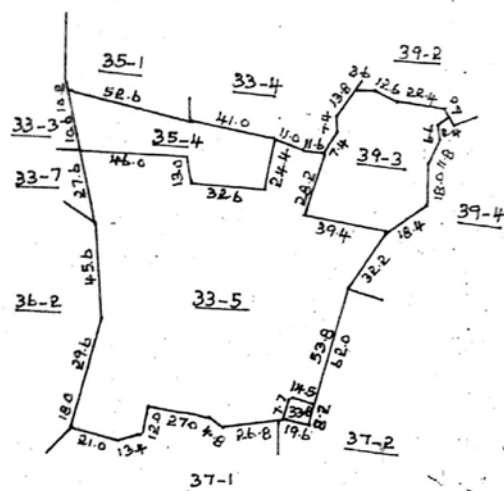

Handwritten signature
 29/7/2016

Prepared by SUB-INSPECTOR OF SURVEY
ANISHEKAPURAM ZONE
CITY CORPORATION
TIRUCHIRAPPALLI

True Extract

Office of the
 Tiruchirappalli City Corporation

For Commissioner

Date _____

Extract taken from the Town Survey field Register, Tiruchirappalli Town Survey No. 33/53 3/4 Of Ward No. AA Block No. 1
 திருச்சிரப்பள்ளி டவுன் சர்வே நம்பர் 33/53 3/4 ஓர் வார்ட் நம்பர் AA ப்ளாக் நம்பர் 1

Number of the locality or village and the name of the owner		Number of the holding		Survey field		Sub Division		Old survey No. and letter		Municipal Door No.		Government Mitra Zamindar Inam		Dry, wet unassessed Poramboke		House site, garden, trees, etc.		Source of irrigation and class		If double crop, rate of composition		Class and sort of soil		Rate per acre		Extent by Town Survey		Assessment		Name of Patta or Inam title deed and name of the Registered Holder		How the holding is utilized		Remarks	
1	2	3	4	5	6	7	8	9	10	11	12	13	14	15	16	17	18	19																	
33	5	42/1	-	7	நகர்	-	-	1.5	6	17.59	120890	-	-	462 K.T. கிருஷ்ணசாமி	நிலம்	கிருஷ்ணசாமி	செயல்																		
														R. லட்சுமணசாமி	நிலம்	இலட்சுமணசாமி	செயல்																		
35	4	44	-	5	நகர்	-	-	1.5	6	17.59	024500	-	-	42 K. பஞ்சவர்ணம்	நிலம்	K. பஞ்சவர்ணம்	செயல்																		
39	3	40	-	5	நகர்	-	-	1.5	6	17.59	024500	-	-	94 R. லட்சுமணசாமி	நிலம்	ராஜபெயர் - லட்சுமணசாமி	செயல்																		

Place of the Tiruchirappalli City Corporation
 Prepared by: SUBINSPECTOR OF SURVEY ABISHEKAPURAM ZONE CITY CORPORATION TIRUCHIRAPPALLI
 For Commissioner
 True Extract

Scanned by CamScanner

Note: Field Measurement Book (FMB) for SPS-8 and land ownership records for SPS-8, and SPS-9 will be obtained and included in the updated Resettlement Plan.

PROPOSED STRUCTURE OF SUBPROJECT INFORMATION DISCLOSURE LEAFLET

Up to 2-3 pages maximum.

Sub-project Information	Description
Name of the subproject, EA/IA and city	
Proposed subproject technical details and project benefits	
Summary of subproject impacts	
Compensation and entitlements	
Resettlement Plan budget	
Resettlement Plan implementation schedule	
Consultation and disclosure requirements	
Implementation structure and GRM information	
Contact numbers of GIAC, CMSC, PIU, PMU	

Attach list of affected persons and Entitlement Matrix to this leaflet. Provide translated copy of leaflet in Tamil.

SAMPLE GRIEVANCE REGISTRATION FORM

(To be available in Tamil and English)

The _____Project welcomes complaints, suggestions, queries, and comments regarding project implementation. We encourage persons with grievance to provide their name and contact information to enable us to get in touch with you for clarification and feedback.

Should you choose to include your personal details but want that information to remain confidential, please inform us by writing/typing *(CONFIDENTIAL)* above your name. Thank you.

Date	Place of registration	Project Town			
		Project:			
Contact information/personal details					
Name		Gender	* Male * Female	Age	
Home address					
Place					
Phone no.					
E-mail					
Complaint/suggestion/comment/question Please provide the details (who, what, where, and how) of your grievance below:					
If included as attachment/note/letter, please tick here:					
How do you want us to reach you for feedback or update on your comment/grievance?					

FOR OFFICIAL USE ONLY

Registered by: (Name of official registering grievance)	
Mode of communication: Note/letter E-mail Verbal/telephonic	
Reviewed by: (Names/positions of officials reviewing grievance)	
Action taken:	
Whether action taken disclosed:	Yes No
Means of disclosure:	