

Draft Resettlement Due Diligence Report

Project Number: 54118-001
April 2022

People's Republic of China: Strengthening Public Health Institutions Building Project — Draft Resettlement Due Diligence Report of Yan'an Subproject

Prepared by Yan'an University Affiliated Hospital for the Asian Development Bank.

This draft resettlement due diligence report is a document of the borrower. The views expressed herein do not necessarily represent those of ADB's Board of Directors, Management, or staff, and may be preliminary in nature. Your attention is directed to the "terms of use" section of this website.

In preparing any country program or strategy, financing any project, or by making any designation of or reference to a particular territory or geographic area in this document, the Asian Development Bank does not intend to make any judgments as to the legal or other status of any territory or area.

Commitment Letter

To strengthen the health security of the country, Shaanxi Provincial Government applied a proportion of ADB financing via Ministry of Finance to cover part of the project cost to conduct Shaanxi subproject of Strengthening Health Security in the People's Republic of China Project. Accordingly, the project will be implemented in compliance with ADB safeguard policies. As the project implementation unit, Yan'an University Affiliated Hospital has prepared the draft resettlement due diligence report(DDR). The resettlement DDR fully comply with requirements of the relevant laws, regulations and policies of People's Republic of China, Shaanxi Provincial Government and Yan'an Municipal Government, as well as comply with the ADB's Safeguard Policy Statement (SPS, 2009), specially the policy requirements on involuntary resettlement. Yan'an University Affiliated Hospital hereby affirm the authenticity and validity of the contents of the Due Diligence Report.

The DDR is developed based on the latest Feasibility Study Report, reflecting the latest scope of impacts, the latest socio-economic situation, the latest resettlement policies and the latest progress of the implementation, and remaining activities that have yet to be implemented. If there are additional households affected following completion of detailed design, an updated RP/DDR will be submitted to ADB for review and concurrence prior to award of civil works contract.

Yan'an University Affiliated Hospital

April 26, 2022



CURRENCY EQUIVALENTS

(as of 30 Mar 2022)

Currency unit – yuan (CNY)
\$1.00 = CNY 6.3566

ABBREVIATIONS

| | |
|------|--|
| ADB | - Asian Development Bank |
| AH | - Affected Household |
| AP | - Affected Person |
| CNY | - Chinese Yuan |
| EID | - Emerging Infectious Disease |
| FSR | - Feasibility Study Report |
| GRM | - Grievance Redress Mechanism |
| IA | - Implementing agency |
| LA | - Land Acquisition |
| PMO | - Project Management Office |
| PRC | - People's Republic of China |
| RBL | - Result-based lending |
| PSSA | - Program Safeguard Systems Assessment |
| SPS | - Safeguard Policy Statement |

MEASURES

1 hectare = 10,000 m²
1 mu = 666.67 m²

CONTENT

| | | |
|----------|--|-----------|
| 1 | PROJECT BACKGROUND | 1 |
| 1.1 | PROJECT OVERVIEW..... | 1 |
| 1.2 | CONSTRUCTION CONTENT..... | 2 |
| 1.2.1 | COMPONENT 1: CONSTRUCTION OF WOMEN AND CHILDREN BRANCH OF YAN'AN UNIVERSITY AFFILIATED HOSPITAL | 2 |
| 1.2.2 | COMPONENT 2: MEDICAL SERVICE CAPACITY BUILDING OF THE AFFILIATED HOSPITAL OF YAN'AN UNIVERSITY | 3 |
| 1.2.3 | COMPONENT 3: ENHANCEMENT OF THE COMPREHENSIVE REGIONAL PUBLIC HEALTH CAPACITY..... | 4 |
| 1.2.4 | COMPONENT 4: TRAINING BASE CONSTRUCTION, TALENT TRAINING AND PUBLICITY..... | 5 |
| 1.3 | PURPOSE OF THIS DUE DILIGENCE | 5 |
| 1.4 | METHODOLOGY | 5 |
| 1.5 | SOCIO-ECONOMIC SITUATION IN THE SUB-PROJECT AREA..... | 6 |
| 2 | DUE DILIGENCE RESULTS | 8 |
| 2.1 | DUE DILIGENCE REVIEW FOR SUB-PROJECT SITE | 8 |
| 2.2 | STAKEHOLDER ENGAGEMENT | 10 |
| 2.3 | RESETTLEMENT SURVEY ON EXISTING FACILITIES | 10 |
| 2.3.1 | SEWAGE TREATMENT FACILITIES | 10 |
| 2.3.2 | STATIONARY POLLUTANTS (MEDICAL WASTE)..... | 11 |
| 3 | CONCLUSION..... | 14 |
| 4 | CORRECTIVE ACTION PLAN | 14 |
| | ANNEX 1 APPROVAL OF SHAANXI PROVINCIAL DEVELOPMENT AND REFORM COMMISSION FOR THE FEASIBILITY STUDY OF WOMEN AND CHILDREN'S HOSPITAL OF YAN'AN UNIVERSITY AFFILIATED HOSPITAL..... | 15 |
| | ANNEX 2 DECISION ON STATE-OWNED LAND ALLOCATION OF THE PROJECT LAND PLOT | 18 |
| | ANNEX 3 APPROVAL FOR LAND USE OF THE PROJECT | 24 |
| | ANNEX 4 CORRESPONDENCES RELATED TO PROJECT LAND USE OF YAN'AN UNIVERSITY | 26 |
| | ANNEX5 CONTRACT FOR THE MEDICAL WASTE CENTRALIZED DISPOSAL PROJECT OF YAN'AN UNIVERSITY AFFILIATED HOSPITAL..... | 29 |

Table List

| | |
|--|----|
| Table 1-1 Social and economic situation of the project area..... | 6 |
| Table 2-1 Details of project land use | 8 |
| Table 4-1 corrective action plan | 14 |

Figure List

| | |
|--|----|
| Figure 1-1 Land area for Women and Children’s Branch of Yan’an University Affiliated Hospital..... | 3 |
| Figure 2-1 Current situation of project land plot (west) | 9 |
| Figure 2-2 Current situation of project land plot (east)..... | 9 |
| Figure 2-3 The part of the built facility available to the project | 9 |
| Figure 2-5 Scenes of some of the focus group/key figures interviews | 10 |
| Figure 2-6 Existing sewage treatment station of the Yan’an University Affiliated Hospital..... | 11 |
| Figure 2-7 Existing medical waste storage point of Yan’an University Affiliated Hospital..... | 12 |
| Figure 2-8 Status photos of the signed third-party medical waste treatment agency of Yan’an University Affiliated Hospital | 12 |

1 Project Background

1.1 Project overview

1. In 2020, the coronavirus disease (COVID-19) pandemic broke out in many places around the world, spread rapidly and continued to worsen, fully exposing the shortcomings and weaknesses of global public health security governance. Emerging infectious diseases (EIDs) continue to be a significant public health concern and cause of considerable socioeconomic disruption in the PRC. The Asian Development Bank (hereinafter referred to as "ADB") plans to roll out the "Strengthening Health Security in the People's Republic of China Project" (or the "Project") for the first time in China, with a total loan support of US \$300 million. The project will support the PRC in the development of an integrated system to strengthen the health security of the country.

2. The National Development and Reform Commission (NDRC) and the Ministry of Finance (MoF) have identified a number of public health service projects that could be included in the Project. In this context, Shaanxi Province actively applied to the NDRC and the MoF for the "Shaanxi subproject of Strengthening Health Security in the People's Republic of China Project " (the "Sub-project" in short).

3. Based on the economic and social development of the PRC and the full implementation of the "three-child" policy (announced in May 2021), the health demands for women and children continue to increase, and the visits to related women's and children's departments have grown rapidly and will continue to rise. Existing health resources in Yan'an City, Shaanxi Province can no longer meet the demand of patients for clinics and hospitalization, and there is an urgent need to increase the effective supply of professional medical services in Yan'an. With the strong support of the NDRC, National Finance Bureau, Shaanxi Provincial Development and Reform Commission, Provincial Finance Department and other relevant departments as well as the ADB, Shaanxi Province has organized the preparation of the Sub-project plan, and participated in several rounds of plan improvement and Sub-project selection. In July 2021, after evaluation by ADB experts and discussion by the NDRC, the Sub-project was officially selected as one of the three subprojects to be part of ADB's "Strengthening Health Security in the People's Republic of China Project", and was allocated an ADB loan of US \$100 million, of which US \$20 million will be provided by the central government.

4. The total investment of the project is estimated to be CNY 1,381,140,600 including CNY 1,224,498,200 for the project funds and other expenses for the project construction, CNY 53,621,600 for the reserve funds and CNY 45,810,700 for the interest during the construction period. CNY 835,898,200 will be used for the Women and Children's Branch of Yan'an University Affiliated Hospital, CNY 2,596,000 to improve the medical service capacity of the Yan'an University Affiliated Hospital, CNY

112,810,500 is for the enhancement of the regional public health capacity, and CNY 16,999,000 is for the construction of the training base, and personnel training location.

1.2 Construction content

5. The Sub-project includes four components:

- Construction of the Women and Children's Branch Hospital
- Capacity improvement of Yan'an University Affiliated Hospital
- Construction of a regional medical information platform
- Training capacity improvement and talent training

1.2.1 Component 1: Construction of Women and Children Branch of Yan'an University Affiliated Hospital

6. The Sub-project intends to occupy 48.21 mu of state-owned land, with a total construction area of 110,495.83 m².

7. The above-ground buildings include a 38,322.00 m² outpatient complex building, 35,506.43 m² rehabilitation and health complex building, 10,381.00 m² support complex building, 1,804.68 m² mechanical parking garage, 24.00 m² gas center, 170.60 m² sewage treatment and garbage station, 233.64 m² connecting corridor of outpatient and rehabilitation building.

8. The underground buildings include 3,766.11 m² basement of the rehabilitation and health complex building, 172.90 m² of a sewage treatment center, and 20,371.00 m² for the underground carpark of the outpatient complex building.

9. Shaanxi Provincial Development and Reform Commission approved the feasibility study of this component on April 19, 2021. Please see Annex 1 for the approval document. The current situation of the land is shown in Figure2-1, Figure 2-2 and Figure 2-3.

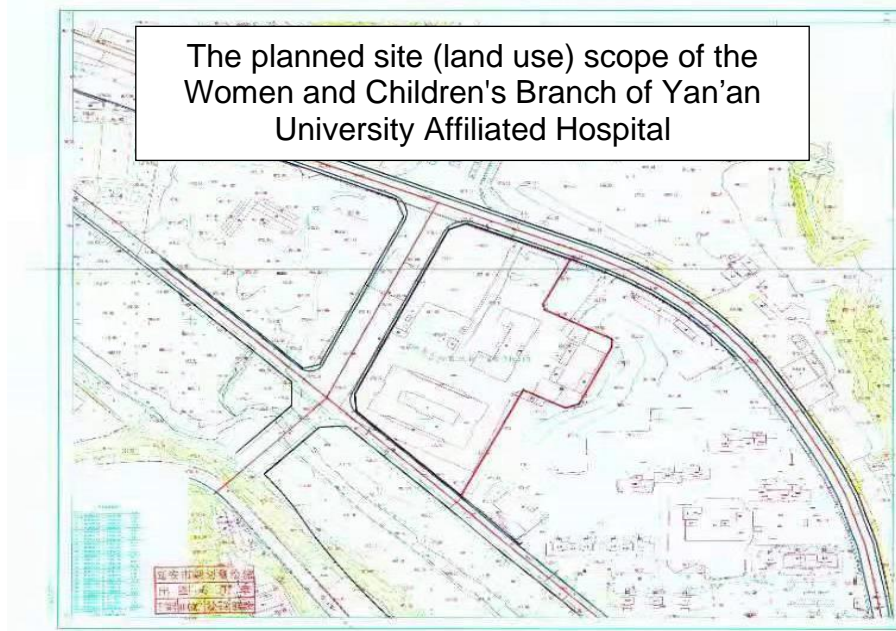

Figure 1-1 Land area for Women and Children’s Branch of Yan’an University Affiliated Hospital

1

1.2.2 Component 2: Medical service capacity building of The Affiliated Hospital of Yan’an University

(1) Facilities and equipment of Women and Children's Branch Hospital

10. The following operational needs were identified for the Women and Children's Branch Hospital: purchase and install the medical equipment required; purchase small medical equipment (instruments), tools, office facilities (for teaching), appliances, curtains, etc.; purchase and improve polymerase chain reaction (PCR) laboratory equipment, improve genetic testing items, and improve the level of pregnancy, fertility, upbringing, child prevention and health care and care for female reproductive health; and purchase and installation of medical supplies and intelligent distribution system equipment.

(2) Upgrading of facilities in the old hospital area

11. First, carry out the construction of a ward that will cater to normal operation as well as including resources during an epidemic. According to the national requirements of *Technical Guidelines for Construction of “Normal-Epidemic Combination” Convertible Ward in General Hospitals (Trial)*, establish the relatively independent and fully functional “normal-epidemic” combination ward that can conveniently connect with other functional areas of the hospital as there is currently no such ward in Yan’an University Affiliated Hospital.

12. Secondly, the Sub-project will upgrade medical equipment: improve the medical equipment in the pathological center, intensive care medicine, hematology department, biological sample library and other departments, so as to effectively

respond to the growing number of patients during the pandemic and for any future emerging infectious disease (EID) or public health emergency. It will allow staff to carry out health care work rapidly, efficiently and in an orderly manner, and minimize the health hazards while ensuring the safe, stable and orderly operation of other diagnosis and treatment activities. It will also realize the integration of medical treatment and prevention, and the combination of normal procedures and emergency procedures.

1.2.3 Component 3: Enhancement of the comprehensive regional public health capacity

(1) Procurement of equipment and software for the construction of a medical information platform in northern Shaanxi

13. Reorganize the medical treatment process to include online appointments, registration, payment, inspection, inspection results query and other services. Establish health files and electronic medical records, introduce intelligent reminders through the use of data analysis, and improve awareness of disease prevention in local communities. Build a standardized and data-based information integration platform within the medical group to realize regional medical services, such as inter-institution and inter-hospital referral, medical collaboration, doctor-patient exchange, and medical record sharing. Realize data sharing between medical groups and national, provincial and municipal health commissions, regularly report medical information, and provide technical support for management departments to carry out monitoring, early warning and emergency management of public health emergencies.

(2) Construction of a public health discipline at Yan'an University

14. Preparation of an establishment and development plan and implementation plan for the School of Public Health and Prevention, implement training, textbook compilation, hold academic forum (domestic and international), and procure equipment for the public health safety laboratory.

(3) Regional medical treatment capacity building

15. The procurement of equipment for the five centers of; i) chest pain, ii) stroke, iii) trauma treatment, iv) treatment of critically ill pregnant women and v) treatment of critically ill new-borns. The procurement of equipment for key specialties (EIDs, severe diseases, respiratory diseases, etc.), and capacity training for their treatment.

(4) Special research on regional public health

16. Including a mechanism that can be used during normal periods, as well as during an epidemic (a “normal-epidemic” combination mechanism) research and improvement and pilot study of public health emergency response plan, improvement and pilot study of Shaanxi Province Disease Prevention and Control and Major Epidemic Treatment Mechanism, Shaanxi Provincial Regional Medical Center development strategy and planning, research on the development of geriatric

medicine and the treatment of cardiovascular and cerebrovascular diseases, and regional pathogen detection research.

1.2.4 Component 4: Training base construction, talent training and publicity

(1) Construction of clinical skills training base

17. Construction of simulation training, virtual training, and management systems., procurement of advanced simulation training equipment, and preparation of training materials for international exchanges.

(2) Talent cultivation

18. Training of backbone doctors: Academic exchanges, study tours, specialist training, etc.; training of primary physicians; career development support for female employees (seminars, special training, lectures, etc.)

(3) Publicity

19. Equipment installation and procurement for the "Human Life Science Museum", the construction of a psychological consultation platform for women, teenagers and children (equipment procurement and app development), equipment procurement for the school for pregnant women, the popularization of science among teenagers and children, the publicity of a green channel for vulnerable groups to seek medical treatment, the publicity of pre-hospital first aid knowledge, and the publicity of the combination of medical care and nursing knowledge.

1.3 Purpose of this Due Diligence

20. The purpose of this due diligence review for the land acquisition and existing facilities is to check if the land acquisition and resettlement of the affected people (APs) are in compliance with the laws and regulations of the State, Shaanxi Province and Yan'an City, and whether they conform to the social safeguard policies of ADB, identify outstanding issues arising from resettlement, and propose corrective actions and/or mitigation measures, if necessary.

21. From March 1 to 7, 2022, social specialists from China International Engineering Consulting Co., Ltd. were hired by Shaanxi Project Office to conduct an on-site investigation of the land use situation and social impact of the Sub-project and compile this due diligence through analysis and evaluation of the information.

1.4 Methodology

22. The information used in this report has been identified from the following three sources:

- a) Literature review: collecting and compiling Sub-project information and survey data from local authorities and Sub-project agencies

- Collected literature: Sub-project approval documents, land use right certificates, the land acquisition policy, agreements, compensation records and related supporting measures related to resettlement, etc.
 - Existing public participation information related to resettlement, land acquisition notices etc.
- b) Information and data have been verified through fieldwork and direct communication with stakeholders.
- c) The list of existing facilities for this Sub-project are determined by environmental experts together with ADB.

1.5 Socio-economic situation in the Sub-project area

23. Yan'an City is located in the northern part of Shaanxi Province, in the middle reaches of the Yellow River, between 35 ° 21 ' ~ 37 ° 31 ' north latitude and 107 ° 41 ' ~ 110 ° 31' east longitude, where is in the mid-south region of the Loess Plateau, and is 371 km away from Xi'an in the north. It has jurisdiction over two districts, 11 counties, 16 subdistrict offices, 84 towns, and 12 townships. In 2020, the city had a permanent population of 2,286,200. The construction site of this Sub-project is located in Baota District, Yan'an city, Shaanxi Province.

24. Baota District is located in the northern part of Shaanxi Province. It has jurisdiction over nine towns, four townships, five urban street offices, 320 administrative villages, and 50 urban and rural communities. At present, there are 641,000 permanent residents in the district, including 335,300 males and 305,700 females, with a male to female ratio of 52.3:48.7. (See Table 1-1 for the data).

25. Yan'an City is an area where ethnic minorities live dispersed among the rest of the community. There is a population of 2,045 ethnic minorities in the city, accounting for 0.09% of the total population, which are distributed in Baota, Huanglong, Yichuan, Luochuan, Huangling, Fuxian and the other six counties and districts, without specific concentration of ethnic minority people. Some of the scattered ethnic minorities people have intermarried with Han families, while others have lived in Han areas for many years and have been integrated with the customs of the Han people. There are no systematic or special requirements for ethnic minority people in Yan'an City and no sensitivity of ethnic minority groups made by the Sub-project.

Table 1-1 Social and economic situation of the Sub-project area

| No. | Sub-project | Unit | Yan'an | Baota District |
|-----|--------------------|---------------------|--------|----------------|
| 1 | National Land area | km ² | 36,712 | 3,556 |
| 1.1 | Cultivated area | Ten thousand mu | 555.56 | 63.53 |
| 2 | Total population | Ten thousand people | 228.62 | 64.10 |
| 2.1 | Male population | Ten thousand people | 119.25 | 33.53 |
| 2.2 | Female population | Ten thousand people | 109.00 | 30.57 |

| No. | Sub-project | Unit | Yan'an | Baota District |
|-----|-----------------------------|---------------------|----------|----------------|
| 2.3 | Ethnic minority population | Ten thousand people | 0.2 | 0.06 |
| 3 | GDP | CNY hundred million | 1,601.48 | 368.54 |
| 3.1 | Primary industry | CNY hundred million | 190.41 | 20.99 |
| 3.2 | Secondary industry | CNY hundred million | 885.72 | 137.69 |
| 3.3 | Tertiary Industry | CNY hundred million | 525.35 | 209.86 |
| 3.4 | GDP per capita | CNY per person | 70,050 | 57,495 |
| 4 | Urban disposable income | CNY per person | 36,577 | 37,301 |
| 5 | Rural per capita net income | CNY per person | 12,845 | 10,658 |

2 Due Diligence Results

2.1 Due Diligence Review for Sub-project Site

26. The land to be used in this Sub-project includes 48.21 mu of unutilized state-owned land, which belongs to Yan'an University and does not include collective land. The land plots involved in the Sub-project were allocated to Yan'an University in 2009 and 2011 respectively. See Annex 2 for the state-owned land allocation decision and Annex 3 for the land approval document. Since the land that previously belonged to Yan'an University was allocated by the state for free. Yan'an University has also agreed to transfer the state-owned use right to the Women and Children's Branch of Yan'an University Affiliated Hospital for free. See the meeting minutes in Annex 4 for further details.

27. Due to the relocation of most of the teaching and scientific research units of Yan'an University to the new campus, the plot is currently in an idle state. Yan'an University agrees to use the plot for the construction of a Women and Children's Hospital. See Annex 4 for relevant documents from Yan'an University. However, the current land allocation for the land plot is for education and street use. To use this land for the Sub-project, there needs to be a change of land use allocation made by the local Natural Resources Bureau. As of March 2022, the Sub-project office has applied for the change of land use at the Natural Resources Bureau of Yan'an City and Baota District. The approval of the application is expected to be completed by the end of April 2022, and the land use will be changed to construction land (medical treatment) at that time. Details of the Sub-project land use are shown in the following table:

Table 2-1 Details of Sub-project land use1

| Land status | Current land use | Current land ownership | State-owned land allocation time and decision number | State-owned land allocation | State-owned land use change situation | Sub-project land area (mu) |
|-------------|--|------------------------|--|--|---|----------------------------|
| State-owned | Land for education, streets and alleys | Yan'an University | Shaanyan Baota (2009) No. 0007, 2009 | Science and education land: 14.8838 ha Road land: 3.4204 ha | The procedures for change of land use have been submitted to Yan'an Natural Resources Bureau for review. The approval is expected to be completed by the end of April 2022. | 39.42 |
| State-owned | Land for education, streets and alleys | | Shaanyan Baota (2011) No. 0012, 2011 | Science and education land: 3.9984 ha Road land: 1.3349 ha | | 8.79 |
| Total | | | | | | 48.21 |

28. The Sub-project land for the Women and Children's Branch of Yan'an University Affiliated Hospital is the former teaching land of Yan'an University. There are two buildings, the professional teaching building (6F) and experimental complex building (9F) in operation in the site (see Figure 2-1, 2-2, 2-3). The Project land does not involve any new land acquisition, demolition or resettlement.



Figure 2-1 Current situation of Sub-project land plot (west) 21



Figure 2-2 Current situation of Sub-project land plot (east)22



Figure 2-3 The part of the built facility available to the Sub-project

2.2 Stakeholder Engagement 2

29. On 1 March 2022, China International Engineering Consulting Co., Ltd. interviewed representatives of Yan'an University and Yan'an University Affiliated Hospital. It was confirmed this Sub-project does not involve involuntary resettlement. The land is vacant and there are no users on said land.²³



Figure 2-4 Focus group/key informant interviews

2.3 Resettlement survey on associated/existing facilities 2

2.3.1 Sewage treatment facilities

30. The sewage for this Sub-project will be treated by a new sewage treatment station within the project scope, which will be located in the newly built hospital area and is part of the building facilities of the Sub-project. The sewage treatment station design shall be in compliance with the *Code for Design of Hospital Sewage Treatment* (CECS07: 2004). The sewage treatment station adopts primary precipitation plus contact disinfection process, which meets the pre-treatment standard of "water pollutant discharge limit of comprehensive medical institutions and other medical institutions" and will then drain away to the municipal pipe network as required. Finally, it will be discharged into the municipal pipe network.

31. The existing facility is located in the newly built courtyard, and the land information is the same as in Section 2.1, it does not involve resettlement and has no related pending issues.



**Figure 2-4 Existing sewage treatment station of the Yan'an University
Affiliated Hospital**

2.3.2 Existing pipeline network

32. The sewage water will be discharged to the existing pipeline within Yan'an university which was constructed in 2009, simultaneously with the construction of the campus, all under the state-owned land. There are no APs and no compensation.

2.3.3 Stationary pollutants (medical waste)

33. The treatment of stationary pollutants (medical waste) within the construction scope of the new site of this Sub-project shall be disposed of using sodium hypochlorite, alcohol chemical disinfection or high temperature, high pressure, fumigation and other methods according to relevant national standards on medical waste (biological solid waste), in accordance with the regulations on highly-hazardous wastes such as culture mediums, specimens, strains, and virus seed preservation solutions of pathogens in medical waste in the *Management Regulations of Medical Wastes* promulgated in 2003.

34. All medical waste will be collected and transported to temporary storage sites using special anti-leakage and anti-spillage transportation tools, according to the sewage logistics route designed for this Sub-project and the determined internal medical waste delivery time; tools will be disinfected and cleaned in a timely manner at the internal designated locations. Medical and chemical waste will be handed over to professional companies for transportation and processing. The temporary storage points for medical waste are all within the construction scope of the new hospital area. See Section 2.1 for the land use information of the new hospital area. The collection point construction facilities do not involve involuntary resettlement, and there are no related residual resettlement issues.



Figure 2-5 Existing medical waste storage point of Yan'an University Affiliated Hospital

35. On September 1, 2021, Yan'an University Affiliated Hospital and Yan'an Shengyuan Medical Waste Central Disposal Co., Ltd. signed a contract for the centralized disposal of medical waste of Yan'an University Affiliated Hospital (see Annex 5).



Figure 2-6 Status photos of the signed third-party medical waste treatment agency of Yan'an University Affiliated Hospital

36. Yan'an Shengyuan Medical Waste Central Disposal Co., Ltd. established in 2006 is the only medical waste collection, transportation and disposal institution recognized

by the state in Yan'an City, and was identified as the city's designated medical waste disposal unit by the Yan'an Municipal Government in 2011. It is located on the right side of Taoshushan Tunnel, Xiaogou Village, Hezhuangping Town, Baota District, Yan'an City, covering an area of 15 mu, with a total investment of more than CNY 40 million, including the investment in fixed assets of more than CNY 20 million. The land was expropriated in 2005 following Chinese regulation, and it has been nearly 20 years since this was completed. Given the number of years that have passed since the expropriation was undertaken, very few related documents remain. However, the state-owned land use certificate has been received. Up to now, no resettlement-related complaints have been identified and the institution has no pending or outstanding issues related to land acquisition and resettlement. **The workers in the workshop put the medical waste turnover box into the feeding machine and put it into the sterilization truck, push the classified sterilization truck into the sterilization cabinet, and start the program. After the program runs automatically, it exits the program. The medical waste is sterilized by 1350 high-temperature steam and then lifted to the crushing system. The crushed shape is transferred to the garbage transfer vehicle, and then sent to the Yan'an City Landfill for sanitary landfill.**²

3 Conclusion

37. In the construction content of this Sub-project, only the newly built Women and Children's Branch of Yan'an University Affiliated Hospital involves newly occupied land. The Sub-project land plot is state-owned land, which was allocated to Yan'an University for school construction in 2009 and 2011 respectively, and there are no residual issues relating to land acquisition. Due to the relocation of most of the teaching and research units of Yan'an University to a new campus, the plot is left vacant without resettlement impact. Yan'an University has agreed to use the land for the construction of the Women and Children's Hospital.

38. As this land plot is allocated to Yan'an University, the land use rights are for educational land and street construction. For the Sub-project to use the site for the hospital, a land use change is required with the local Natural Resources Bureau to change it to construction land for medical purposes.

4 Action Plan

Table 4-1 Action plan

| Item | Responsible party | Budget (CNY) | Deadline |
|--|---------------------------|--------------|----------------------|
| Obtain Approval of Land Use Application from District Natural Resources Bureau | Yan'an Sub-project Office | 0 | By end of April 2022 |

Annex 1 Approval of Shaanxi Provincial Development and Reform Commission for the Feasibility Study of Women and Children's Hospital of Yan'an University Affiliated Hospital

陕西省发展和改革委员会文件

陕发改社会〔2021〕511号

陕西省发展和改革委员会 关于延安大学附属医院妇女儿童分院项目 可行性研究报告的批复

省卫生健康委：

你委《关于报送延安大学附属医院妇女儿童分院可行性研究报告的函》（陕卫规划函〔2021〕25号）收悉。经研究，原则同意建设延安大学附属医院妇女儿童分院项目。现将该项目可行性研究报告批复如下：

一、项目名称

延安大学附属医院妇女儿童分院项目。

二、建设地址

项目位于延安大学萃园校区南地块西北侧，北临过境路，西临规划路，南临延大路。

三、建设规模及主要内容

项目总建筑面积110495.83平方米，其中：新建60724.92平方米，包括门诊综合楼、地下车库及设备用房、机械停车楼、气体中心及垃圾站、污水处理中心；改建49770.91平方米，包括康复保健综合楼（原实验综合楼）、保障综合楼（原专业教学楼）；配套建设医用气体、污水处理系统、医疗垃圾处理系统、医院信息化业务系统、充电桩以及室外道路、室外管网、绿化等室外总体工程。

四、总投资及资金来源

项目总投资95774.46万元，其中工程费用80560.78万元，工程建设其他费用5211.46万元，预备费8577.22万元，建设期利息1425万元。建设资金由申请中央预算内投资、亚行贷款、地方政府专项债券以及项目单位自筹解决。

五、项目招投标

要按照《中华人民共和国招标投标法》等规范招标行为，该项目的勘察设计、建筑安装、工程监理、重要材料及设备采购等均应依照相关法律法规公开招标，纳入公共资源交易平台进行交易。

- 1 -

- 2 -

接文后，请抓紧落实相关建设条件，严格按照基本建设管理程序办理有关建设手续，并编制项目初步设计报我委审批。
该项目代码：2012-610602-04-01-992700。

陕西省发展和改革委员会
2021年4月19日

- 3 -

抄送：省住房城乡建设厅、省自然资源厅、省生态环境厅、省审计厅。

陕西省发展和改革委员会办公室 2021年4月20日印发

- 4 -



Document of Shaanxi Provincial Development and Reform Commission

Shaanfagai Shehui [2021] No. 511

Approval of Shaanxi Provincial Development and Reform Commission on the Feasibility Study Report on the Women and Children's Branch Hospital of Yan'an University Affiliated Hospital

Provincial Health Commission:

Your Commission's *Letter on Submitting the Feasibility Study Report of the Women and Children's Branch Hospital of Yan'an University Affiliated Hospital* (Shaanwei Guihua Han [2021] No. 25) has been received. After discussion, it is agreed in principle to build the Women and Children Branch of Yan'an University Affiliated Hospital. The feasibility study report of the project is hereby approved as follows:

1. Project Name

The Women and Children's Branch Hospital of Yan'an University Affiliated Hospital.

2. Construction Address

The project is located on the northwest side of the Yan'an University Cuiyuan Campus' southern plot, bordering Guojing Road in the north, the planned Road in the west, and Yanda Road in the south.

3. Construction Scale and Main Content

The total construction area of the project is 110,495.83m², of which: 60,724.92m² are newly built, including outpatient complex building, underground garage and equipment room, mechanical parking building, gas center and garbage station, and sewage treatment center; 49,770.91m² are rebuilt, including the complex building for rehabilitation and health care (the former complex building for experiments), the security complex building (the former major teaching building); medical gas, sewage treatment system, medical waste treatment system, hospital information business system,

charging piles, and outdoor roads, outdoor pipes, greening and other outdoor projects shall be constructed for support.

4. Total Investment and Source of Funds

The total investment of the project is CNY 957,744,600, including CNY 805,607,800 of project funds, CNY 52,114,600 of other construction costs, CNY 85,772,200 of reserve funds, and CNY 14,250,000 of interest during the construction period. The construction funds are all financed by the central budget investment, ADB loan, local government special bond, and self-financing by the project organization.

5. Project Bidding

It is necessary to standardize the bidding behavior in accordance with the *Law of the People's Republic of China on Tenders and Bids*, etc. The project's design, construction and installation, engineering supervision, and procurement of important materials and equipment shall be put to public tender in accordance with relevant laws and regulations, and included in the public resource trading platform to trade.

After receiving the letter, please promptly implement the relevant construction conditions, go through the relevant construction procedures in strict accordance with the basic construction management procedures, and prepare the preliminary design of the project and submit it to our commission for approval.

The project code: 2012-610602-04-01-992700.

Shaanxi Provincial Development and Reform Commission

April 19, 2021

CC: Shaanxi Provincial Department of Housing and Urban-Rural Development, Shaanxi Provincial Department of Natural Resources, Shaanxi Provincial Department of Ecology and Environment, and Shaanxi Provincial Audit Department.

Shaanxi Provincial Development and Reform Commission Office

Printed and distributed on April 20, 2021



Annex 2 Decision on State-Owned Land Allocation of the Project Land Plot

1. Shaanyan Baota (2009) No. 0007

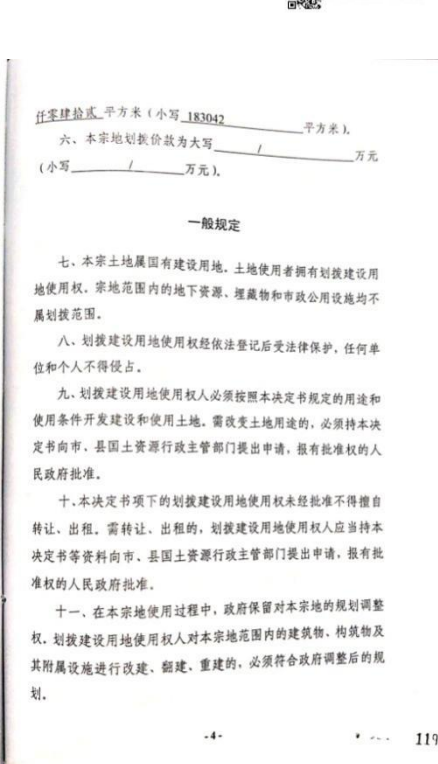
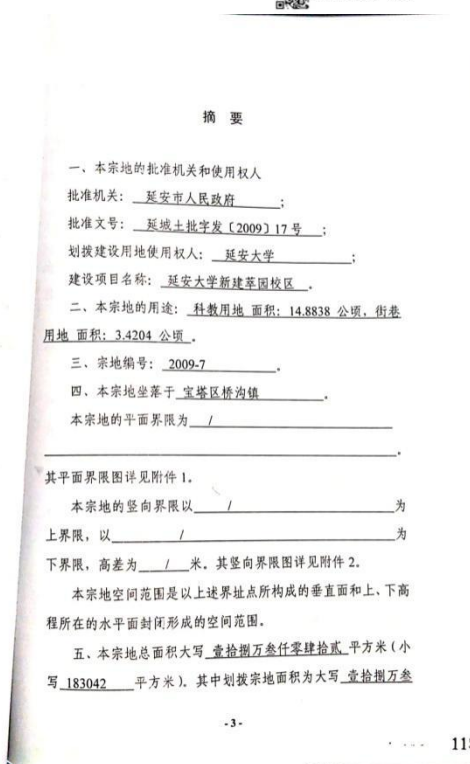
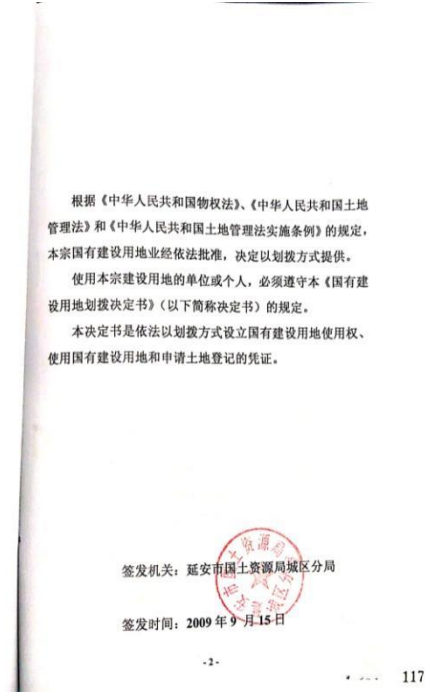
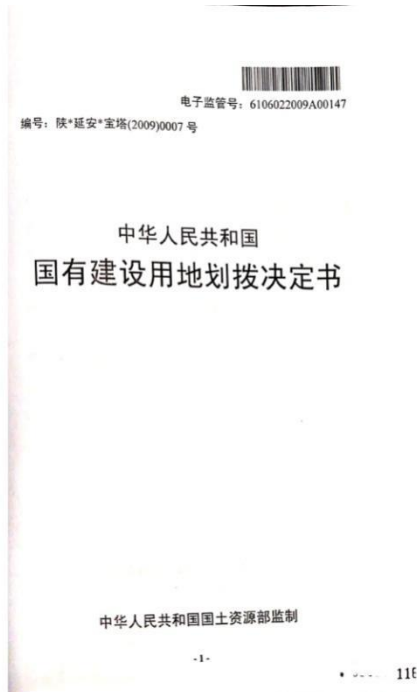

十二、政府为公益事业需要铺设的各种管道与管线进出、穿越本宗土地，划拨建设用地使用权人应当提供便利。

十三、国土资源行政主管部门有权对本宗土地的使用情况进行监督检查，划拨建设用地使用权人应当予以配合。

十四、有下列情形之一的，经原批准用地的人民政府批准，市、县人民政府可以收回土地使用权：

1. 为公共利益需要使用土地的；
2. 为实施城市规划进行旧城区改建，需要调整使用土地的；
3. 自批准的动工开发建设日期起，逾期两年未动工开发建设的；
4. 因用地单位撤销、迁移等原因，停止使用土地的。

特别规定

十五、本宗土地只限于建设延安大学新建校园区项目。

划拨建设用地使用权人在宗地范围内新建建筑物、构筑物及其附属设施，应当符合土地使用标准的规定和市、县城市规划主管部门、项目批准主管部门确定的宗地规划、建设条件、宗地规划、建设条件详见附件三。其中：

主体建筑物性质 /
附属建筑物性质 /
总建筑面积 234876 平方米；

-5-

127



扫描全能王 创建

建筑容积率不高于 / 不低于 1.02 ;
建筑限高 / ;
建筑密度不高于 / 不低于 17.14% ;
绿地率不高于 / 不低于 35% ;
其他土地利用要求 / ;

十六、本宗地用于廉租住房和经济适用住房建设的，其宗地范围内的住房建筑总面积为大写 / 平方米(小写 / 平方米)，住房总套数不少于 / 套，其中，单套建筑面积为 50 平方米以下的廉租住房 / 套，单套建筑面积为 / 平方米以下的 / 套。

用于廉租住房和经济适用住房建设的，不得改变土地用途。

十七、划拨建设用地使用权人应当承担下列公共设施，并在建成后移交给政府：

/

十八、本建设项目应于 2009 年 9 月 19 日之前开工建设，并于 2011 年 9 月 19 日之前竣工，不能按期开工建设的，应向市、县国土资源行政主管部门申请延期，但延期期限不得超过一年。

用于廉租住房和经济适用住房建设的，开发建设期限不得超过三年。

十九、项目竣工验收时，应按国家有关规定对本决定书规定

-6-

127



扫描全能王 创建

的土地开发利用条件进行检查核校。没有国土资源行政主管部门的检查核校意见，或者检查核校不合格的，不得通过竣工验收。

二十、划拨建设用地使用权人不按本决定书规定的开发建设期限进行建设，造成土地闲置的，依照有关规定处理。

二十一、划拨建设用地使用权人应当依法合理使用和保护土地，划拨建设用地使用权人在本宗土地上的所有活动，不得损害或者破坏周围环境或设施，使国家、集体或者个人利益遭受损失的，划拨建设用地使用权人应当予以赔偿。

二十二、划拨建设用地使用权人违反本决定书规定使用土地的，依法予以处理。

二十三、本决定书未尽事宜，市、县人民政府国土资源行政主管部门可依据土地管理法律、法规的有关规定另行规定，作为本决定书的附件。

附则

二十四、本决定书由市、县国土资源行政主管部门负责签发。

二十五、本决定书一式四份，划拨建设用地使用权人持二份，国土资源行政主管部门留存二份。

二十六、本决定书自签发之日起生效。

-7-

122



扫描全能王 创建

延安大学扩建用地勘测定界图

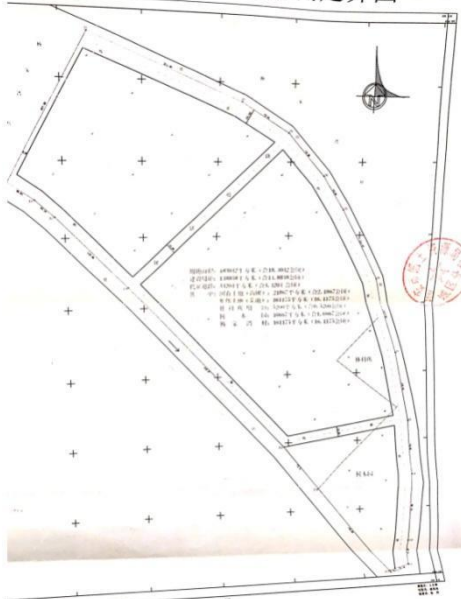

扫描全能王 创建

39. The People's Republic of China
40. Decision on the Allocation of State-owned Construction Land
41. According to the Property Law of the People's Republic of China, Land Administration Law of the People's Republic of China and Regulations for the Implementation of the Land Administration Law of the People's Republic of China, the state-owned construction land has been approved in accordance with the law and decided to be provided by allocation.
42. Organizations or individuals who use the construction land in this case must abide by the provisions of this Decision on the Allocation of State-owned Construction Land (hereinafter referred to as the decision).
43. This decision is a certificate for establishing the right to use state-owned construction land, using state-owned construction land and applying for land registration in accordance with the laws and regulations.
44. Issuing authority: Urban Branch of Yan'an Land and Resources Bureau
45. Date of Issuance: September 15, 2009

46. The approving authority and the use right holder of the land
47. Approving authority: Yan'an Municipal People's Government;
48. Approval number: Yancheng Tupi Zifa [2009] No. 17;
49. Use right holder of allocated construction land: Yan'an University;
50. Name of construction project: Newly built Yan'an University Cuiyuan Campus (Phase II).
51. Purpose of the land: Science and education land area: 14.8838 hectares, street land area:3.4204 hectares.
52. This decision is issued by the municipal and county land and resources administrative departments. This decision will take effect from the date of issuance.

2. Shaanyan Baota (2011) No. 0012



电子监管号: 6106022011A00217

编号: 陕*延安*宝塔(2011)0012号

中华人民共和国 国有建设用地划拨决定书

中华人民共和国国土资源部监制

- 1 -

95



扫描全能王 创建

摘要

一、本宗地的批准机关和使用权人

批准机关: 延安市人民政府;

批准文号: 延城土批字发〔2011〕26号;

划拨建设用地使用权人: 延安大学;

建设项目名称: 延安大学新建菜园校区(二期)。

二、本宗地的用途: 科教用地 面积: 3.9984 公顷, 街巷
用地 面积: 1.3349 公顷。

三、宗地编号: 2011-17。

四、本宗地坐落于 宝塔区桥沟镇。

本宗地的平面界限为 /

其平面界限详见附件1。

本宗地的竖向界限以 / 为
上界限, 以 / 为
下界限, 高差为 / 米。其竖向界限详见附件2。

本宗地空间范围是以上述界址点所构成的垂直面和上、下高
程所在的水平面封闭形成的空间范围。

五、本宗地总面积大写 伍万叁仟叁佰叁拾叁 平方米(小写
53333 平方米)。其中划拨宗地面积为大写 伍万叁仟叁佰叁

- 3 -

96



扫描全能王 创建

根据《中华人民共和国物权法》、《中华人民共和国土地
管理法》和《中华人民共和国土地管理法实施条例》的规定,
本宗国有建设用地业经依法批准, 决定以划拨方式提供。

使用本宗建设用地的单位或个人, 必须遵守本《国有建
设用地划拨决定书》(以下简称决定书)的规定。

本决定书是依法以划拨方式设立国有建设用地使用权、
使用国有建设用地和申请土地登记的凭证。

签发机关: 延安市国土资源局城区分局

签发时间: 2011年12月27日

- 2 -

94



扫描全能王 创建

公顷 平方米(小写 53333 平方米)。

六、本宗地划拨价款为大写 / 万元
(小写 / 万元)。

一般规定

七、本宗土地属国有建设用地。土地使用者拥有划拨建设用
地使用权。宗地范围内的地下资源、埋藏物和市政公用设施均不
属划拨范围。

八、划拨建设用地使用权经依法登记后受法律保护, 任何单
位和个人不得侵占。

九、划拨建设用地使用权人必须按照本决定书规定的用途和
使用条件开发建设和使用土地。需改变土地用途的, 必须持本决
定书向市、县国土资源行政主管部门提出申请, 报有批准权的人民
政府批准。

十、本决定书项下的划拨建设用地使用权未经批准不得擅自
转让、出租、需转让、出租的, 划拨建设用地使用权人应当持本
决定书等资料向市、县国土资源行政主管部门提出申请, 报有批
准权的人民政府批准。

十一、在本宗地使用过程中, 政府保留对本宗地的规划调整
权。划拨建设用地使用权人对本宗地范围内的建筑物、构筑物及
其附属设施进行改建、翻建、重建的, 必须符合政府调整后的规
划。

- 4 -

96



扫描全能王 创建

- 十二、政府为公益事业需要而敷设的各种管道与管线进出、交叉、穿越本宗土地，划拨建设用地使用权人应当提供便利。
- 十三、国土资源行政主管部门有权对本宗土地的使用情况进行监督检查，划拨建设用地使用权人应当予以配合。
- 十四、有下列情形之一的，经原批准用地的人民政府批准，县人民政府可以收回土地使用权：
1. 为公共利益需要使用土地的；
 2. 为实施城市规划进行旧城区改建，需要调整使用土地的；
 3. 自批准的动工开发建设日期起，逾期两年未动工开发建设的；
 4. 因用地单位撤销、迁移等原因，停止使用土地的。

特别规定

十五、本宗土地只限于建设 延安大学新建校区(二期) 项目。

划拨建设用地使用权人在宗地范围内新建建筑物、构筑物及其附属设施，应当符合土地使用标准的规定和市、县城市规划主管部门、项目建设主管部门确定的宗地规划、建设条件。宗地规划、建设条件详见附件三。其中：

主体建筑物性质 _____ / _____
 附属建筑物性质 _____ / _____
 总建筑面积 _____ / _____ 平方米；



建筑容积率不高于 _____ / 不低于 1.02 _____；
 建筑限高 _____ / _____；
 建筑密度不高于 _____ / 不低于 17.14% _____；
 绿地率不高于 _____ / 不低于 35% _____；
 其他土地利用要求 _____ / _____。

十六、本宗地用于廉租房和经济适用住房建设的，其宗地范围内的住房建筑总面积为大写 _____ / _____ 平方米(小写 _____ / _____ 平方米)，住房总套数不少于 _____ / _____ 套。其中，单套建筑面积为 50 平方米以下的廉租房 _____ / _____ 套，单套建筑面积为 _____ / _____ 平方米以下的 _____ 套。

用于廉租房和经济适用住房建设的，不得改变土地用途。

十七、划拨建设用地使用权人应当承建下列公共设施，并在建成后移交政府：
 _____ / _____

十八、本建设项目应于 2011 年 12 月 30 日之前开工建设，并于 2013 年 12 月 30 日之前竣工。不能按期开工建设的，应向市、县国土资源行政主管部门申请延期，但延期期限不得超过一年。

用于廉租房和经济适用住房建设的，开发建设期限不得超过三年。

十九、项目竣工验收时，应按国家有关规定对本决定书规定



的土地开发利用条件进行检查核验。没有国土资源行政主管部门的检查核验意见，或者检查核验不合格的，不得通过竣工验收。

二十、划拨建设用地使用权人不按本决定书规定的开发建设期限进行建设，造成土地闲置的，依照有关规定处理。

二十一、划拨建设用地使用权人应当依法合理使用和保护土地。划拨建设用地使用权人在本宗土地上的一切活动，不得损害或者破坏周围环境或设施，使国家、集体或者个人利益遭受损失的，划拨建设用地使用权人应当予以赔偿。

二十二、划拨建设用地使用权人违反本决定书规定使用土地的，依法予以处理。

二十三、本决定书未尽事宜，市、县人民政府国土资源行政主管部门可依据土地管理法律、法规的有关规定另行规定，作为本决定书的附件。

附 则

二十四、本决定书由市、县国土资源行政主管部门负责签发。

二十五、本决定书一式四份，划拨建设用地使用权人持二份，国土资源行政主管部门留存二份。

二十六、本决定书自签发之日起生效。

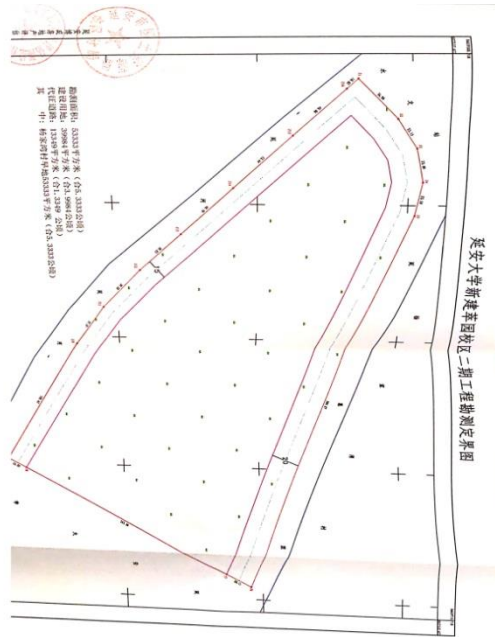

53. The People's Republic of China
54. Decision on the Allocation of State-owned Construction Land
55. According to the Property Law of the People's Republic of China, Land Administration Law of the People's Republic of China and Regulations for the Implementation of the Land Administration Law of the People's Republic of China, the state-owned construction land has been approved in accordance with the law and decided to be provided by allocation.
56. Organizations or individuals who use the construction land in this case must abide by the provisions of this Decision on the Allocation of State-owned Construction Land (hereinafter referred to as the decision).
57. This decision is a certificate for establishing the right to use state-owned construction land, using state-owned construction land and applying for land registration in accordance with the laws and regulations.
58. Issuing authority: Urban Branch of Yan'an Land and Resources Bureau
59. Date of Issuance: December 27, 2011
60. The approving authority and the use right holder of the land
61. Approving authority: Yan'an Municipal People's Government;
62. Approval number: Yancheng Tupi Zifa [2011] No. 26;
63. Use right holder of allocated construction land: Yan'an University;
64. Name of construction project: Newly built Yan'an University Cuiyuan Campus (Phase II).
65. Purpose of the land: Science and education land area: 3.9984 hectares, street land area: 1.3349 hectares.
66. This decision is issued by the municipal and county land and resources administrative departments.
67. This decision will take effect from the date of issuance.

Annex 3 Approval for Land Use of the Project

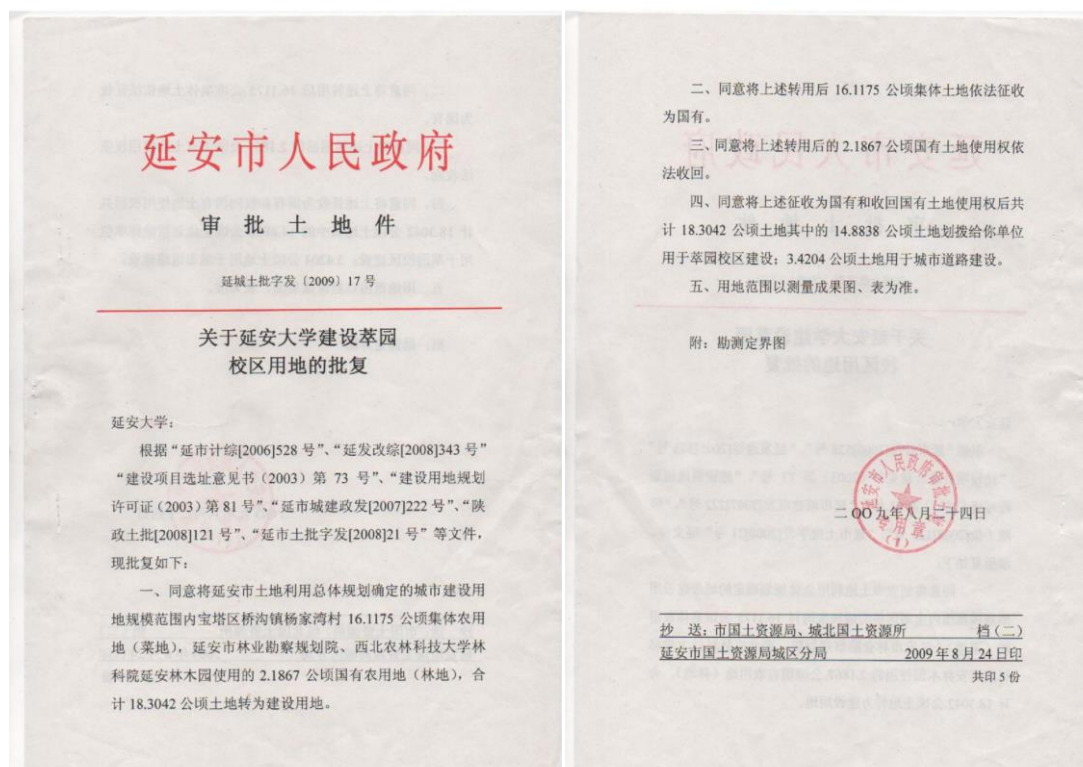

68. Yan'an Municipal People's Government

69. Document on Land Approval

70. Yancheng Tupi Zifa (2009) No. 17

71. Reply on the Construction of Yan'an University Cuiyuan Campus

72. Yan'an University:

73. The approval is as follows according to the relevant documents of the Shaanxi Provincial People's Government and Yan'an Municipal People's Government:

74. It is agreed to convert a total of 18.3042 hectares of land within the scale of urban construction land determined by the overall planning of Yan'an City into construction land.

75. It is agreed to allocate the 14.8838 hectares of the total of 18.3042 hectares land expropriated as state-owned and with reclaimed state-owned land use rights to your organization for the construction of Cuiyuan Campus; 3.4204 hectares for urban road construction.

76. August 24, 2009

77. Urban Branch of Yan'an Land and Resources Bureau

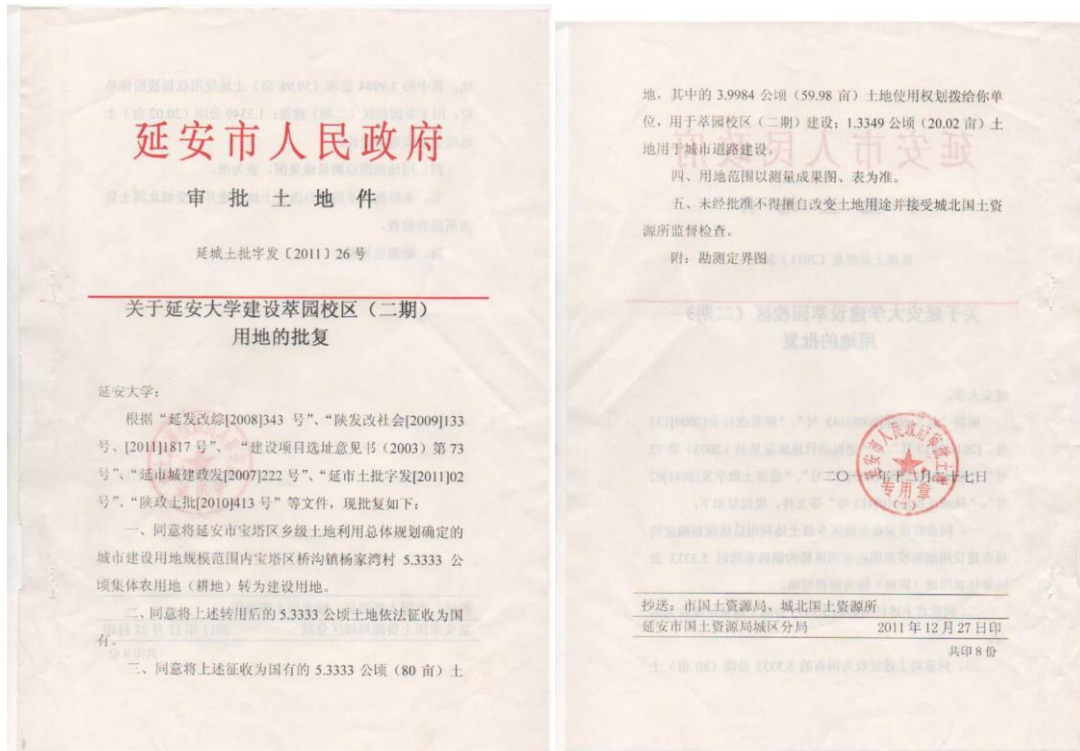

78. Yan'an Municipal People's Government
79. Document on Land Approval
80. Yancheng Tupi Zifa (2011) No. 26
81. Reply on the Construction of Yan'an University Cuiyuan Campus (Phase II)
82. Yan'an University:
83. The approval is as follows according to the relevant documents of the Shaanxi Provincial People's Government and Yan'an Municipal People's Government:
84. It is agreed to convert a total of 5.3333 hectares of land within the scale of urban construction land determined by the overall planning of Yan'an City into construction land.
85. It is agreed to allocate the 3.9984 hectares of the total of 18.3042 hectares land expropriated as state-owned to your organization for the construction of Cuiyuan Campus; 1.3349 hectares for urban road construction.
86. December 27, 2011
87. Urban Branch of Yan'an Land and Resources Bureau

Annex 4 Correspondences Related to Project Land Use of Yan'an University

1. Minutes of the Party Committee Meeting of Yan'an University (deliberation on project land use)

延安大学党委会

会议纪要

二〇二〇年第二十三次

延安大学党委会办公室 2020年11月26日

11月26日，张金锁书记主持召开2020年第23次党委会，审议《关于召开五届一次教职工代表暨工会会员代表大会相关事宜的报告》等4个方面的问题，通报2020年陕西省舆情信息工作会议情况，现纪要如下：

一、审议《关于召开五届一次教职工代表暨工会会员代表大会相关事宜的报告》

会议听取了校工会主席杨曦东关于召开五届一次教职工代表暨工会会员代表大会相关事宜的汇报。

会议原则同意《关于召开五届一次教职工代表暨工会会员代表大会相关事宜的报告》，会议拟定于12月中旬召开。

会议要求：

1. 校工会要积极做好会议筹备各项工作，并按程序履行相关报批手续。

2. 要坚持标准优化结构，严把审核关，扎实做好代表遴选工

作，确保所选代表具有广泛的代表性和较强的议事能力，为会议的高质量召开打下坚实基础。

二、审议《关于免去刘述进等同志党委委员职务的请示》

会议听取了组织部部长吕达关于提请免去刘述进等同志党委委员职务的情况汇报。

根据省委教育工委、省委组织部《关于落实组织部长、宣传部长、统战部长担任党委常委(委员)的通知》(陕教工[2020]202号)精神，及省委教育工委对落实“三长”进常委(委员)执行过程中有关问题答复意见，会议同意：免去刘述进、姚正宽、杜红荣、杨亮才4位同志中共延安大学委员会委员职务。

会议要求，组织部按程序做好后续相关工作。

三、审议《关于确定中共延安大学委员会委员候选人的请示》

会议听取了组织部部长吕达关于中共延安大学委员会委员候选人的有关情况汇报。

会议同意：吕达、解文元、梁艳3位同志为中共延安大学委员会委员候选人。

会议要求，组织部按程序做好后续相关工作。

四、审议《关于调整校纪委委员的请示》

会议听取了组织部部长吕达关于调整校纪委委员有关事宜的情况汇报。

根据干部换届结果及学校工作需要，会议同意：

1. 免去韩卿元、白泽生、马延龙、强伟4位同志中共延安大学纪律检查委员会委员职务。

2. 郭伟、杨曦东、刘小森、葛彬、马小惠5位同志为中共延

安大学纪律检查委员会委员候选人。

会议要求，组织部会同纪委按程序做好后续相关工作。

五、通报2020年陕西省舆情信息工作会议情况

会议由宣传部部长解文元传达了11月12日在西安召开的2020年陕西省舆情信息工作会议情况。

会议强调，舆情信息工作是党的宣传思想文化工作的重要组成部分。高校作为党的宣传思想工作的重要阵地，要牢固树立舆情风险意识，聚焦国际国内高等教育重点舆情，聚焦落实立德树人根本任务，加强舆论引导，着力提升舆情信息服务质量，牢牢掌握舆情信息工作的主动权和主导权。

会议要求，要切实抓好会议精神的贯彻落实，进一步完善制度机制，加强舆情分析研判，夯实工作责任，强化工作举措，为更有特色、更有水平大学建设营造良好舆论环境。

六、审定校长办公会提交的事项

会议研究了校长办公会提交的《关于延安大学附属医院妇女儿童分院项目土地权属的请示》

会议原则同意校长办公会意见。

会议要求，在合法合规完成土地使用权转让后，妇女儿童分院项目整体交由附属医院负责。

会议还研究了杨家岭校区车辆管理和学校住宅区物业管理的问题，会议要求：

1. 保卫处抓紧制定出台杨家岭校区机动车辆管理办法，做好与校园校区车辆管理制度的有效耦合，由杨伟宏副校长负责进行督促、把关。

2. 后勤处尽快制定萃园小区、雅苑小区、怡苑小区的物业费收取方案，并按程序提交会议审议通过后施行。

出席人：张金锁、高子伟、王顺、苏醒仁、武忠远

王刚、杨伟宏、范育琳、刘述进、杜红荣

高峰

请假人：陈华、付峰、姚正宽、杨亮才

列席人：李杨、吕达、解文元、杨曦东

记录人：刘靛

分送：各位校领导，有关单位。

延安大学党委会办公室 2020年12月1日印发

Yan'an University CPC Party Committee
Minutes of Meeting
November 26, 2020

88. The meeting studied the *Request for Instructions on Land Ownership of the Women and Children's Branch Hospital of Yan'an University Affiliated Hospital* submitted by the President's Office

89. The meeting agreed in principle with the opinions of the President's Office.

90. The meeting requests that after the transfer of land use rights is completed legally and compliantly, the overall project of the Women and Children's Branch shall be handed over to the affiliated hospital.

2. Reply letter from Yan'an University on the project site

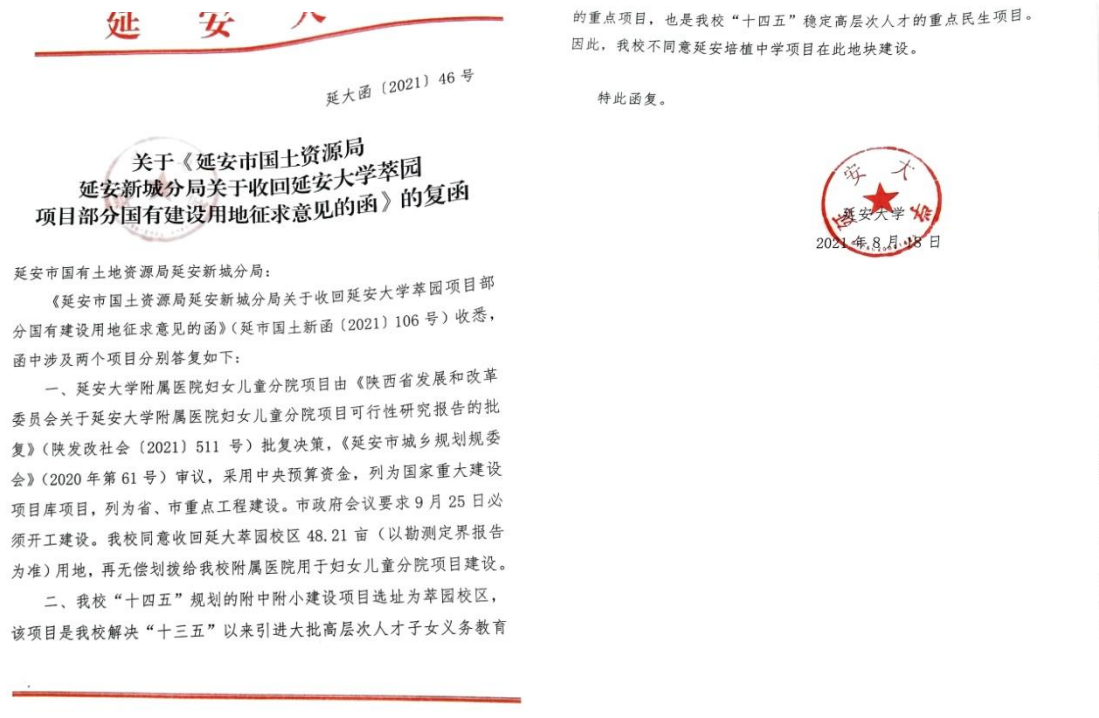

91. Reply letter from Yan'an University on the project site

92. The project of the Women and Children's Branch Hospital of Yan'an University Affiliated Hospital is approved and decided by (Shaan Fagai Shehui [2021] No. 511)

93. The university agrees to take back the 48.21 mu of Yan'an University Cuiyuan Campus, and then allocates to the affiliated hospital of our school for the construction of the Women and Children's Branch Hospital free of charge.

Annex5 Contract for the Medical Waste Centralized Disposal Project of Yan'an University Affiliated Hospital

合同编号：YDFY-HQZB-20210901

延安大学附属医院医疗废物集中处置项目

合 同 书

甲 方：延安大学附属医院

乙 方：延安市盛源医疗废物集中处置有限公司

签订地点：延安大学附属医院招标采购科用章



延安大学附属医院招标采购科制

医疗废物集中处置项目

管理科室：临床服务中心

甲方：延安大学附属医院

乙方：延安市盛源医疗废物集中处置有限公司

根据《中华人民共和国医疗废物管理条例》、《固体污染防治法》、《医疗卫生机构医疗废物管理办法》等法律法规，延安市人民政府《关于进一步加强医疗废物管理工作的通知》（延政办发【2011】36号）文件精神，以及延安市环保局对医疗废物处理有关精神，为了规范和改善全市医疗废物处置管理，切实做好我院医疗废物集中管理处置，达到资源化、无害化、减量化，经延安大学附属医院（以下简称甲方）与延安市盛源医疗废物集中处置有限公司（以下简称乙方）共同协商，就医疗废物无害化处理达成如下协议条款：

第一条 合同金额及付款方式

依据《延安市物价局关于延安市医疗废物处置收费标准的复函》（延市价函【2007】19号）文件精神：

1、住院病人费用每床每日 2.6 元；根据临床服务中心与病案统计室提供数据：我院 2020 年度出院病人占用总床日数为 685100 日，则住院病人总费用为 $685100 \times 2.6 = 1781260$ 元，大写：壹佰柒拾捌万壹仟贰佰陆拾元整。

2、门诊病人费用按实际就医门诊人次每 3 人次折合 1 张床位，每床 2.6 元计费；根据临床服务中心与病案统计室提供数据：2020 年度门诊病人总数 1066144 人次（含院外义诊人次），则门诊病人总费用为 $1066144 \div 3 \times 2.6 = 923991$ 元（保留整数），

大写：玖拾贰万叁仟玖佰玖拾壹元整。

3、延安大学附属医院 2020 年度新型冠状病毒肺炎所产生的医疗垃圾总费用为 60000 元，大写：陆万元整。

三项合计：小写：2765251 元；大写：贰佰柒拾陆万伍仟贰佰伍拾壹元整。

4、付款方式：每季度支付一次，即 691312.75 元，大写：陆拾玖万壹仟叁佰壹拾贰元柒角伍分；甲方在收到乙方提供的正规票据和银行账号后按照正常财务程序予以转账。

第二条 甲、乙双方的职责

（一）甲方职责

- 1、甲方应严格按照医疗废物分类目录将医疗废物进行分类包装、标明医疗废物种类及警示标志后，按类别分区放置于医疗废物暂存场所待交乙方。
- 2、甲方为乙方垃圾收集车辆提供出入方便及暂停场地。
- 3、甲方应有专人负责医疗废物数量汇总、联单登记及转交、检查核对医疗废物。
- 4、甲方应爱护乙方提供的医疗废物周转箱。

甲方须按照协议规定之时限及时付给乙方医疗废物处置费用。

（二）乙方职责

- 1、乙方负责甲方（包括院本部和东关心脑血管病区）所产生的医疗废物，其中包括感染性废物、损伤性废物、（病理性废物、药物性废物和放射性废物除外）等的装卸、转运、无害化处置。
- 2、乙方必须每天到甲方医疗废物暂存场所收取医疗废物，时间为每天下午 5

点，并提前半小时通知甲方；双方交接时须认真填写、核对、交接转移联单，资料
保存三年。

3、运送医疗废物应当使用封闭、防渗漏、防遗撒、无锐利边角、易于装卸和清
洁的专用运送工具。每天运送工作结束后，应当对运送工具及时进行清洁和消毒。

4、乙方必须至少每季度末向甲方通报本季度医疗废物无害化运输和处置总体情
况一次，并核对转移联单及处理总量。

5、转运、处置医疗废物所需设备、运送车辆、周转箱、工具、用物、人员、职
业防护等由乙方提供，由此出现的一切问题由乙方负责。

第三条 违约责任

1、甲方应按照规定分类收集医疗废物，不得将生活垃圾、建筑垃圾或其它非医疗
废物装入医疗废物周转箱内，由此引起的责任由甲方承担。

2、若乙方未按国家相关规定及甲方要求对医疗废物进行处理，由此出现的任何问
题由乙方负责。

3、对甲方移交的所有医疗废弃物，乙方只能作无害化彻底处置，不得进行任何
其它方式、其它途径处理，否则造成的一切后果由乙方负责。

4、若乙方不能按时、彻底收取甲方医疗废物，不能认真履行交接签字手续，甲方
有权扣除一定的经费，由此造成的一切后果由乙方负责。

5、若甲方不能按照约定时间及时足额履行付款承诺，由此造成的不良后果由甲
方负责。

6、本协议在履行过程中如发生争议，应由双方协商解决。



7、在本协议期满前一个月，由甲、乙双方协商是否续签下一年度承包协议。

8、2021年费用依据2020年年报统计数据计算，后续两年年结算数据均以上一年年报为准，以此类推。

第四条 合同期限

本项目的服务时间为2020年9月1日起至2023年8月31日止，服务期限为叁年，合同每年一签。

本合同有效时间为2021年9月1日至2022年8月31日。

第五条 其它约定事项

本合同一式伍份，甲方肆份，乙方壹份，双方法定代表签字并盖公章方可生效，均具有同等法律效力。未尽事宜，双方应本着友好合作精神协商解决。

| | |
|--|---|
| 甲方：延安大学附属医院 单位名称(章) 单位地址：延安市宝塔区北关街43号 主管院领导： 法定代表人： 电 话：09112881002 签订日期：2021年9月1日 | 乙方：延安市盛源医疗废物集中处置有限公司 单位名称(章) 单位地址：延安市宝塔区河庄坪镇小沟村桃树山隧道右侧 法人及委托代理人： 电 话：13892139188 开户银行：农行延安枣园路支行 账 号：26905601040003064 签订日期：2021年9月1日 |
|--|---|

Medical Waste Centralized Disposal Project

94. Party A: Yan'an University Affiliated Hospital
95. Party B: Yan'an Shengyuan Medical Waste Centralized Disposal Co., Ltd.
96. Party B's responsibilities:
 1. Party B is responsible for the medical waste generated by Party A (including the hospital headquarters and the Dongguan Cerebrovascular Ward), including the loading, unloading, transshipment, and harmless disposal of infectious waste, hazardous wastes (except pathological waste, pharmaceutical waste and radioactive waste), etc.
 2. Party B shall collect medical waste at the temporary storage site of Party A's medical waste every day at 5:00 pm, and notify Party A half an hour in advance: both parties shall fill in, check, and hand over the Transfer Form carefully when handing over, and the data shall be kept for three years.
 3. Party B shall transport the medical waste in receptacles which are closed, leak-proof, spill-proof, without sharp edges and corners, easy to handle and clean up. After the daily delivery work, the delivery tools should be cleaned and disinfected in time.
 4. Party B shall notify Party A of the general situation of harmless transportation and disposal of medical waste in this quarter at least once at the end of each quarter, and check the Transfer Form and the total amount of treatment.
 5. The equipment, transportation vehicles, turnover boxes, tools, supplies, personnel, and occupational protection required for the transfer and disposal of medical waste shall be provided by Party B, and Party B shall be responsible for all problems arising therefrom.
97. The service period of this project is three years in total from September 1, 2020 to August 31, 2023, with the contract renewed once a year.
98. This contract is valid from September 1, 2021 to August 31, 2022.